

3M Science.
Applied to Life.™

Get more confidence
in every step.

1 Retract

3M™ Astringent Retraction Paste



2 Syringe

3M™ Intra-oral Syringe



3 Impress

3M™ Imprint™ 4
VPS Impression Material



Because a great-fitting restoration should never be a surprise.



RETRACT



SYRINGE
AND MIX



IMPRESS

www.3M.com



3M Oral Care
2510 Conway Avenue
St. Paul, MN 55144-1000 USA
Phone 1-800-634-2249
Web 3M.com/dental

3M Deutschland GmbH
Location Seefeld
3M ESPE • ESPE Platz
82229 Seefeld • Germany
Info3MESPE@mmm.com
www.3MESPE.com

Make better impressions

3M gives you exactly what you need to simplify the process and achieve consistent clinical results.

How you get there: With products that set fast yet give you enough working time. Ingenious tools that streamline the procedure. And troubleshooting tips to help you ace every impression, so restorations fit.



Download 3M's tips at
www.3M.com

3M and Imprint are trademarks of 3M or 3M Deutschland GmbH. Used under license in Canada. © 3M 2016. All rights reserved.

3M Science.
Applied to Life.™



Retract tissue gently.

3M™ Astrigent Retraction Paste

A great impression starts with controlling tissue and moisture. Our capsule's extra-fine tip delivers hemostatic paste where it belongs—right into the sulcus—to gently retract tissue and control bleeding.



Delivers a 15% aluminum chloride astringent paste into the sulcus for gentle retraction of gingival tissue.



Steps for using 3M™ Astringent Retraction Paste

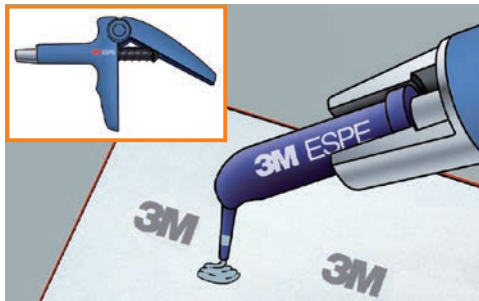

Place capsule firmly in dispenser. Remove cap immediately before use and discard. Dispense small quantity of paste onto a mixing pad and discard. NOTE: Rounded capsule tip must not be shortened because this would result in sharp edges.

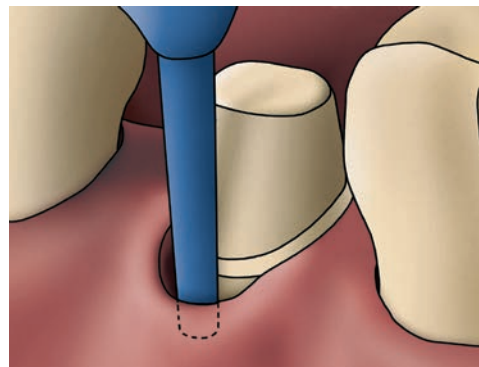

Rinse sulcus thoroughly with water and dry lightly with air before applying the paste. Insert capsule tip into the sulcus.

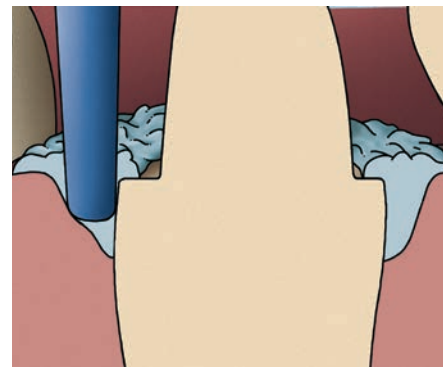

Slowly and steadily inject astringent retraction paste into sulcus. Completely fill the sulcus.

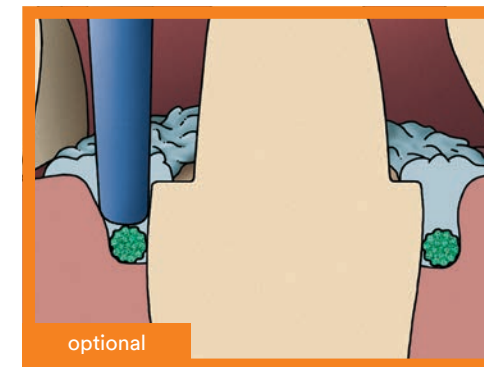

If required by the clinical situation, the retraction paste can be used in combination with a cord to open the sulcus further.

The retraction paste can be used with or without cord.

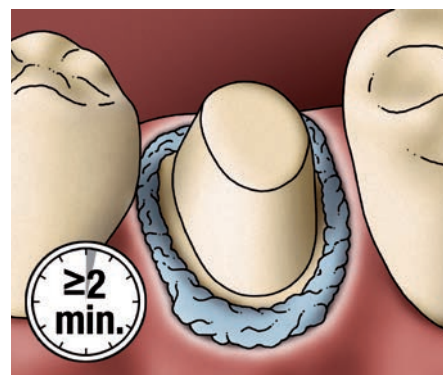

Allow the astringent retraction paste to react for at least 2 minutes in the sulcus. Keep all moisture away from the site during this period. NOTE: An overly long residence time may cause damage to tissue.



Remove the retraction paste completely from the sulcus and surrounding areas with air, water and suction. NOTE: The patient must not swallow the retraction paste.

3M

3M Oral Care
2510 Conway Avenue
St. Paul, MN 55144-1000 USA
Phone 1-800-634-2249
Web 3M.com/dental

3M Deutschland GmbH
Location Seefeld
3M ESPE • ESPE Platz
82229 Seefeld • Germany
Info3MESPE@mmm.com
www.3MESPE.com

www.3M.com

3M is a trademark of 3M or 3M Deutschland GmbH. Used under license in Canada. © 3M 2016. All rights reserved.

3M Science.
Applied to Life.™



Capture precise detail.

3M™ Intra-oral Syringe

Restorations with accurate margins drop into place. This syringe helps you apply wash material exactly where it's needed to capture every marginal detail. Patient-friendly and ergonomic, these little syringes make dispensing more efficient, with up to 67% less waste than hand dispensers.



Prefill up to
- 12 hrs. -
in advance



Steps for using the 3M™ Intra-oral Syringe

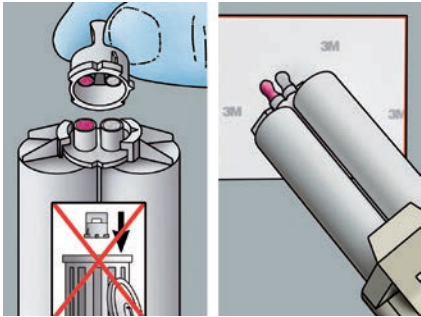

Remove the cartridge cap. Bleed a small amount of material from the cartridge onto mixing pad and discard.

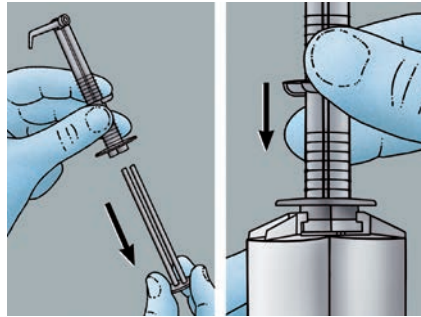

Remove the plunger of the intra-oral syringe. Place on the openings of Garant™ cartridge and attach.

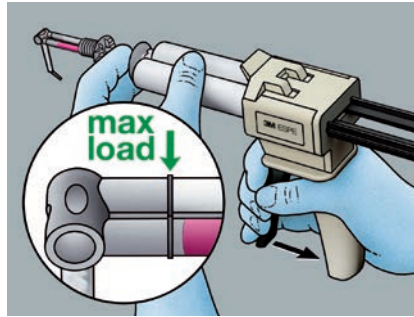

Hold firmly in place while filling. Leave mixing tip in angled position; do not fold open. Do not fill syringe past the maximum fill line.

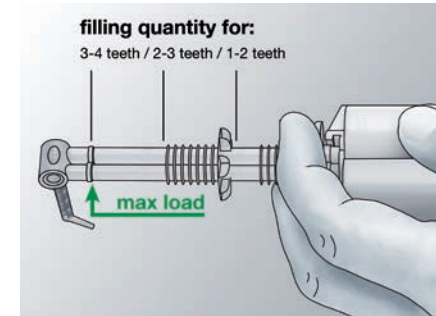

The content of an intra-oral syringe is sufficient for syringing about 2–4 preparations, depending on the quantity applied around each unit.

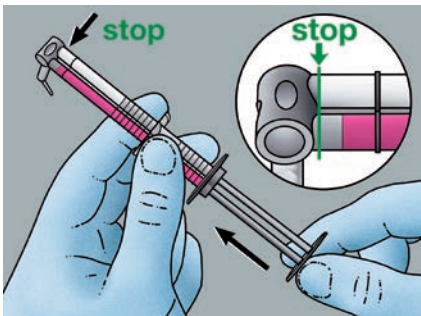

Replace plunger in the syringe, pushing paste no further than to the joint of the mixing tip.

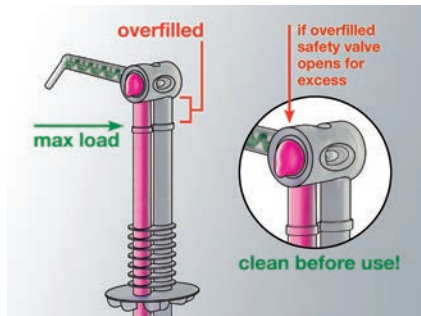

Any paste extruded on the sides of the mixing tip joint must be wiped off before the application in the mouth.

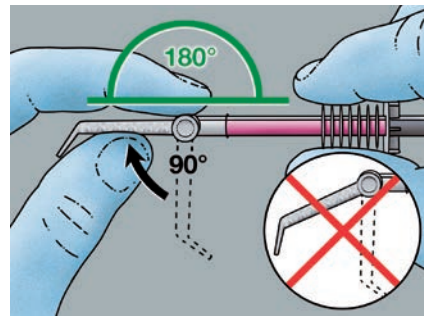

Immediately before application, fold out the mixing tip of the syringe at a 180° angle (until resistance is felt) to align with syringe. Do not bend the tip back down afterwards.

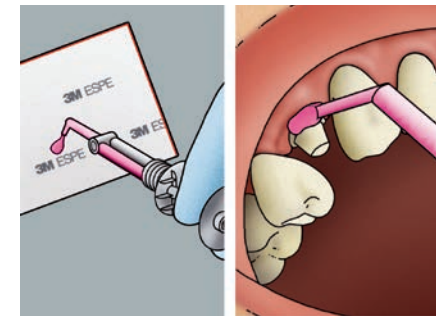

Press out a small quantity of paste onto a mixing pad until the base paste and catalyst flow out in an even, homogeneous mixture. Immediately syringe material around prepared tooth.

3M

www.3M.com

3M Oral Care
2510 Conway Avenue
St. Paul, MN 55144-1000 USA
Phone 1-800-634-2249
Web 3M.com/dental

3M Deutschland GmbH
Location Seefeld
3M ESPE • ESPE Platz
82229 Seefeld • Germany
Info3MESPE@mmm.com
www.3MESPE.com

NOTE: Intra-oral syringes cannot be autoclaved and must only be used on one patient! Refilling a syringe is prohibited.

3M and Garant are trademarks of 3M or 3M Deutschland GmbH. Used under license in Canada. © 3M 2016. All rights reserved.

3M Science.
Applied to Life.™

Stress less over everyday impressions.







3M™ Imprint™ 4 VPS Impression Material

Say “YES” to the VPS impression material with the shortest intra-oral setting time. Move through your day with speed, control and precision. Deliver accurate impressions the first time with the fastest VPS material on the market.











It's simply a better way
to make better impressions.



Tray Materials

PRODUCT	DISPENSING SYSTEM	VISCOSITY LOW  HIGH	SETTING VERSION	MAXIMUM WORKING TIME (23°C/73°F) 	MAXIMUM INTRA-ORAL SYRINGING TIME (37°C/98°F) 	INTRA-ORAL SETTING TIME (37°C/98°F) 
3M™ Imprint™ 4 Penta™ Putty		Putty	Regular Set	1:30	–	2:30
3M™ Imprint™ 4 Penta™ Heavy		Heavy Body	Regular Set	2:00	–	2:00
3M™ Imprint™ 4 Penta™ Super Quick Heavy		Heavy Body	Fast Set	1:15	–	1:15

Wash Materials

3M™ Imprint™ 4 Super Quick Ultra-Light			Fast Set	–	0:35	1:15
3M™ Imprint™ 4 Light			Regular Set	–	1:00	2:00
3M™ Imprint™ 4 Super Quick Light			Fast Set	–	0:35	1:15
3M™ Imprint™ 4 Regular			Regular Set	–	1:00	2:00
3M™ Imprint™ 4 Super Quick Regular			Fast Set	–	0:35	1:15

www.3M.com



3M Oral Care
2510 Conway Avenue
St. Paul, MN 55144-1000 USA
Phone 1-800-634-2249
Web 3M.com/dental

3M Deutschland GmbH
Location Seefeld
3M ESPE • ESPE Platz
82229 Seefeld • Germany
Info3MESPE@mmm.com
www.3MESPE.com

3M, Imprint and Penta are trademarks of 3M or 3M Deutschland GmbH. Used under license in Canada. © 3M 2016. All rights reserved.



3M™ Imprint™ 4 Penta™ VPS Impression Material—Impression Techniques

Steps for using 3M™ Imprint™ 4 Penta™ VPS Impression Material in a One-Step Impression Technique

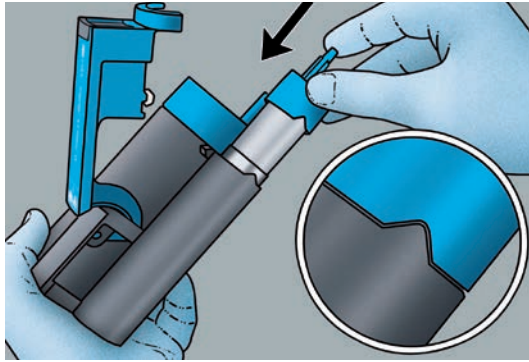

Place the 3M™ Penta™ foil bags into the designated 3M™ Penta™ cartridge.

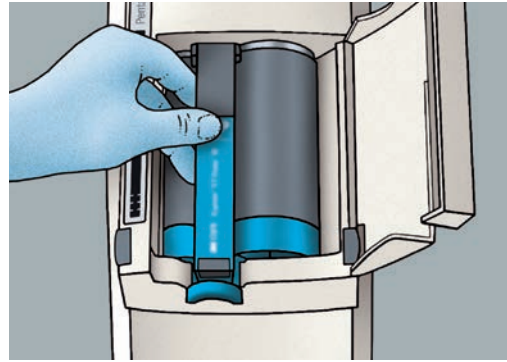

Insert the loaded cartridge into the 3M™ Pentamix™ Automatic Mixing Unit.

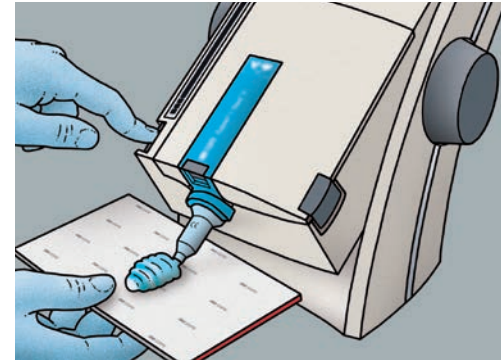

When using new foil bags, start mixing and extrude a small amount until paste is homogeneous in color. Discard.

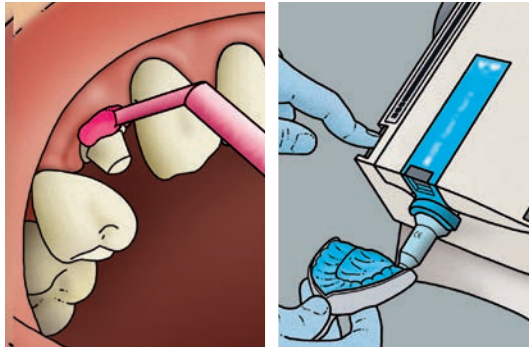

While the tray is being loaded with heavy-body or putty impression material, apply wash material around the preparation using a wiggle and stir motion.

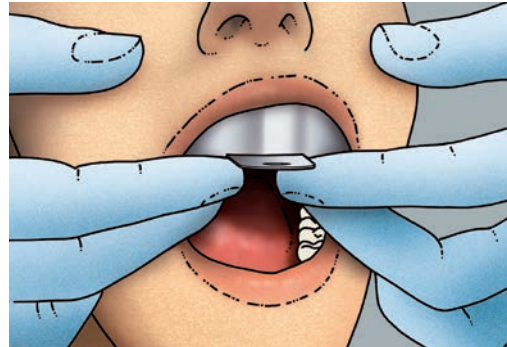

Insert the loaded tray straight and evenly into mouth—avoid rotation. Don't let patient bite down on tray. Immobilize the tray using passive pressure. Follow recommended setting time in the mouth using a timer.

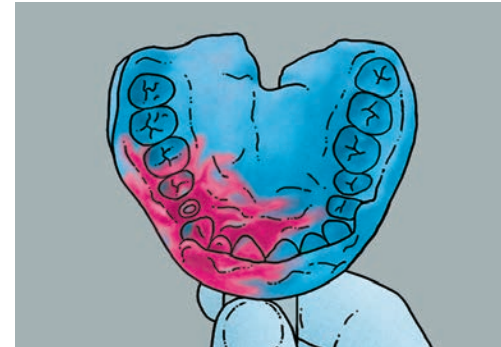

When material is completely set, carefully remove tray from mouth and evaluate the final impression.



3M™ Imprint™ 4 Penta™ VPS Impression Material—Impression Techniques

Steps for using 3M™ Imprint™ 4 Penta™ VPS Impression Material in a Two-Step Impression Technique

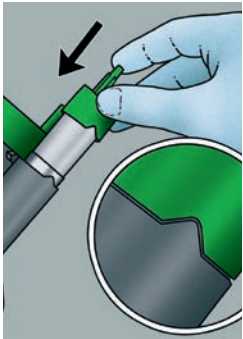

Place the 3M™ Penta™ foil bags into the designated 3M™ Penta™ cartridge. Insert the loaded cartridge into the 3M™ Pentamix™ 3 Automatic Mixing Unit.

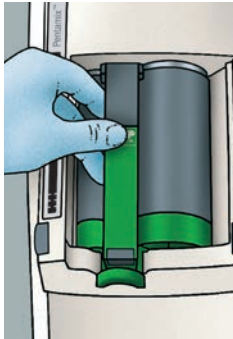

When using new foil bags, start mixing and extrude a small amount until paste is homogeneous in color. Discard.

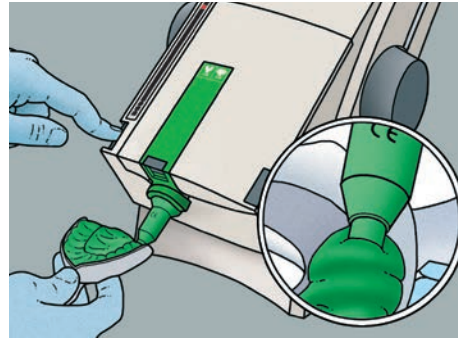

Load the tray with heavy-body or putty impression material.

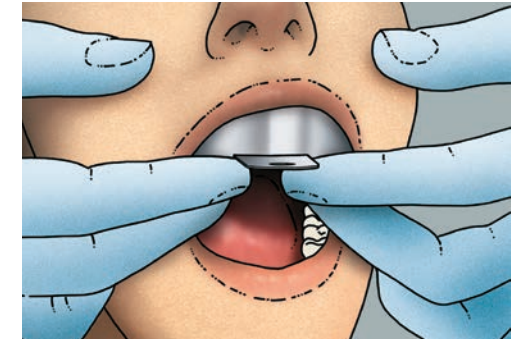

Insert the loaded tray straight and evenly into mouth—avoid rotation. Don't let patient bite down on tray. Immobilize the tray using passive pressure. Follow recommended setting time in the mouth using a timer.

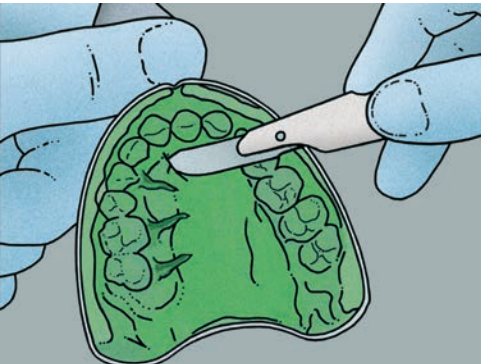

Carve channels into the impression to allow for the overflow of wash material

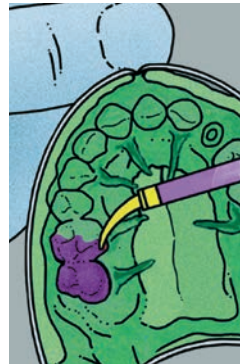

Syringe wash material around the preparation and into the preliminary impression.

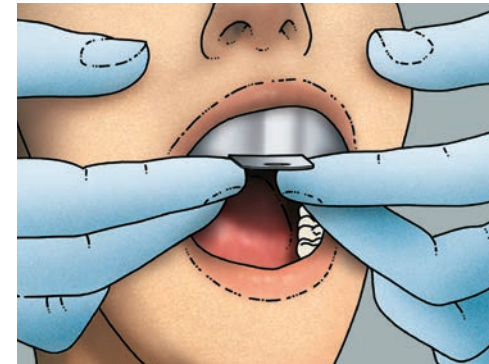

Reseat the impression. Follow recommended setting time in the mouth using a timer.

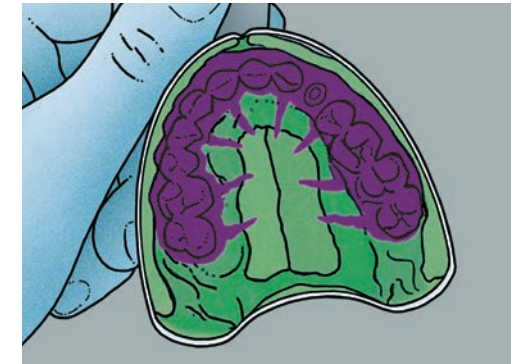

When material is completely set, carefully remove tray from mouth and evaluate the final impression.



www.3M.com

3M Oral Care
2510 Conway Avenue
St. Paul, MN 55144-1000 USA
Phone 1-800-634-2249
Web 3M.com/dental

3M Deutschland GmbH
Location Seefeld
3M ESPE • ESPE Platz
82229 Seefeld • Germany
Info3MESPE@mmm.com
www.3MESPE.com

3M, Imprint, Penta and Pentamix are trademarks of 3M or 3M Deutschland GmbH. Used under license in Canada. © 3M 2016. All rights reserved.
70-2013-0815-5

