

MSA Gas Monitor Remote Display



Convenient remote display mimics Chillgard® or Chemgard® Monitor readings for gas concentration, alarm status, calibration, and fault diagnostics. Economical means of chiller room and production area pre-entry gas level verification in locations remote to system controller. ASHRAE 15-compliant for entryway signaling.

The Gas Monitor Remote Display provides gas monitor information before room entry where potentially hazardous gas levels may exist. This unit is easily installed adjacent to entry ways or walls outside of the monitored area. Workers can easily be alerted by the audible alarm and read the monitor status to know the alarm conditions inside the room prior to entry. When used with MSA's reliable photoacoustic infrared gas detection products, the Gas Monitor Remote Display provides superior levels of hazardous gas detection and communication.

- Used with Chillgard LC, LE, and RT Monitors, and Chemgard Monitor
- Connect up to eight remote displays in series
- Water- and corrosion-resistant enclosure
- Easy to read: 20-position LCD display
- 4 internal relays: FAULT and 3 ALARM levels
- 85 db piezo horn
- 24V or 110/220V input power models
- Beacon and light tower accessories optional



Gas Monitor Remote Display located outside of mechanical room provides entry way signaling.

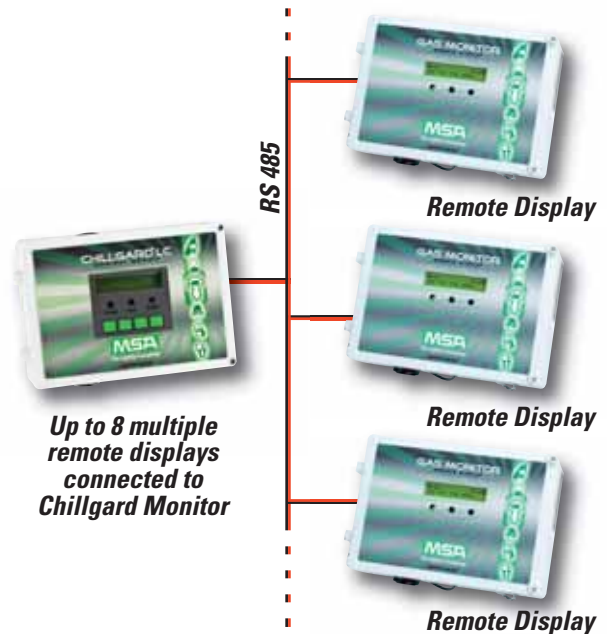

Specifications

Input power	24 VAC/DC or 110/220 VAC, 50/60 Hz
Operating temperatures	0 to 40° C (32 to 104° F)
Non-operating temperatures	-40 to 60° C (-40 to 140° F)
Relative humidity	0 to 99%
Relays	4 form C SPDT, 8 amps at 240 VAC
Physical characteristics	7.1" high x 10" wide x 4.25" deep
Weight	3.5 lbs.
Warranty	2 years
Communication with Chillgard and Chemgard Monitors	2-wire RS-485

Ordering Information

24V AC/DC input power model	10098217
110/220V VAC input power model	10098216

Accessories

Unit-mounted strobe	634674
Remote light towers	Call 1-800-MSA-INST

Note: This bulletin contains only a general description of the products shown. While uses and performance capabilities are described, under no circumstances shall the products be used by untrained or unqualified individuals and not until the product instructions including any warnings or cautions provided have been thoroughly read and understood. Only they contain the complete and detailed information concerning proper use and care of these products.



ID 07-0512-MC / Mar 2009
© MSA 2009 Printed in U.S.A.

Corporate Headquarters
P.O. Box 426, Pittsburgh, PA 15230 USA
Phone 412-967-3000
www.MSAnet.com

U.S. Customer Service Center
Phone 1-800-MSA-INST
Fax 1-724-776-3280

MSA Canada
Phone 1-800-967-INST
Fax 1-724-776-3280

MSA Mexico
Phone (52) 55 2122 5770
Fax (52) 55 5359 4330

MSA International
Phone 412-967-3354
FAX 412-967-3451

Offices and representatives worldwide
For further information:

MSA
The Safety Company