

Model MON-C-DBL-SVR Clamp Mount Dual Monitor Arm

Parts Listing

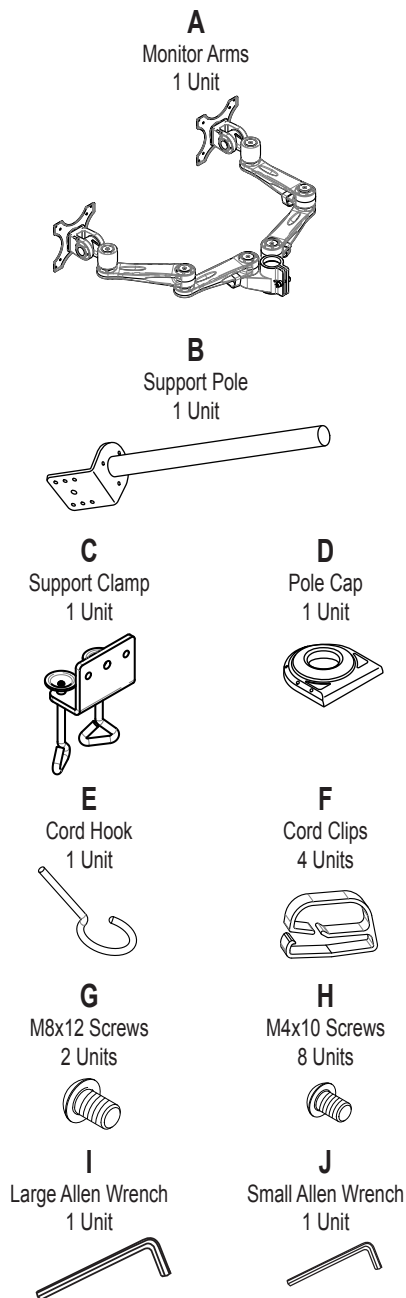

Assembly Instructions



Tools Needed: Large and Small Allen Wrench (provided). Phillips Head Screwdriver.
Please read all instructions before assembly. Complete assembly may require two people.

- Step 1:** Attach Support Pole (B) to Support Clamp (C) by inserting M8x12 Screws (G) through outside holes and into the Support Pole (B). Once screws are tightened, slide the Support Clamp (C) and Support Pole (B) onto the edge of the table top and secure by turning Toggle Screws until securely tightened to the bottom of the desktop. Cover Support Pole (B) with Pole Cap (D). This step may require two people.
- Step 2:** Place your computer monitors face down on a clean surface. Attach Monitor Arms (A) to monitors using M4x10 Screws (H).
- Step 3:** Using two people to hold monitors, slide the Monitor Arms (A) onto the Support Pole (B) and secure by tightening the tension bolt using the Large Allen Wrench (I) at your desired height, as shown.
- Step 4:** Insert the Cord Hook (E) into the bottom of the Monitor Arms (A) close to the pole. Attach Cord Clips (F), 2 per arm, by sliding them through the openings in the sides of the Monitor Arms (A).
- Step 5:** Configure your monitors to your preference, then secure in place by tightening the joints on the Monitor Arms (A) using the Small Allen Wrench (J). Please note you will need to loosen joints to reconfigure the monitors.

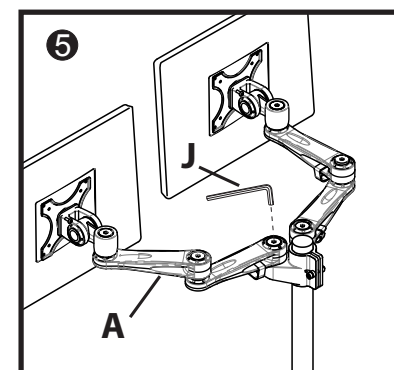
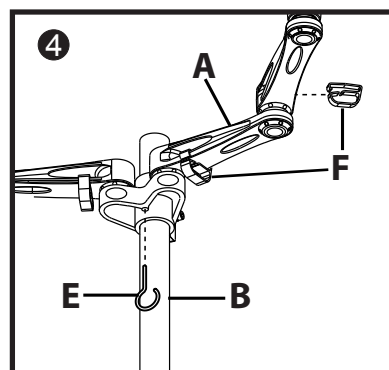
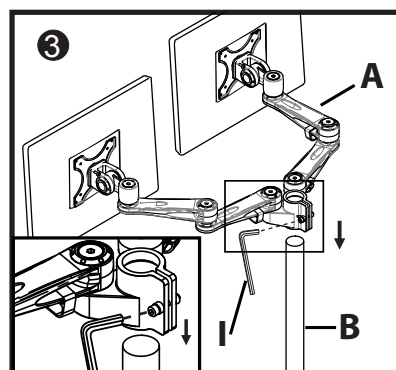
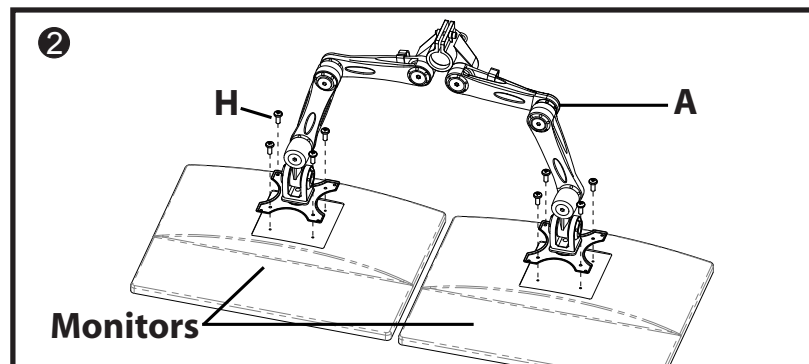
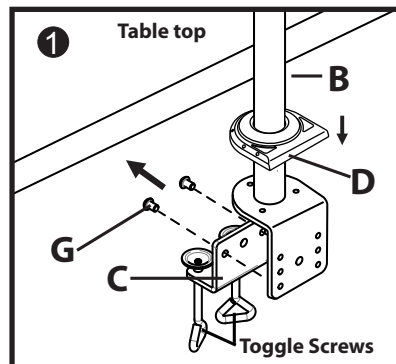

CAUTION:

1. Check for loose screws and tighten them every 6 months.

11.11.2013

ofm
Furniture For The Real Office™

161 Tradition Trail, Holly Springs, NC, 27540
800-520-7471 (voice) 919-362-4765 (fax)
919-303-6389 (voice) www.ofminc.com
support@ofminc.com