

# Model MON-B-DBL-SVR Bolt Mount Dual Monitor Arm

## Parts Listing

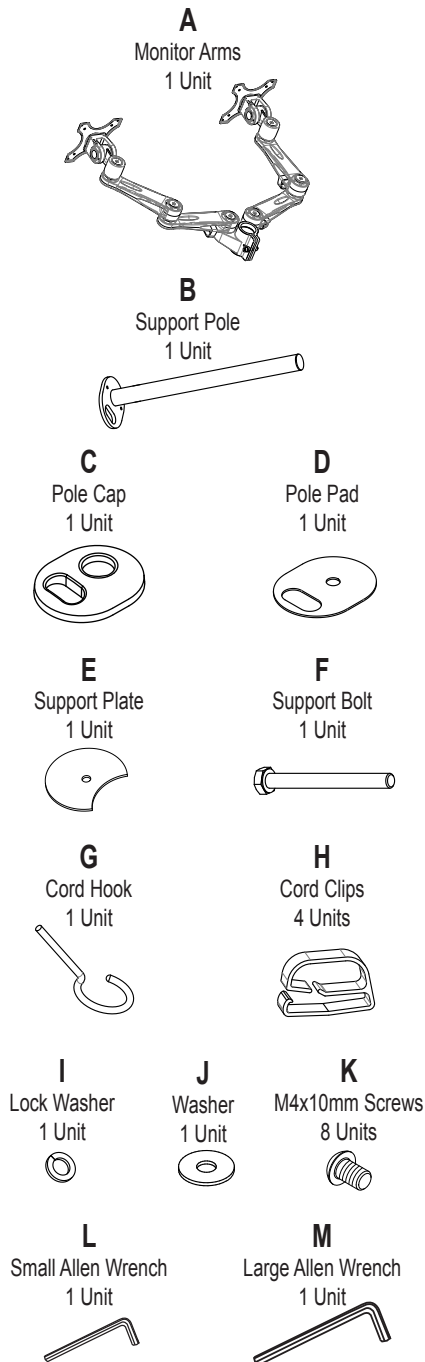

## Assembly Instructions



**Tools Needed:** Large and Small Allen Wrench (provided). Phillips Head Screwdriver.

**Please read all instructions before assembly. Complete assembly may require two people.**

- Step 1:** Attach Support Pole (B) to desktop or table top as follows. Arrange hardware by placing the Lock Washer (I) onto the Support Bolt (F), followed by the Washer (J) and finally the Support Plate (E) as shown. Insert Support Bolt (F) from the bottom of the desktop up through grommet hole. Place Pole Pad (D) down over the protruding Support Bolt (F). Attach the Support Pole (B) by lowering it down onto the Pole Pad (D), while screwing Support Bolt (F) into Support Pole (B), as shown. Arrange position of Support Pole (B) and tighten Support Bolt (F) to secure Support Pole (B) to desktop. Finally, cover Support Pole (B) with Pole Cap (C).
- Step 2:** Place your computer monitors face down on a clean surface. Attach Monitor Arms (A) to monitors using M4x10 Screws (K).
- Step 3:** Using two people to hold monitors, slide the Monitor Arms (A) onto the Support Pole (B) and secure by tightening the tension bolt using the Large Allen Wrench (M) at your desired height, as shown.
- Step 4:** Insert the Cord Hook (G) into the bottom of the Monitor Arms (A) close to the pole. Attach Cord Clips (H), 2 per arm, by sliding them through the openings in the sides of the Monitor Arms (A).
- Step 5:** Configure your monitors to your preference, then secure in place by tightening the joints on the Monitor Arms (A) using the Small Allen Wrench (L). Please note you will need to loosen joints to reconfigure the monitors.

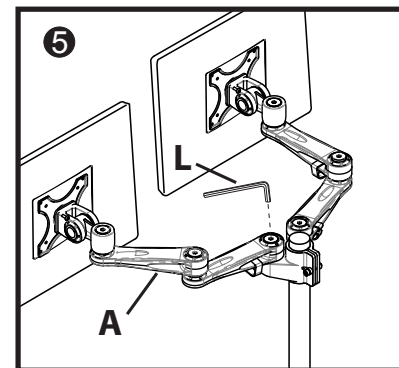
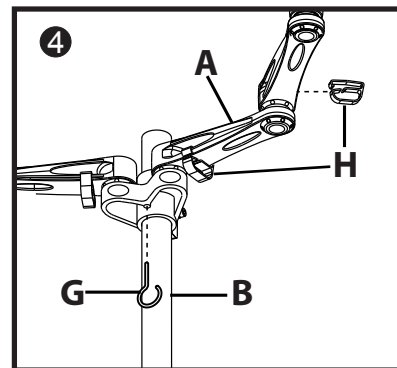
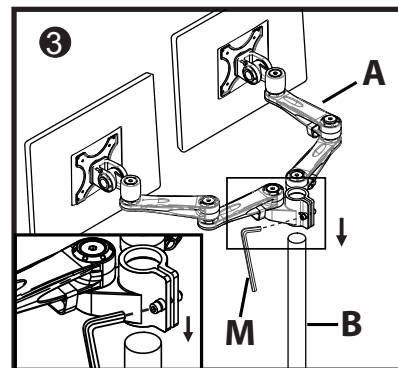
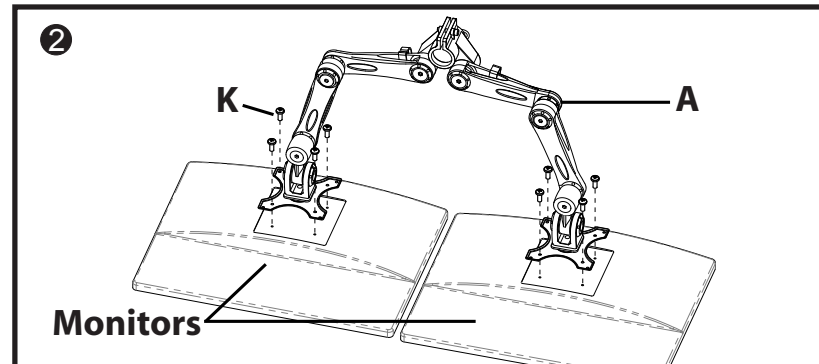
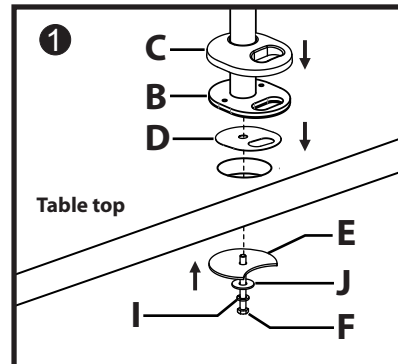

### CAUTION:

1. Check for loose screws and tighten them every 6 months.

11.13.2013

**ofm**  
Furniture For The Real Office™

161 Tradition Trail, Holly Springs, NC, 27540  
800-520-7471 (voice) 919-362-4765 (fax)  
919-303-6389 (voice) www.ofminc.com  
support@ofminc.com