

ULTRA BIG AND TALL CHAIR ASSEMBLY INSTRUCTIONS

Congratulations on the purchase of your new *Signature Series* chair!

PARTS

PART	DESCRIPTION	QTY
1	Casters	5
2	5-Star Base	1
3	Telescoping Cover	1
4	Cylinder	1
5	Seat Plate	1
6A	Left Arm	1
6B	Right Arm	1
7	Seat Cushion	1
8	Back Cushion	1
9	Back Support Plate (Already attached to the back cushion)	1
10	Plastic Shroud	1
11	7/8" Screws	2
12	2½" Screws	2
13	1¼" Screws	4
14	1½" Screws with Spring Washers	4
15A	Left Arm Insert	1
15B	Right Arm Insert	1
16A	Left Arm Insert	1
16B	Right Arm Insert	1
17	Hexagonal Wrench	1

CUSTOMER SERVICE HOTLINE
800-626-6060

ATTENTION:
Make certain to fully tighten all screws
before using chair.

**WE SUGGEST TAPING THE WRENCH UNDER
THE SEAT FOR FUTURE USE.**

INSTRUCTIONS

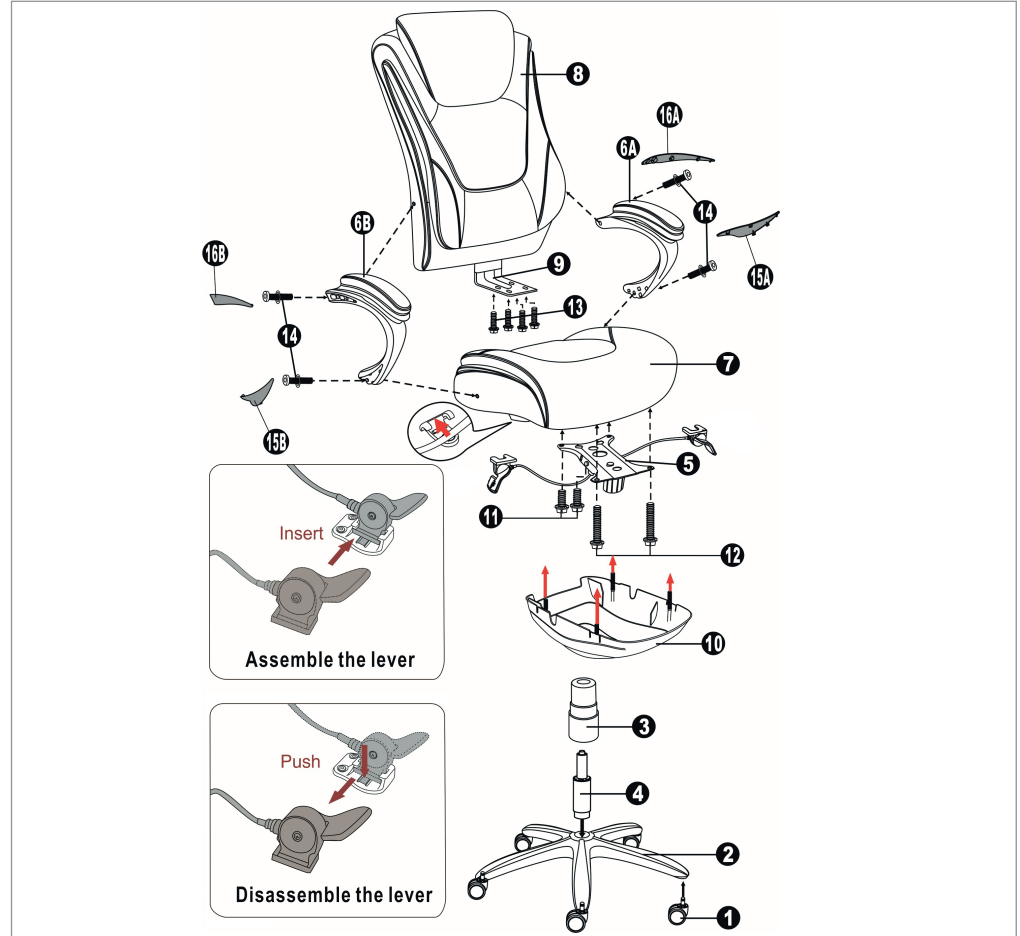

INSTRUCTIONS

- Remove all parts from the carton and separate them into part number groups as indicated in the parts list.
- To begin assembly, place the 5-star base (2) upside down and insert casters (1) into the bottom of base (2).
- Turn the base (2) right side up on the floor and insert the cylinder (4) into the center hole on the base (2).
- Place the telescoping cover (3) over the cylinder (4) and rest it on the base (2).
- Attach the seat plate (5) to the bottom of the seat cushion (7) (with front of seat plate facing the front of the seat cushion) by using 2½" screws (12) into the front holes of the seat plate (5) and 7/8" screws (11) into the rear holes of the seat plate (5) and **tighten the screws**.
- Insert levers of seat plate (5) to the pre-attached cable lever receivers on the underside of seat cushion (7) (with the front of the levers facing the front of seat cushion) as shown in Assemble Diagram. Push down the key on the receivers to pull out the levers as shown in Disassemble Diagram. **Fix the cable for the seat plate into the plastic clips attached to the bottom of the seat cushion.**
- Align the back cushion (8) with the seat cushion (7) and attach the back support plate (9) onto the bottom of the seat cushion (7) by using 1¼" screws (13). **Do not tighten the screws completely.**
- Insert 1½" screws with spring washers (14) into arm holes, attaching arms (6A & 6B) (with the front of the arms facing the front of seat cushion) to sides of seat cushion (7) and back cushion (8). **Tighten all the screws. Remember to tighten the screws on the back support plate.**
- Put the plastic shroud (10) over the seat plate (5) (with front of plastic shroud facing the front of seat cushion). Align shroud posts to holes on bottom of seat cushion (7) and press into position.
- Place the assembled chair on top of the cylinder (4) and press down until fully engaged.
- Place the arm inserts (15A & 15B & 16A & 16B) into arm grooves once all screws have been tightened.
- Periodically (every 90 days) make sure that the screws are still fully tightened.

WWW.NBF.COM
800-558-1010

ULTRA BIG AND TALL CHAIR ASSEMBLY INSTRUCTIONS

OPERATING FEATURES

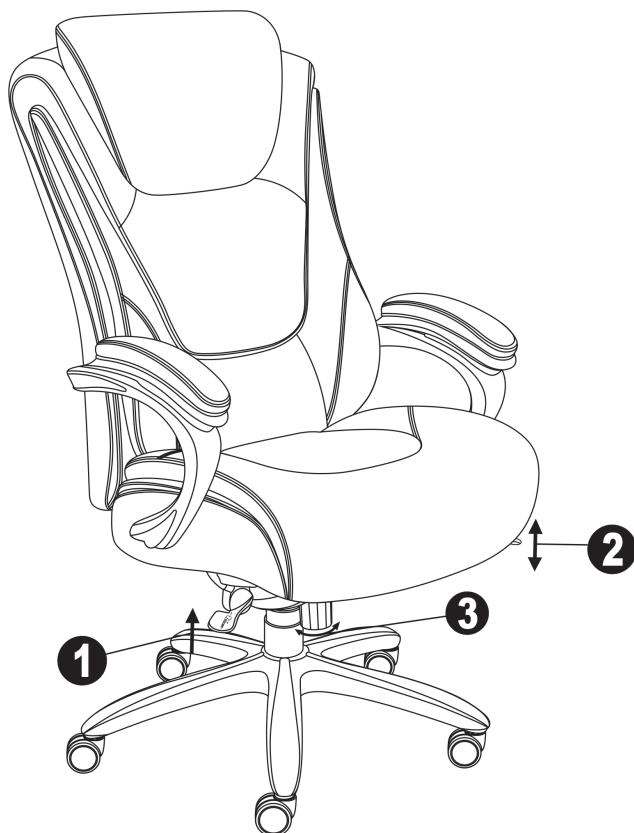

1. TO ADJUST SEAT HEIGHT:

While seated, lean forward and reach under the right side of the chair to locate the handle. Lift the handle and raise your body up slightly to allow the chair to rise to the desired height. To lower the seat, lift the handle while applying more weight downward on the seat. The chair will descend until the handle is released or the chair reaches the lowest position.

2. TO OPERATE TILT LOCKOUT:

While seated, reach under the left side of the chair to find the handle. Push down the handle and lean back to allow the chair to tilt backwards. To lock the chair in the upright or vertical position, sit upright and pull the handle to the level position.

3. TO ADJUST TENSION ON THE TILT:

Reach under the front center of the chair, grasp the round knob and turn counterclockwise to make the tilt mechanism firmer (stiffer). To make the tilt mechanism less firm, turn the knob clockwise until the desired resistance is found.

WARNINGS

1. This product should be used by only one person at a time.
2. Do not use this chair unless all bolts, screws and knobs are securely tightened.
3. **Save the hexagonal wrench.** Check that all bolts, screws and knobs are tight every three months or as needed.
4. Dispose of packing material properly. Do not use the plastic cover as a head covering. It may cause suffocation.
5. Do not use the chair as a stepladder.
6. Use this chair for its intended purpose only.
7. The casters sold with this chair are intended for use on carpet. They are not recommended for use on tile or hard-wood floors. Using these casters on tile or wood flooring may cause damage to the floor surface. Please consider using a chair mat to protect your floor surfaces.