

**Congratulations on the purchase of your new *Signature Series* chair!**

**PARTS** – remove all the parts from the carton and verify part quantities as indicated on this parts list.

①



**CASTOR – QTY: 5**

②



**5-STAR BASE – QTY: 1**

③



**GAS LIFT – QTY: 1**

④

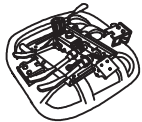

**SEAT CUSHION WITH MECHANISM – QTY: 1**

⑤



**BACK – QTY: 1**

⑥



**ARMS – QTY: 2**

⑦



**5/16" x 3/4" SCREW – QTY: 3**

⑧



**Ø20xØ8.5x2MMT WASHER – QTY: 3**

⑨



**ALLEN KEY – QTY: 1**

**STEP 1**

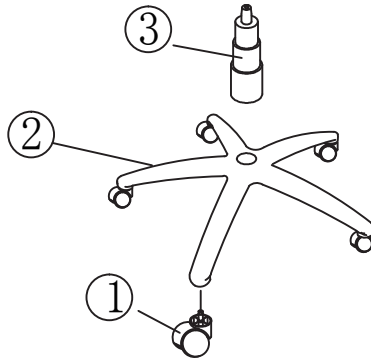

**STEP 2**

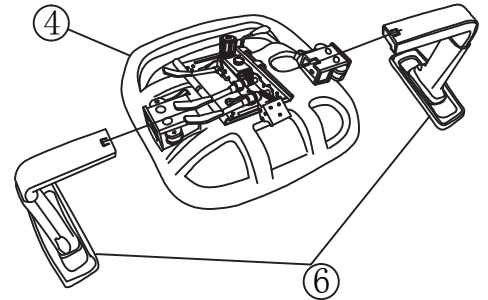

**STEP 3**

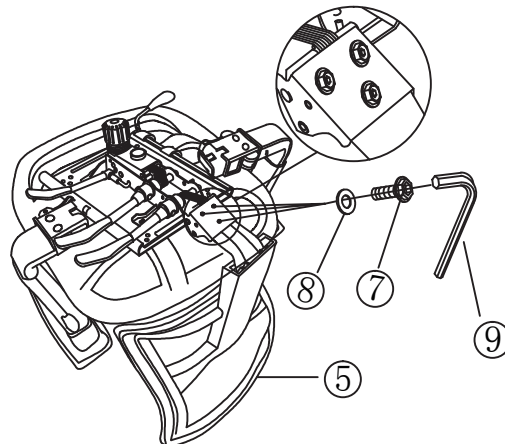

**STEP 4**

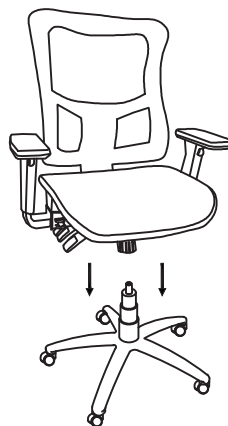

**STEP 5**



**IMPORTANT:** This chair is to be used by one person at a time. Be sure all screws are securely tightened. Save the wrench and periodically tighten the screws. Do not lean the chair back on 2 wheels or use the chair as a stepladder. Use this chair for its intended purpose only.

CUSTOMER SERVICE HOTLINE  
800-626-6060