

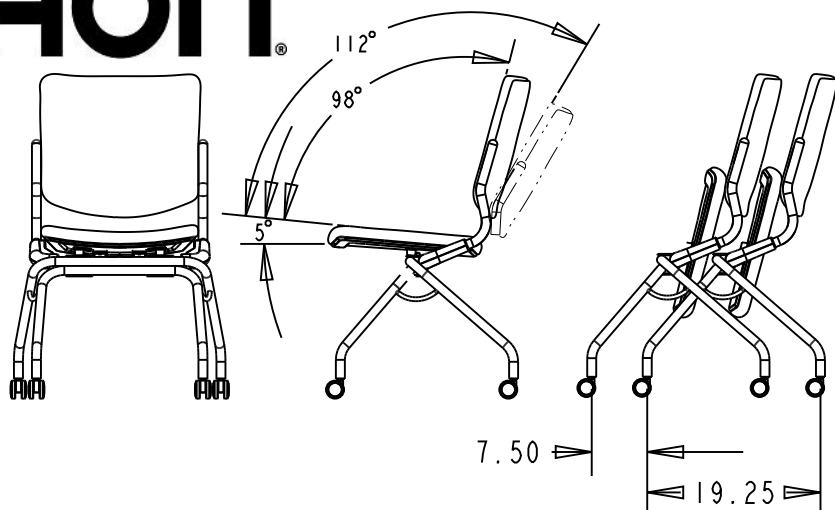

HPN1XU Nesting Chairs HPN1FCXU Technical Specifications

Armless, Flex-back,
Nesting Chair, Four Legs,



KEY DIMENSIONS

Max. Width..... 26"
Max. Depth..... 26"
Max. Height..... 36"

Seat Size

Width..... 17"
Usable Depth..... 17-3/4"
Height from Floor..... 19-1/8"

Back Size

Width..... 17-1/2"
Height from Seat..... 20-1/4"

CONSTRUCTION

Caster..... Multi-Surface, open wheeled 2" diameter dual wheel.

Frame..... Momchromatic 1" round, 12 gauge steel tubing

Seat..... 1/2" thick, 5-ply curved plywood, 2-3/4" thick urethane foam cushion.

Back..... 1/2" thick, 5-ply curved plywood, 1" thick urethane foam cushion.

Upholstery..... See List Pricer. Customer own material (COM) required yardage per SKU = 2.0 yards.

Chair Weight..... 37 pounds.

Shipping Weight.. 48 pounds.

Shipped..... Completely assembled

Shipping Size..... 25.13" wide x 26.13" deep x 37.00" high (15.2 cubic feet)

Flammability

Rating..... Furnished upon request by The HON Company Customer Service. Model HPN1XU meets the State of California Department of Consumer Affairs Technical Bulletin 117-2013 requirements. Model HPN1FCXU meets the State of California Department of Consumer Affairs Technical Bulletin 133 requirements.

Note..... All measurements are per BIFMA/CMD procedures.





NO	53-3536
----	---------

REV	RELEASE	DATE	ORIG.	CHECKER	PDM/ECR NO.
FORMAL D.	01-21159-05	10-NOV-2014	ADV	GDL	

REVISION NOTES

HPNIXR HPNIFCXR WAS PNIR