

Congratulations on the purchase of your new *Signature Series* product!

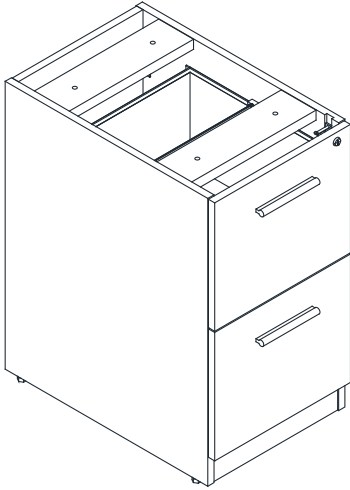

HARDWARE & TOOLS

- (A) Adjustable glide - 4pcs (B) Screw M6*40 - 4pcs (C) File clip - 4pcs (D) Metal bar 300*15*3- 2pcs (E) Key- 1set

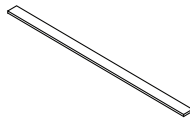
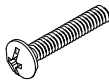
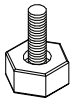

Tools Required for Assembly



Philips Screw Driver

INSTRUCTIONS

STEP 1

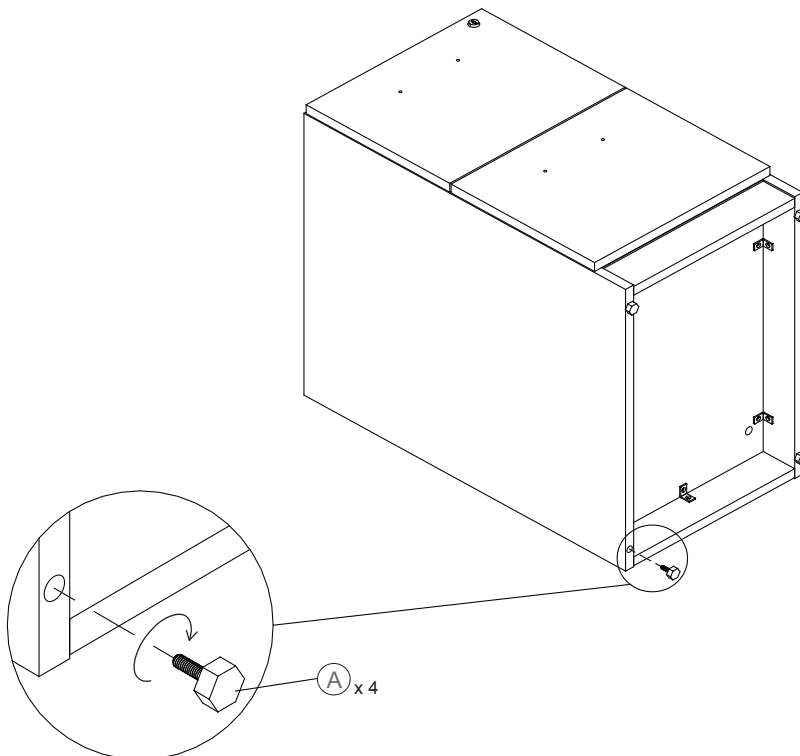

Congratulations on the purchase of your new *Signature Series* product!

INSTRUCTIONS

STEP 2

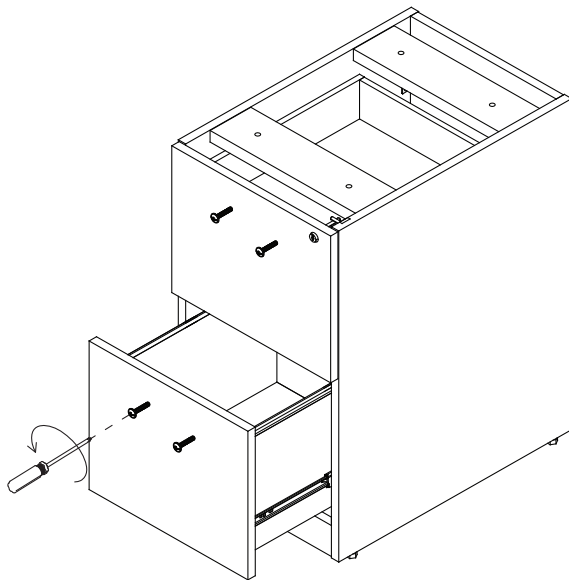

Install the handles on the front panel of drawers with screws.

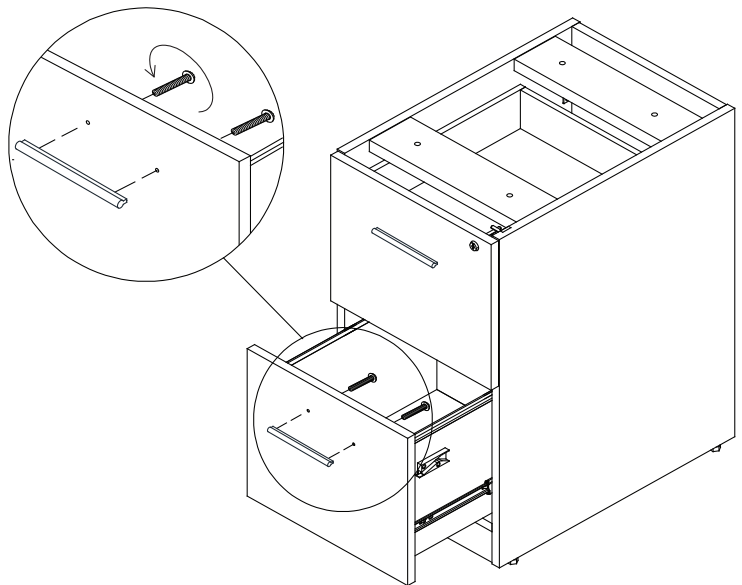

Take off the handles from back panel of drawers.

STEP 3

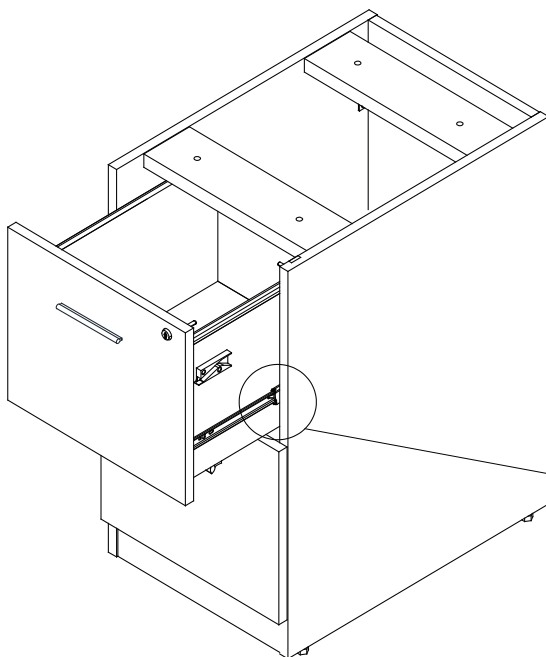

Press the right lever down and left lever up to take off 1 drawer

Lock Lever

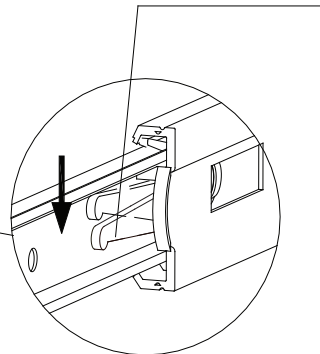

Congratulations on the purchase of your new *Signature Series* product!

INSTRUCTIONS

STEP 4

Press the right lever down and left lever up to take off 1 drawer

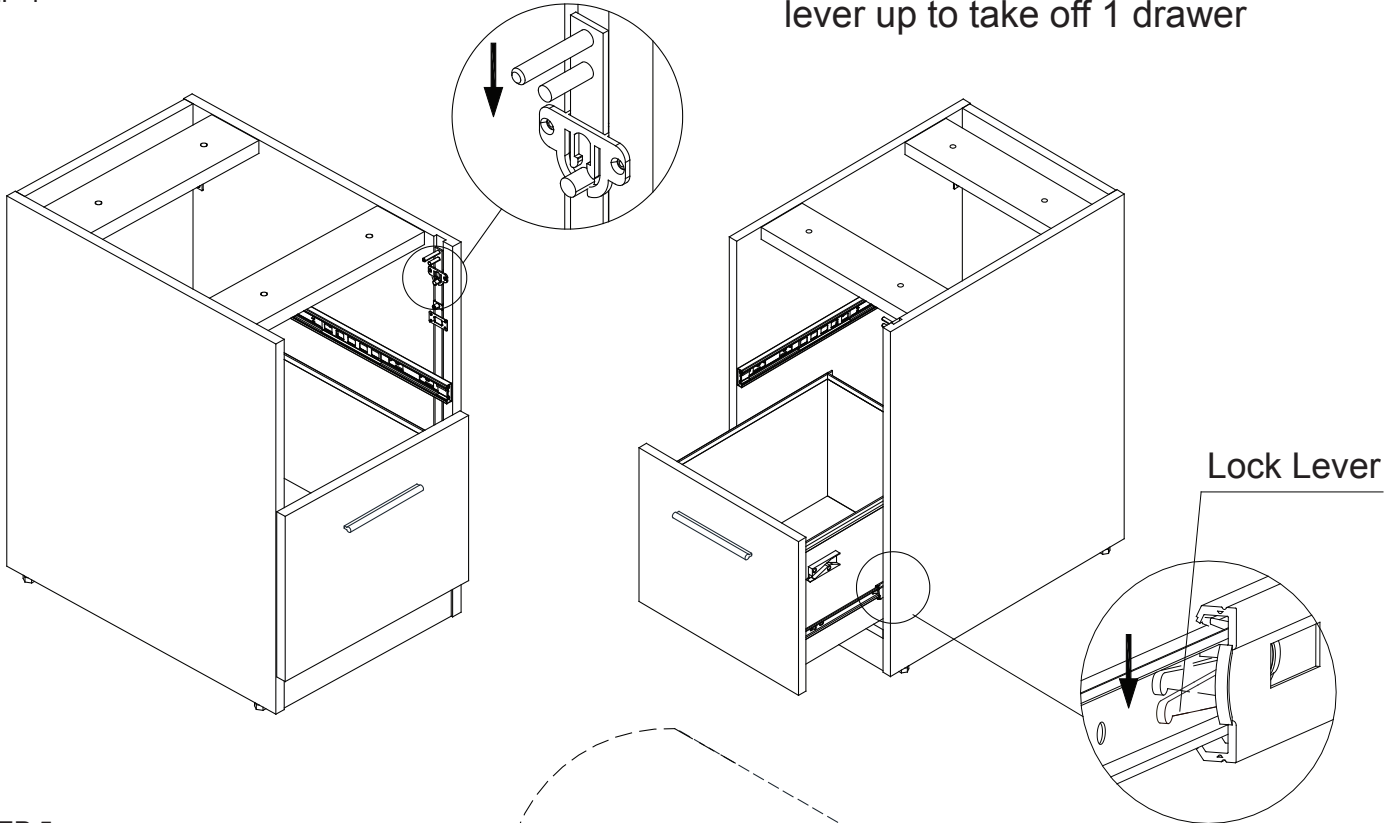

STEP 5

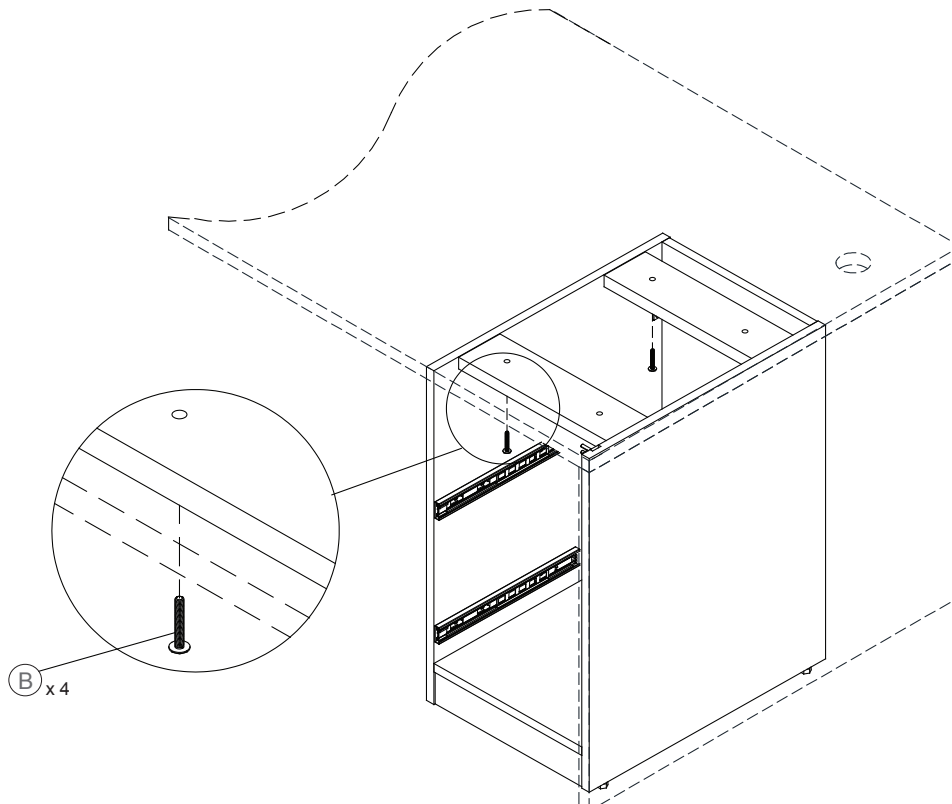

Congratulations on the purchase of your new *Signature Series* product!

INSTRUCTIONS

STEP 6

