

Congratulations on the purchase of your new *Signature Series* product!

COMPONENTS

(A) Top -1pc

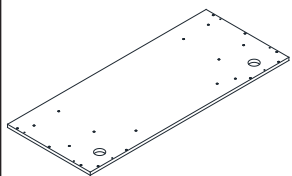

(B) Left side panel -1pc

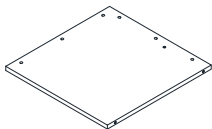

(C) Right side panel -1pc

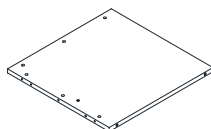

(D) Left vertical riser-1pc

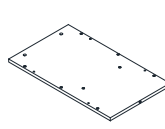

(E) Right vertical riser- 1pc

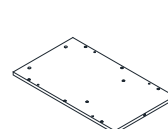

(F) Left small vertical plate - 1pc

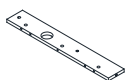

(G) Right small vertical plate- 1pc

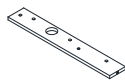

(H) Left short horizontal plate -1pc



(I) Right short horizontal plate -1pc



(J) Long horizontal board -1pc

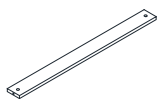

(K) Iron baffle -1pc

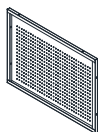

HARDWARE & TOOLS

(L) Cam bolt - 34pcs



(M) Cam lock - 34pcs



(N) Wood dowel - 14pcs



(O) Grommet - 4pcs

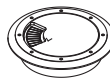

Tools Required for Assembly



Philips Screw Driver

(P) Camlock cap -22 pcs



(Q) Deep camlock cap- 12 pcs



(R) Allen Key - 1pc

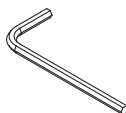

(S) Bolt M6*35mm-6pcs



(T) Adjustable glide - 8pcs



(U) Cable Clip - 2pcs



(V) Power unit - 2pcs

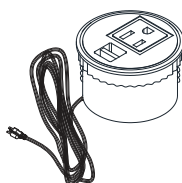

Congratulations on the purchase of your new *Signature Series* product!

INSTRUCTIONS

STEP 1

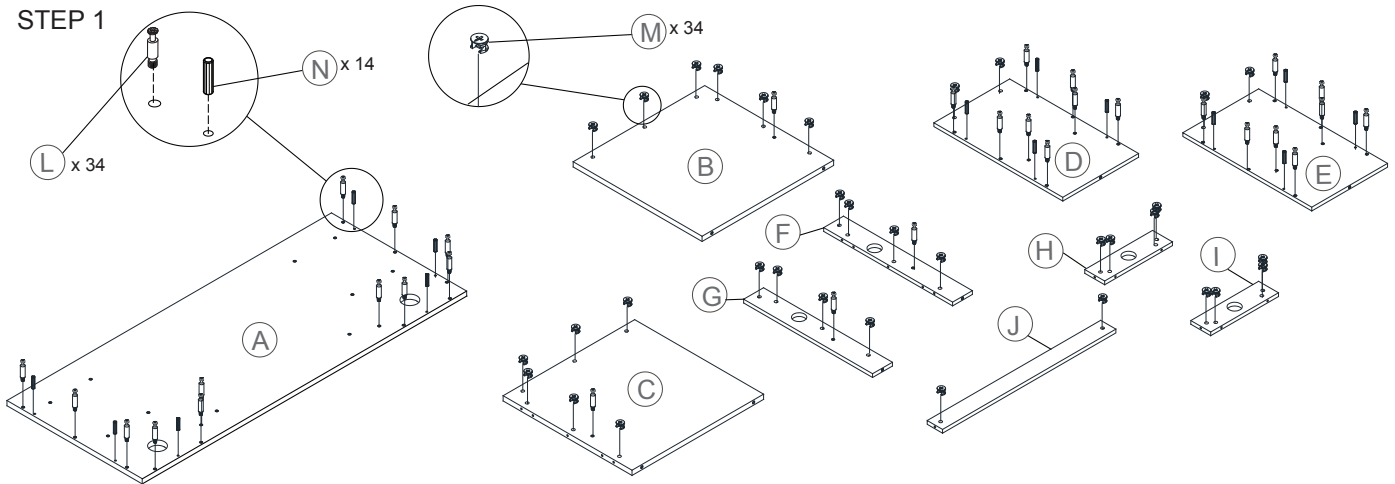

STEP 2

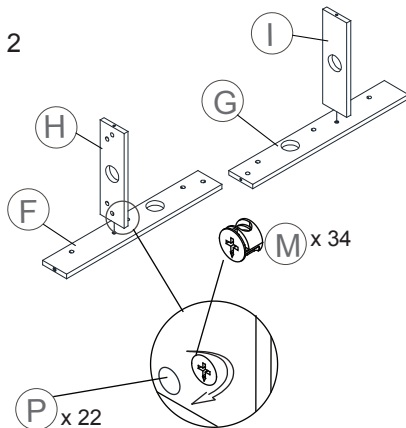

STEP 3

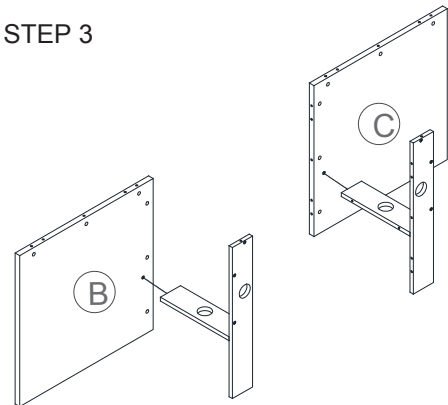

STEP 4

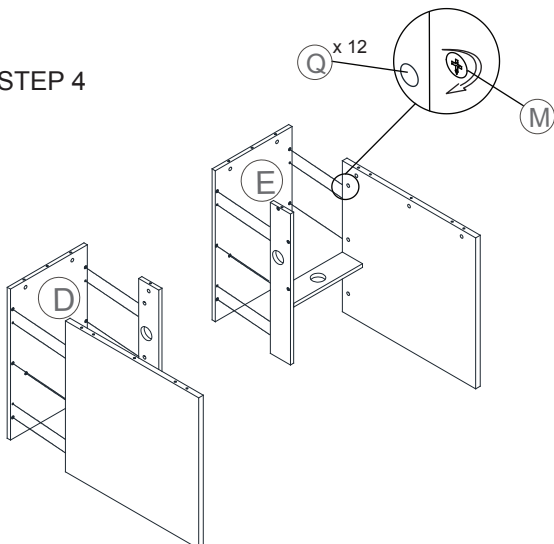

STEP 5

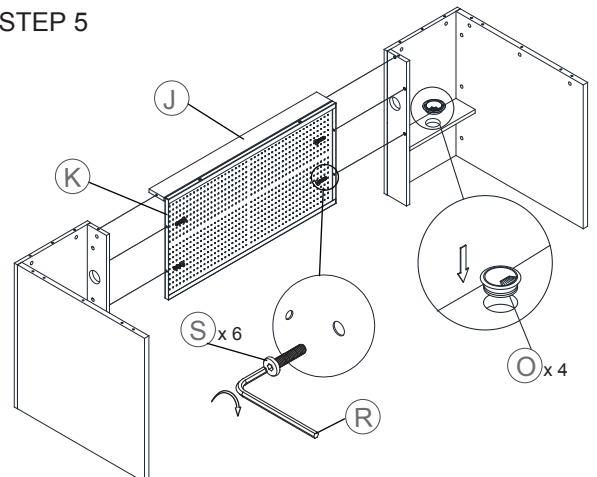

Congratulations on the purchase of your new *Signature Series* product!

INSTRUCTIONS

