

Congratulations on the purchase of your new *Signature Series* product!

COMPONENTS

(A) Top -1pc

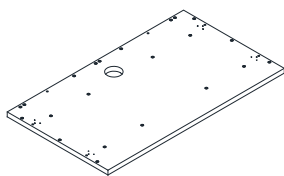

(B) side panel -1pc

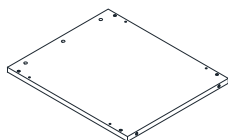

(C) Modesty panel -1pc

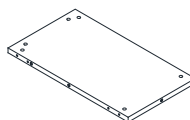

(D) Iron baffle -1pc

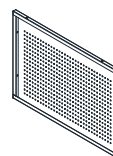

HARDWARE & TOOLS

(E) Cam bolt - 7pcs



(F) Cam lock - 7pcs



(G) Wood dowel - 5pcs



(H) Deep camlock cap- 9 pcs



(I) Bolt M6*35mm-6pcs



(J) Allen Key - 1pc

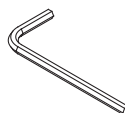

Tools Required for Assembly



Philips Screw Driver

(K) Adjustable glide - 3pcs



(L) Cap for metal insert - 2pcs



(M) Cap for metal insert - 4pcs



(N) Flat bracket - 2pcs

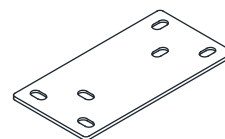

(O) Screw M4*16- 12pcs



(P) Cable Clip - 1pc



(Q) Power unit - 1pc

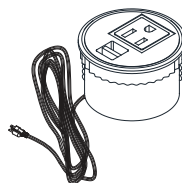

Congratulations on the purchase of your new *Signature Series* product!

INSTRUCTIONS

STEP 1

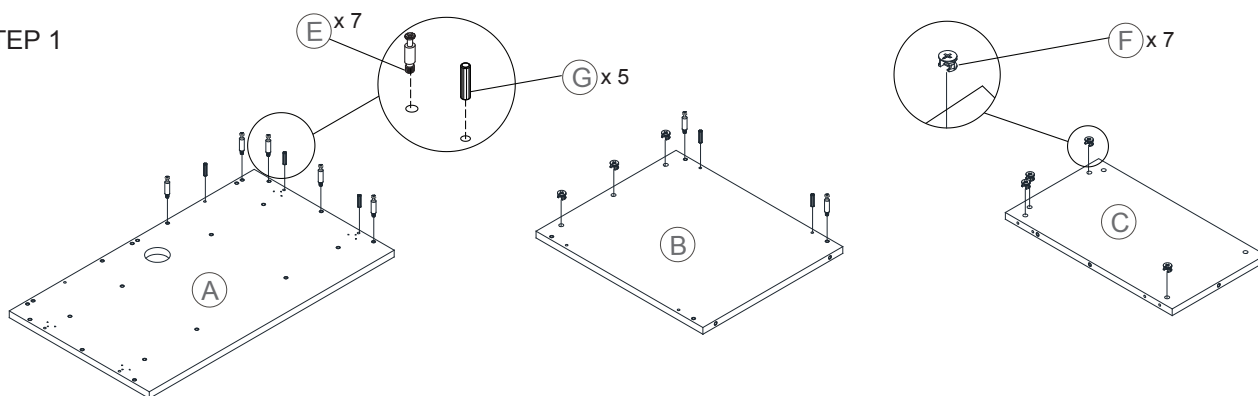

STEP 2

Left

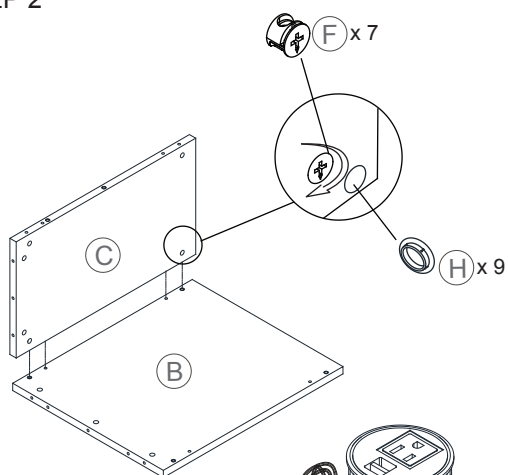

STEP 3

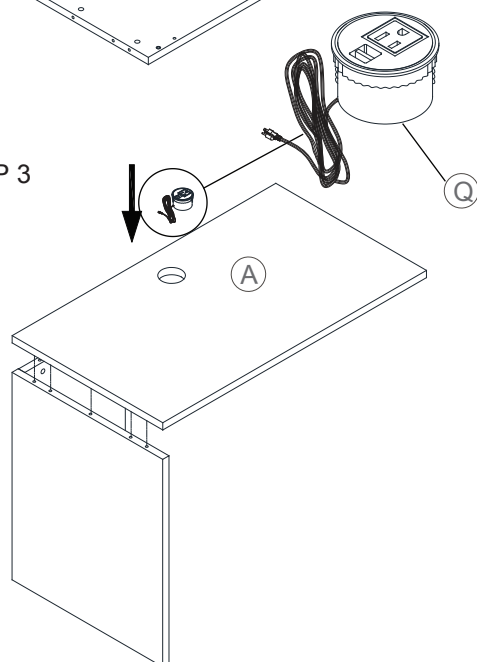

STEP 2

Right

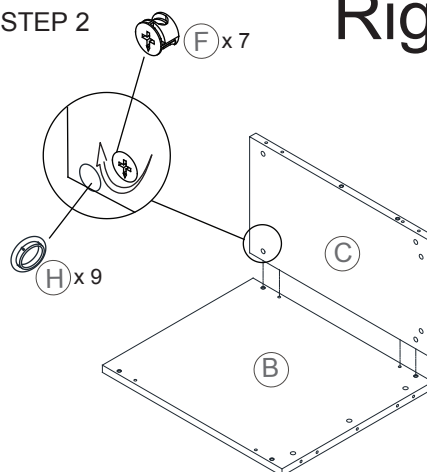

STEP 3

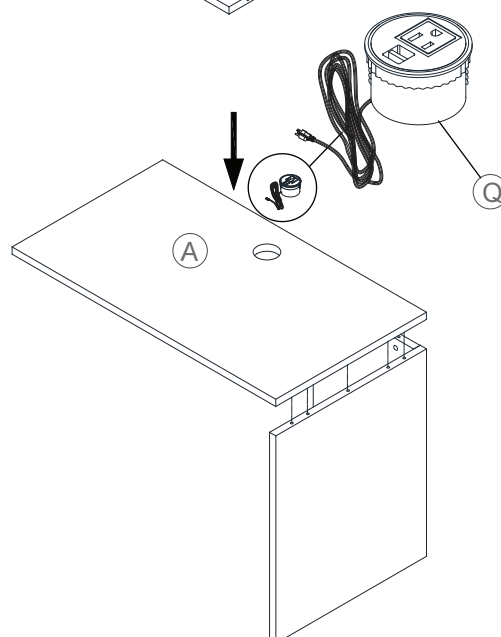

Congratulations on the purchase of your new *Signature Series* product!

INSTRUCTIONS

STEP 4

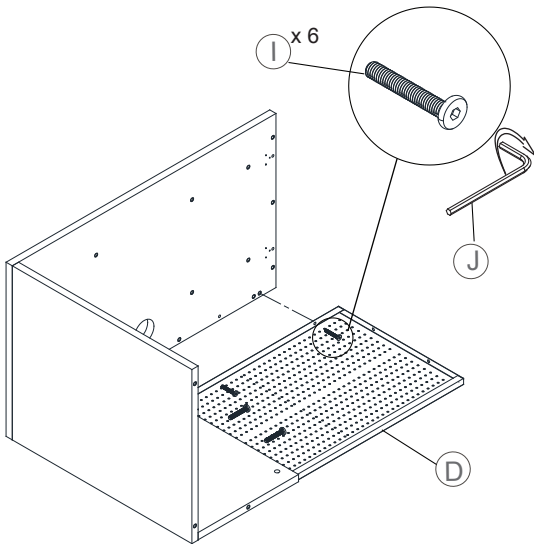

STEP 4

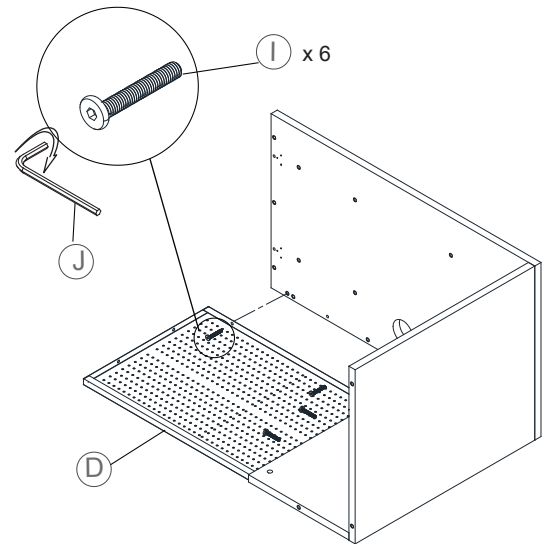

STEP 5

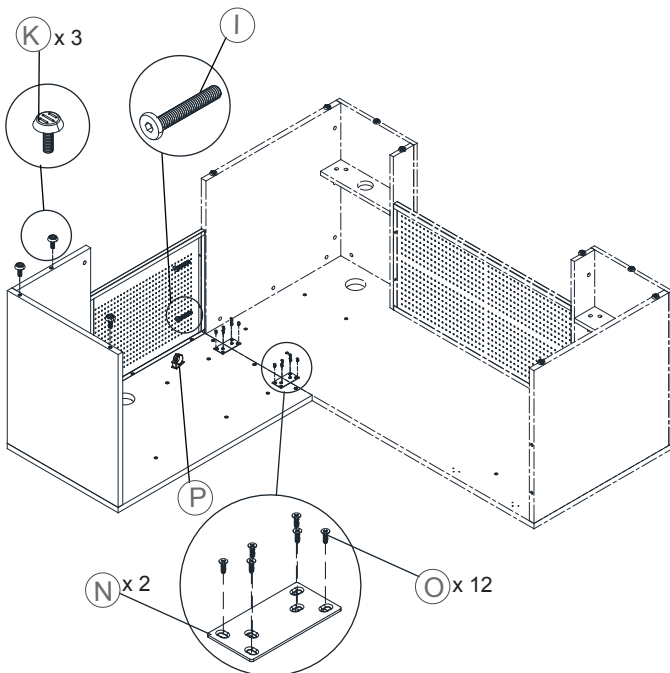

This model is used to install the demo.and
the normal installation should be placed upright.

STEP 5

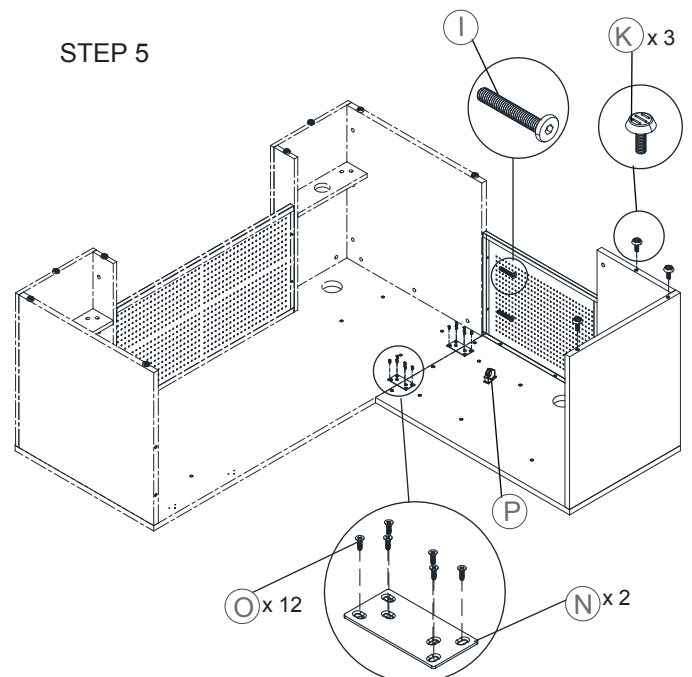

This model is used to install the demo.and
the normal installation should be placed upright.