

# Model 611 Ergonomic Manager's Chair

## Parts Listing

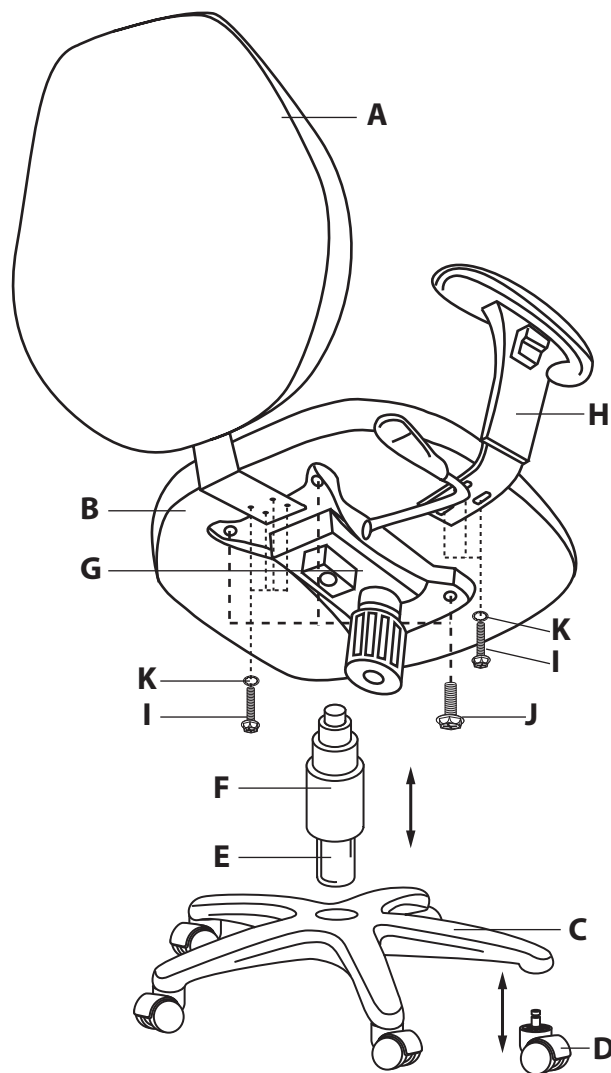
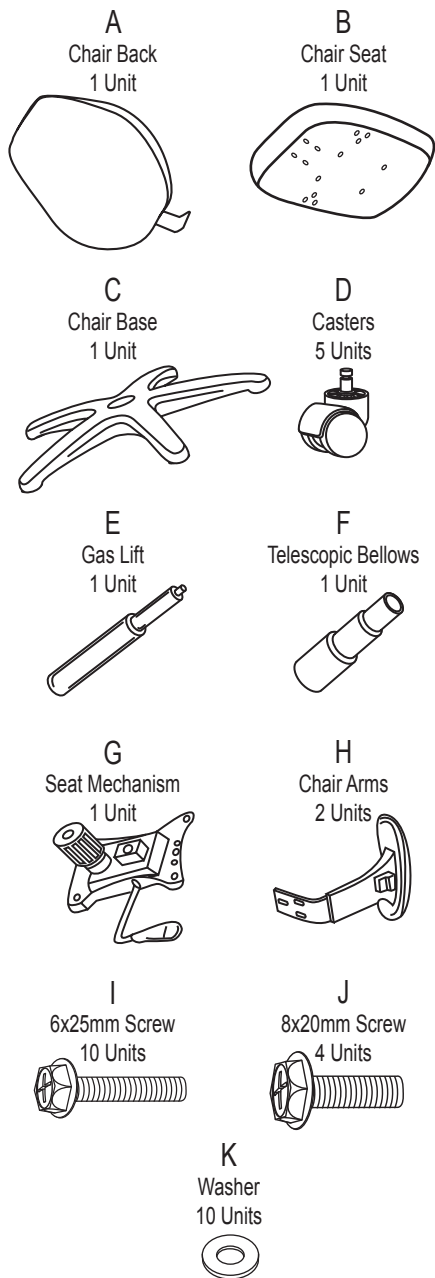

**WEIGHT CAPACITY: 250 lbs.**

### Assembly Notes:

During assembly, hand tighten screw only when all screws are in place, you may then tighten all screws completely.

### CAUTION:

1. Do not use this chair as a step ladder.
2. Check for loose screws and tighten them every 6 months.

## Assembly Instructions



**Tools Needed: Phillips Head Screwdriver**  
*Please read all instructions before assembly.*

- Step 1:** Insert Casters (D) into Chair Base (C).
- Step 2:** Insert Gas Lift (E) into the hole in the center of the Chair Base (C) and cover with Telescopic Bellows (F).
- Step 3:** Place Chair Seat (B) upside-down on a level, non-abrasive surface. Place Seat Mechanism (G) on Chair Seat (B) and align the holes in the Mechanism (G) with the holes in the Chair Seat (B).
- Step 4:** Insert 8x20mm Screws (J) through the holes in the Seat Mechanism (G) and into the Chair Seat (B).
- Step 5:** Attach Chair Back (A) to Chair Seat (B) using Washers (K) and 6x25mm Screws (I).
- Step 6:** Attach Chair Arms (H) to Chair Seat (B) using Washers (K) and 6x25mm Screws (I).
- Step 7:** Carefully place Chair Seat (B) with attached Seat Mechanism (G) onto the Gas Lift (E), aligning the hole in the Seat Mechanism (G) with the Gas Lift (E).
- Step 8:** Carefully sit on chair to make sure the Gas Lift (E) is properly inserted into the Base (C). Operate the gas lift lever on the Seat Mechanism (G) to be sure unit is working.

**ofm**<sup>U</sup><sub>Z</sub>  
Furniture For The Real Office™

161 Tradition Trail Holly Springs, NC, 27540  
800-520-7471 (voice) 919-362-4765 (fax)  
919- 303-6389 (voice) www.ofminc.com  
support@ofminc.com