



**FoodSaver**

Keeps food  
**Fresh Longer\***

# MealSaver™

## Quick-Start Guide

Features of your MealSaver™ Appliance

### Powerful Vacuum

Has the same strength as full size FoodSaver® Appliances.

### Power Button

Vacuums airtight with the press of a button.

### Vacuum Nozzle

Creates an airtight connection to FoodSaver® Zipper Bags and MealSaver™ containers.

### Reservoir

Catches overflow liquids and is dishwasher safe.

### Adaptor for Containers (included)

For use with all FoodSaver® vacuum storage containers.



### Retractable Vacuum Hose

Easy-to-use self-retracting hose saves space and stores neatly.

For more usage tips and safety information, please refer to this Reference Guide or visit our website at [www.foodsaver.com](http://www.foodsaver.com)

**If you need assistance call 1-877-777-8042**

\*Compared to unwrapped food

# Instructions

Grab your MealSaver™ Appliance and let's get started!



## Sealing FoodSaver® Vacuum Zipper Bag

**IMPORTANT:** Should liquid be collected in the reservoir, stop vacuuming once liquid fills to the Max fill line.



### Step 1

Place food in FoodSaver® Vacuum Zipper Bag. Do not place food in area under the green circle. Lay Zipper Bag flat with green circle facing upwards, align zipper grooves and slide fingers across zipper to close bag.

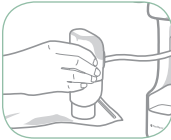

### Step 2

Plug power cord into outlet. Pull Vacuum Nozzle out of the unit and place over the green circle.

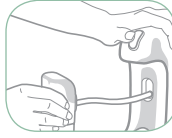

### Step 3

Apply gentle downward pressure over the green circle and press the green Power Button. The Vacuum will automatically stop when all of the air has been evacuated from the bag.

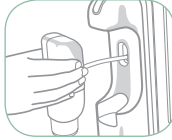

### Step 4

To Retract- gently extend the Vacuum Nozzle and return Nozzle to unit.



### Step 5

Store a bag with perishable food in the refrigerator or freezer or store a bag with non-perishable goods in a cabinet.



## Sealing FoodSaver® Containers

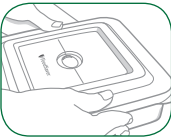

### Step 1

Place food in container. Place the lid on the container. Apply gentle pressure on the lid to snap it into place.

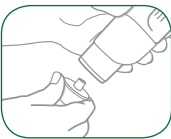

### Step 2

Plug the cord into outlet. Pull the Vacuum Nozzle out of the unit. Attach the Adaptor onto the Vacuum Nozzle by pressing the tip of the Adaptor into the bottom of the Vacuum Nozzle as show in the illustration.



### Step 3

With the Adaptor attached, place the Vacuum Nozzle over the gray valve on the lid of the container. Press the green Power Button. The Vacuum will automatically stop when all of the air has been evacuated from the container.



### Step 4

To Retract- gently extend the Vacuum Nozzle and return Nozzle to unit.



### Step 5

Store a container with perishable food in the refrigerator or freezer or store a container with non-perishable goods in a cabinet.

### Important:

To remove Reservoir from Vacuum Nozzle: Extend Vacuum Nozzle from unit, while holding Vacuum Nozzle with one hand, wiggle clear Reservoir away from Nozzle.

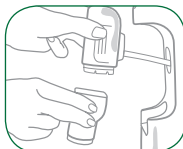

### Adaptor Storage:

Conveniently store Adaptor on back of unit by placing stem into storage hole.

