



crockpot™

Casserole Crock™ Slow Cooker

crockpot™



Casserole Crock™
Slow Cooker

Owner's Guide

Read and Keep These Instructions

© 2020 Sunbeam Products, Inc. All rights reserved. Distributed by Sunbeam Products, Inc. Boca Raton, Florida 33431.

Casserole Crock IB_Manual_Programmable_Mini_20EM1

ART0000906626

GCDS-CRP-JC

www.crockpot.com

Congratulations on your Crockpot™ Casserole Crock™ Slow Cooker purchase.

You will be amazed how often you will find yourself using this appliance for so many different dishes. Start the day with a delicious breakfast casserole that you can cook overnight – while you sleep! Or prep ingredients in the morning and come home to a hot, home-cooked, one-dish meal you can serve your family at the end of the day.

And, it's not just for casseroles! Make a pasta dish for a pot-luck party or a tailgate dessert for the game. There are so many different recipes available for slow cooker casseroles and entertaining dishes! You can find these great recipes online, or in slow cooker recipe books.

IMPORTANT SAFEGUARDS

When using electrical appliances, basic safety precautions should always be followed to reduce the risk of fire, electric shock, and/or injury to persons including the following:

1. Read all instructions before using this product.
2. This appliance generates heat during use. Do not touch hot surfaces. Use handles or knobs.
3. To protect against electric shock, do not place or immerse cord, plugs, or appliance in water or other liquid.
4. This appliance is not to be used by children or by persons with reduced physical, sensory or mental capabilities.
5. Close supervision is necessary when any appliance is used near children. Children should not play with the appliance.
6. Unplug from outlet when not in use, before putting on or taking off parts and before cleaning. Allow to cool before putting on or taking off parts, and before cleaning. To disconnect, turn any control to OFF, then unplug power cord from outlet. Do not disconnect by pulling on cord.
7. Do not operate any appliance with a damaged cord or plug or after the appliance malfunctions, or has been damaged in any manner. Do not attempt to replace or splice a damaged cord. Return appliance to the manufacturer (see warranty) for examination, repair or adjustment.

8. The use of accessory attachments not recommended by the appliance manufacturer may cause injuries.
9. Do not use outdoors or for commercial purposes.
10. Do not let cord hang over edge of table or counter, or touch hot surfaces.
11. Do not place on or near wet surfaces, or heat sources such as a hot gas or electric burner, or in a heated oven.
12. Extreme caution must be used when moving an appliance containing hot oil or other hot liquids.
13. The heating base is subject to residual heat from cooking cycle. Do not touch heating base immediately after removing stoneware. Allow to cool before handling.
14. Use caution when opening the lid during or after a cooking cycle. Escaping steam can cause burns.
15. Do not use appliance for other than intended use. Misuse can cause injuries.
16. Intended for household countertop use only. Keep 6 inches (152 mm) clear from the wall and on all sides. Always use appliance on a dry, stable, level surface.
17. Avoid sudden temperature changes, such as adding refrigerated foods or cold liquids into a heated pot.
18. The slow cooker lid is made of tempered glass. Always inspect the lid for chips, cracks or any other damage. Do not use the glass lid if it is damaged, as it may shatter during use.
19. **CAUTION:** To protect against electrical shock and product damage, do not cook directly in the heating base. Cook only in the stoneware provided.

20. **WARNING:** Spilled food can cause serious burns. Keep appliance and cord away from children. Never drape cord over edge of counter, never use outlet below counter, and never use with an extension cord.

For appliances with locking lids:

21. Never attempt to lift or carry this appliance by the lid handle. Always use the handles located at each side on the base of the appliance.
22. Do not lock the lid while cooking. Locking the glass lid while cooking may lead to glass breakage, which can cause injuries.

SAVE THESE INSTRUCTIONS HOUSEHOLD USE ONLY

NORTH AMERICAN MODELS WITH POLARIZED PLUGS:

POLARIZED PLUG



This appliance has a polarized plug (one blade is wider than the other). To reduce the risk of electric shock, this plug is intended to fit into a polarized outlet only one way. If the plug does not fit fully into the outlet, reverse the plug. If it still does not fit, contact a qualified electrician. Do not attempt to modify the plug in any way. If the plug fits loosely into the AC outlet or if the AC outlet feels warm do not use that outlet.

POWER CORD INSTRUCTIONS:

A short power-supply cord is used to reduce the risk resulting from it being grabbed by children, becoming entangled in, or tripping over a longer cord.

NOTICES:

1. Some countertop and table surfaces are not designed to withstand the prolonged heat generated by certain appliances. Do not set the heated unit on a finished wood table. We recommend placing a hot pad or trivet under your slow cooker to prevent possible damage to the surface.
2. During initial use of this appliance, some slight smoke and/or odor may be detected. This is normal with many heating appliances and will not recur after a few uses.
3. Please use caution when placing your stoneware on a ceramic or smooth glass cook top stove, countertop, table or other surface. Due to the nature of the stoneware, its rough bottom may scratch some surfaces if caution is not used. Always place heat resistant protective padding under the stoneware before setting on a table, countertop or other surface.

Change the way you 'role.

Enjoy delicious casseroles, lasagnas, desserts and more. The Crockpot™ Casserole Crock™ Slow Cooker will cook all day while you're away. And can be easily be taken on the go to parties and potlucks.

YOUR CROCKPOT™ CASSEROLE CROCK™ SLOW COOKER COMPONENTS

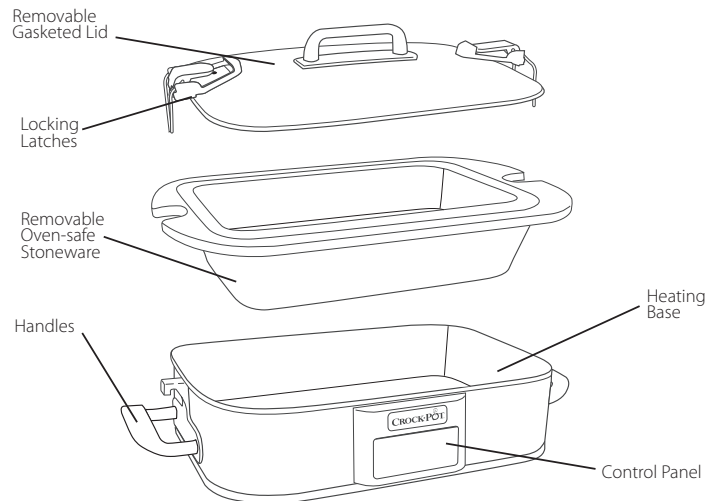

For Programmable Casserole Crock™:

For Manual Casserole Crock™:

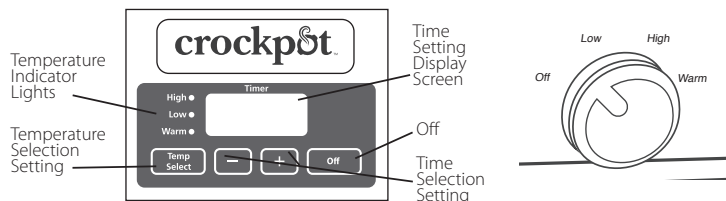

YOUR CROCKPOT MINI CASSEROLE CROCK™ SLOW COOKER COMPONENTS

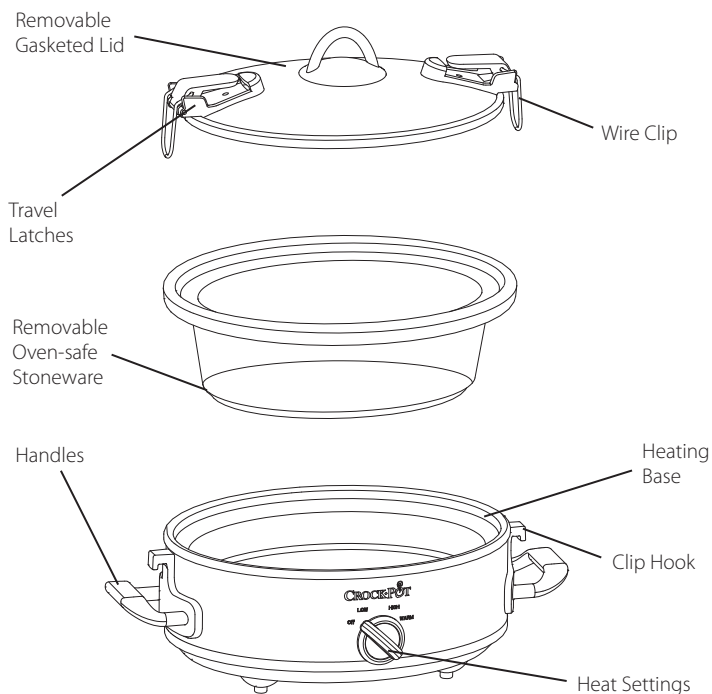

HOW TO USE YOUR CROCKPOT™ CASSEROLE CROCK™ SLOW COOKER

NOTE: This unit is designed to cook recipes low and slow. We recommend using casserole, lasagna, dessert and other recipes that are meant to be slow cooked over a longer period of time.

1. Place the stoneware into the heating base, add your ingredients into the stoneware and cover with the lid.

NOTE: Lid should not be in the locked position while cooking.

2. Plug in your Crockpot™ Casserole Crock™ Slow Cooker and select the temperature setting. Refer to your specific recipe for precise cook time.

NOTE: WARM is ONLY for keeping already cooked food warm. DO NOT cook on the WARM setting. We do not recommend using the WARM setting for more than 4 hours.

3. **For Programmable Units:** Press + or – to add or remove cooking time. The time can be set in increments of 30 minutes up to 20 hours. Select the time based on the length of time indicated in the recipe. The time will begin to count down in one minute increments.

4. **For Programmable Units:** When the cooking time has completed, the Crockpot™ Programmable Casserole Crock™ Slow Cooker automatically shifts to the WARM setting and the WARM light illuminates.

5. To turn the Crockpot™ Casserole Crock™ Slow Cooker off, press/switch to the OFF button and unplug the unit from the outlet.

6. When cooking is done, unplug your Crockpot™ Casserole Crock™ Slow Cooker and allow it to cool before cleaning.

USAGE NOTES:

- If you suspect that the power has gone out, the food may be unsafe to eat. If you are unaware of how long the power was out, we suggest you discard the food inside.
For Programmable units: The display and lights blink when the Power is restored. All slow cooker settings have been cleared and must be reset.
- For recipes that require a range of times, select the time closest to the setting on your slow cooker. For example, to cook a recipe calling for a cooking time of 7 to 9 hours on LOW, cook for 8 hours.
- To avoid over or under-cooking, always fill the stoneware $\frac{1}{2}$ to $\frac{3}{4}$ full and conform to recommended cook times.
- Do not overflow stoneware. To prevent spillover, do not fill stoneware higher than $\frac{3}{4}$ full.
- Always cook with the lid on for the recommended time. Do not remove the lid during the first two hours of cooking to allow the heat to build up efficiently.

- Use caution when handling as lid or stoneware may be hot.
- Unplug when cooking is done and before cleaning.
- Removable stoneware is ovenproof and microwave safe. Do not use removable stoneware on gas or electric burner or under broiler. Refer to chart on following page.
- The Casserole Crock™ stoneware was designed to use for cooking inside the heating base, and then be removed and transferred directly to the table for serving. Use a trivet to protect your counter top or table when serving from the stoneware.
- The removable stoneware is also oven-safe. If desired, you can cook your recipe in the oven, and then transfer it to the heating base to take on the go or to keep warm while serving.

HOW TO USE YOUR CROCKPOT™ CASSEROLE CROCK™ SLOW COOKER

Part	Dishwasher Safe	Oven Safe	Microwave Safe	Stovetop Safe
Lid	Yes	No	No	No
Stoneware	Yes	Yes, but not in the broiler	Yes	No

HOW TO CLEAN YOUR CROCKPOT™ CASSEROLE CROCK™ SLOW COOKER

- ALWAYS turn your slow cooker off, unplug it from the electrical outlet, and allow it to cool before cleaning.
 - The lid and stoneware can be washed in the dishwasher or with hot, soapy water. Do not use abrasive cleaning compounds or scouring pads. A cloth, sponge, or rubber spatula will usually remove residue. To remove water spots and other stains, use a non-abrasive cleaner or vinegar.
 - As with any fine ceramic, the stoneware and lid will not withstand sudden temperature changes. Do not wash the stoneware or lid with cold water when they are hot.
 - The outside of the heating base may be cleaned with a soft cloth and warm, soapy water. Wipe dry. Do not use abrasive cleaners.
- CAUTION:** Never immerse the heating base in water or other liquid.
- This appliance has no user serviceable parts. Any servicing beyond that described in the Cleaning Section should be performed by an Authorized Service Representative only. See Warranty Section.

PREPARING YOUR CROCKPOT™ CASSEROLE CROCK™ SLOW COOKER FOR USE

Before you use your Casserole Crock™, remove all packaging components and wash the lid and stoneware in warm, soapy water and dry thoroughly.

LOCKING THE LID

1. Place Lid on Stoneware. Hook Wire Clip onto Clip Hook (Figure 1).
Flip Latch around to top (Figure 2) and push Latch down to securely lock (Figure 3). Repeat steps on other side of the lid.

NOTE: Lid should NOT be in locked position while cooking.

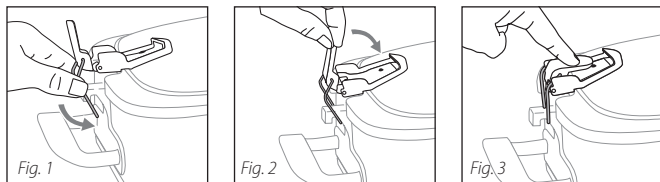

UNLOCKING THE LID

1. Flip the latch up and around to loosen the Wire Clip. Clear the Wire Clip from the Clip Hook. Repeat steps on other side of the lid.
2. Remove the Lid.
3. Wire should remain in Latch base when unit is unlocked (Figure 4).

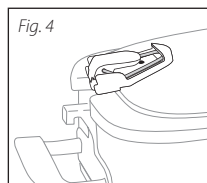

CAUTION: NEVER attempt to lift or carry your Crockpot™ Casserole Crock™ Slow Cooker by the lid handle. Always use the handles located at each side on the base of the unit.

TIPS

- When cooking dishes like bread pudding, strata and pasta, push pieces of bread and pasta into liquid mixture to moisten before cooking.
- Unless the recipe instructs to do so, do not lift the lid during cooking. Significant heat can be lost and the cooking will be delayed.
- For a crisper or more browned top, turn off slow cooker when cooking is complete and remove casserole from the base. Transfer to a preheated oven (350 to 400°F) and bake for 10 to 15 minutes.
- Allow casserole dishes to stand for 10 to 15 minutes before serving, allowing the food to set up before cutting or scooping.
- Coat sides and bottom of casserole dish with cooking spray or butter before cooking to make clean-up easier.

SERVICE INSTRUCTIONS

1. Do NOT attempt to repair or adjust any electrical or mechanical functions on this unit. Doing so will void the Warranty.
2. If you need to exchange the unit, please return it in its original carton, with a sales receipt, to the store where you purchased it. If you are returning the unit more than 30 days after the date of purchase, please see the enclosed Warranty.
3. If you have any questions or comments regarding this unit's operation or believe any repair is necessary, please call our Consumer Service Department at 1-800-323-9519 or visit our website at www.crockpot.com.

1 YEAR LIMITED WARRANTY

Sunbeam Products, Inc. or if in Canada, Sunbeam Corporation (Canada) Limited (collectively "Sunbeam") warrants that for a period of one year from the date of purchase, this product will be free from defects in material and workmanship. Sunbeam, at its option, will repair or replace this product or any component of the product found to be defective during the warranty period. Replacement will be made with a new or remanufactured product or component. If the product is no longer available, replacement may be made with a similar product of equal or greater value. This is your exclusive warranty. Do NOT attempt to repair or adjust any electrical or mechanical functions on this product. Doing so will void this warranty.

This warranty is valid for the original retail purchaser from the date of initial retail purchase and is not transferable. Keep the original sales receipt. Proof of purchase is required to obtain warranty performance. Sunbeam dealers, service centers, or retail stores selling Sunbeam products do not have the right to alter, modify or any way change the terms and conditions of this warranty.

This warranty does not cover normal wear of parts or damage resulting from any of the following: negligent use or misuse of the product, use on improper voltage or current, use contrary to the operating instructions, disassembly, repair or alteration by anyone other than Sunbeam or an authorized Sunbeam service center. Further, the warranty does not cover: Acts of God, such as fire, flood, hurricanes and tornadoes.

What are the limits on Sunbeam's Liability?

Sunbeam shall not be liable for any incidental or consequential damages caused by the breach of any express, implied or statutory warranty or condition.

Except to the extent prohibited by applicable law, any implied warranty or condition of merchantability or fitness for a particular purpose is limited in duration to the duration of the above warranty.

Sunbeam disclaims all other warranties, conditions or representations, express, implied, statutory or otherwise.

Sunbeam shall not be liable for any damages of any kind resulting from the purchase, use or misuse of, or inability to use the product including incidental, special, consequential or similar damages or loss of profits, or for any breach of contract, fundamental or otherwise, or for any claim brought against purchaser by any other party.

Some provinces, states or jurisdictions do not allow the exclusion or limitation of incidental or consequential damages or limitations on how long an implied warranty lasts, so the above limitations or exclusion may not apply to you.

This warranty gives you specific legal rights, and you may also have other rights that vary from province to province, state to state or jurisdiction to jurisdiction.

How to Obtain Warranty Service

In the U.S.A.

If you have any questions regarding this warranty or would like to obtain warranty service, please call 1-800-323-9519 and a convenient service center address will be provided to you.

In Canada

If you have any questions regarding this warranty or would like to obtain warranty service, please call 1-800-323-9519 and a convenient service center address will be provided to you.

In the U.S.A., this warranty is offered by Sunbeam Products, Inc. located in Boca Raton, Florida 33431. In Canada, this warranty is offered by Sunbeam Corporation (Canada) Limited, located at 20 B Hereford Street, Brampton, Ontario L6Y 0M1. If you have any other problem or claim in connection with this product, please write our Consumer Service Department. **PLEASE DO NOT RETURN THIS PRODUCT TO ANY OF THESE ADDRESSES OR TO THE PLACE OF PURCHASE.**

To register your product, please visit us online at www.crockpot.com.