



INFLATABLE BOATS

Including the following Model Series:
Colossus™ and HUI

READ THE FOLLOWING INSTRUCTIONS AND WARNINGS TO AVOID DROWNING OR SERIOUS INJURY



WARNING:

- Not a life saving device.
- Not for use by children without adult supervision.
- Always wear an approved Personal Flotation Device (Life Preserver).
- Do not overload.
- Never tow from another boat or vehicle.
- Use only in water away from debris and obstructions.
- Do not use in high wind, strong currents, open water or dangerous tides.
- Be familiar with the area you intend to use the product.
- Never allow diving into or from these products.
- Never leave in or near water when not in use.
- Know and follow local water safety rules and boating regulations.
- Use only in protected waters.
- Do not use this product under the influence of alcohol or drugs.
- Do not over inflate.
- Follow inflation sequence on the product.

IMPORTANT INFORMATION

The warnings below relate to various situations. Please observe them.

CAUTION!

Denotes a imminent hazard which will result in severe injury if you do not comply with the instructions.

WARNING!

Reminds you of safety measures which must be observed. Also denotes unsafe practices which could result in personal injury or damage to the product or property, if you do not comply with the instructions.

CAUTION!

It is the owner's responsibility to make sure all users carefully read and follow the instructions for safe operation of this product. Observe all local and national laws. Always wear a Personal Flotation Device approved by the proper authorities. Please carefully observe the Capacity Plate information which is printed on the product.

WARNING!

These products are not meant for towing because the extreme pressure of the water while towing can tear the eyelets and/or handles. These products are not meant to be used in whitewater.

CAUTION!

Altering the construction of these products could jeopardize the safety of the occupants and will void the limited warranty.

CAUTION!

Keep boat away from gasoline, battery acid, solvents, etc., as they can damage the product.

INFLATION INSTRUCTIONS

⚠ CAUTION!

Do not over inflate. Pressurize product to "Inflation Pressure" stated in the chart for your specific product.

⚠ WARNING!

Never use a compressor, CO₂ or compressed air to inflate the product. Do not let Your product come into contact with sharp, pointed objects.

To inflate using any Sevylor® Pump:

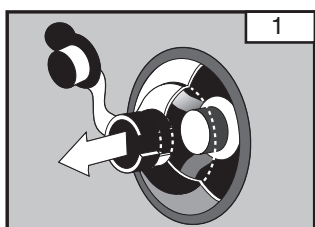

1. To begin inflation, open external cap and pull firmly on the lanyard to extend out. This will open internal yellow seal.

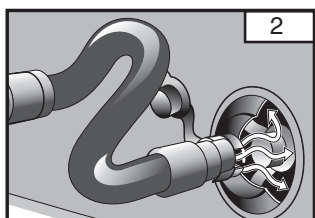

2. Attach nozzle of hose to inflation end of pump. Insert adapter nozzle into valve and start pumping.

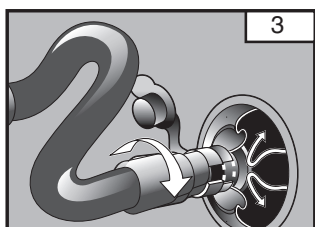

3. When fully inflated, seal valve by pushing in with adapter nozzle. This will seal the internal yellow stopper and keep air from escaping while closing cap. Gently twist adapter while backing hose out of valve.

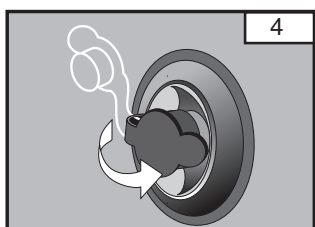

4. Fully remove pump and hose and close external cap. Valve should appear depressed into itself.

IMPORTANT! Inflate the product chambers in the following order:

1. Inflate the inside all-around safety chamber.
2. Inflate the floor chamber(s).
3. Inflate the outside main chamber.

The chambers on the product will be numbered to indicate order of inflation also. This order of inflation will ensure the proper volume and buoyancy of the safety chamber.

Note: To inflate the mini double lock™ valve, which is used on some of the Sevylor boat floors and seat bottoms, follow the same inflation instructions above, using the mini double lock™ valve adapter. The mini Double Lock™ valve adapter is included with all Sevylor® pumps. The adapter can be purchased from Customer Service by calling 1-800-835-3278 (Part Number 5010000707).

CAUTION!

Water temperature and weather do affect the pressure in inflatable products. In cold weather your product will lose some pressure due to the fact the air will contract. If this occurs, you may want to add a little air to improve your product's performance. However, in hot weather, the air will expand. You must let some air out to prevent your product from failing due to overpressure. You should avoid exposing your product to extreme temperatures (hot or cold).

DEFLATION INSTRUCTIONS

Deflation instructions using any Sevylor® Pump:

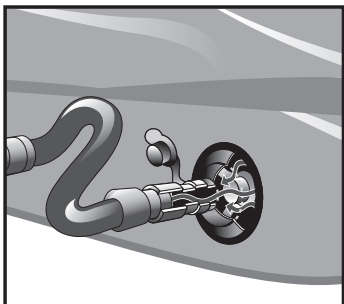

Remove nozzle of hose from inflation end and attach to opposite deflation end of pump. Repeat same steps as inflation. This will draw the air out quickly.

⚠ WARNING!

Do not exceed the certified maximum capacities under any circumstances!

	Persons Capacity	Maximum Pay-load Capacity	Engine	Inflation Pressure	Inflation Pressure
Model #	Persons Only	Persons, Gear, Motor (if applicable)	Max. HP Engine	Main Chamber(s)	Floor Chamber(s)
HUI 100	1 Pers. or 190 lbs.	190 lbs.	N/A	0.4 PSI	0.4 PSI
HUI 200	2 Pers. or 370 lbs.	370 lbs.	N/A	0.4 PSI	0.4 PSI
HUI 400	4 Pers. or 650 lbs.	650 lbs.	N/A	0.4 PSI	0.4 PSI

⚠ WARNING!

Do not exceed the certified maximum capacities under any circumstances!

	Persons Capacity	Maximum Pay-load Capacity	Engine	Inflation Pressure	Inflation Pressure
Model #	Persons Only	Persons, Gear, Motor (if applicable)	Max. HP Engine	Main Chamber(s)	Floor Chamber(s)
Colossus™ 2 Person Boat	2 Pers. or 435 lbs.	435 lbs.	N/A	0.5 PSI	0.5 PSI
Colossus™ 3 Person Boat	3 Pers. or 680 lbs.	680 lbs.	N/A	0.5 PSI	0.5 PSI
Colossus™ 4 Person Boat	4 Pers. or 840 lbs.	840 lbs.	N/A	0.5 PSI	0.5 PSI

⚠ WARNING!

Do not attempt to mount a motor on any boat that does not state a Max. HP Engine rating.

OPERATING INSTRUCTIONS:

- Follow all local boating regulations and navigation rules. Familiarize yourself with boating conditions where you plan to use the product. Use common sense and caution when operating in unfamiliar places.
- Observe the maximum weight the product can carry and do not overload past this limit. Over-loading jeopardizes the safety of the occupants.
- Be sure all accessories and/or equipment (e.g. oars, life jackets) are in proper working condition before using the product. Each person occupying the product is to wear an approved Personal Flotation Device (life preserver).
- Sharp objects are not to be carried in the product without adequate protection or storage.
- When navigating the product in any water depth, watch for submerged or sharp objects that may damage or pierce the product's air chambers.
- Enter the product from the port (left) or starboard (right) sides - not from the fore (front) or aft (back) sides.
- Never tow with a boat or any other vehicle.

MOTOR MOUNTING

DANGER!

CARBON MONOXIDE (CO) CAN CAUSE PERSONAL INJURY, BRAIN DAMAGE OR DEATH.

Carbon monoxide is an odorless, colorless, extremely toxic gas. Symptoms of carbon monoxide poisoning are dizziness, ears ringing, headaches, nausea and unconsciousness.

Have the victim breathe fresh air deeply. If breathing stops, resuscitate. A victim often revives, then relapses because organs are damaged by lack of oxygen. Seek immediate medical attention.

WARNING!

ROTATING PROPELLER MAY CAUSE SERIOUS INJURY OR DEATH

- Keep away from the rear of boat while engine is running.

WARNING!

- **DO NOT** mount a motor on any boat that exceeds the Maximum Horsepower rating for your specific boat model. See pages 5.

PROPER SEATING LOCATION



WARNING!

AVOID SERIOUS INJURY OR DEATH

- DO NOT sit on the side tubes while the product is underway. Sudden movement of the product will cause you to lose balance and fall. Sit on the floor or on the seating cushion and use the grab line to prevent loss of balance.

CARE & STORAGE:

- Your product is made of the highest quality materials. Altering the construction of your product will void the limited warranty and could jeopardize the safety of the occupants.
- If your product has been used in salt water, rinse it off with fresh water as soon as possible.
- Remove tar spots or other soiled areas by using a mild soap and rinsing with fresh water.
- Be sure Your product is completely dry before storing.
- The product may be stored inflated, but do not place any heavy or sharp objects on or near it. Storage is best in a dry room.

Colossus™ Models

4 PERSON

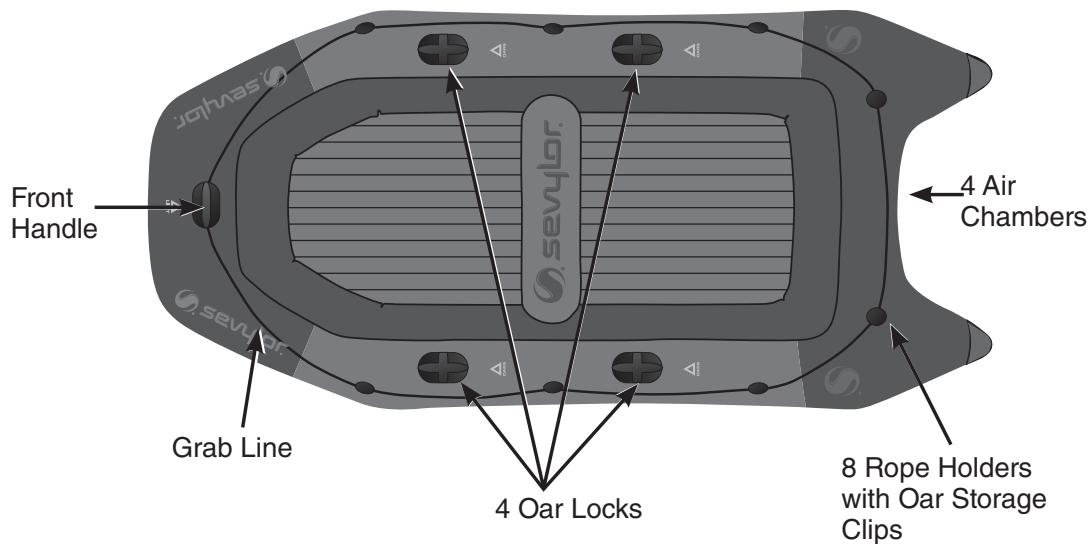

3 PERSON

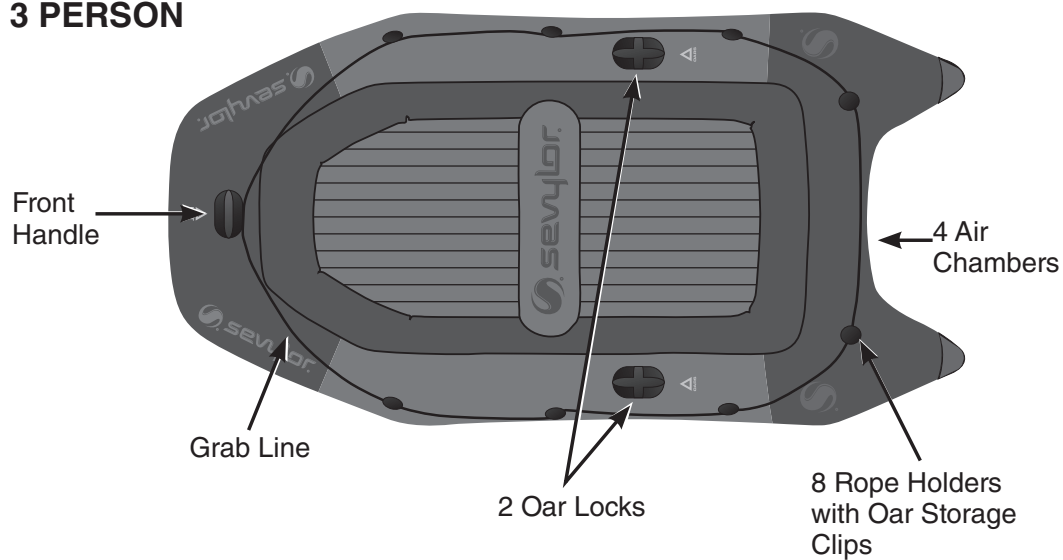

2 PERSON

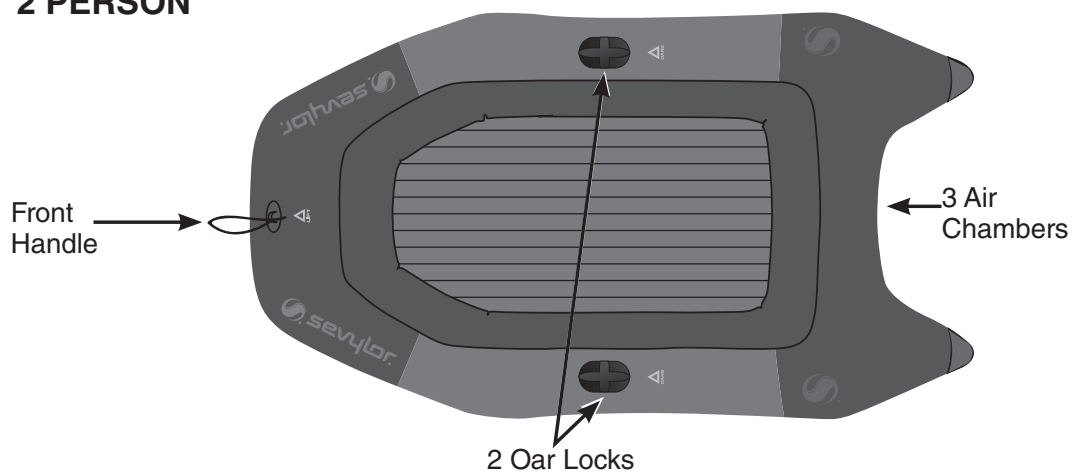

HUI Models

HUI 400

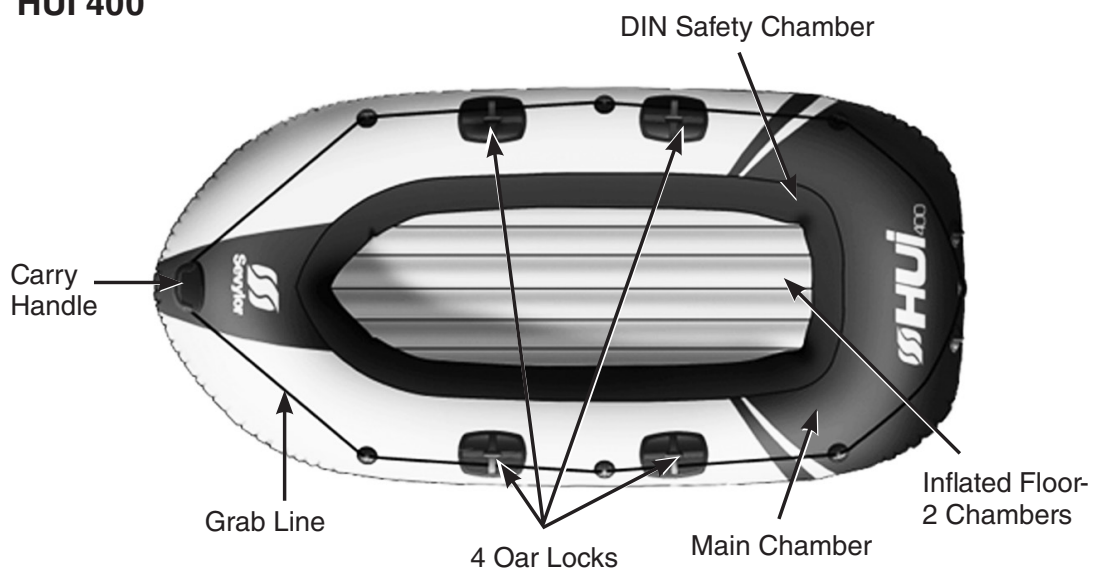

HUI 200

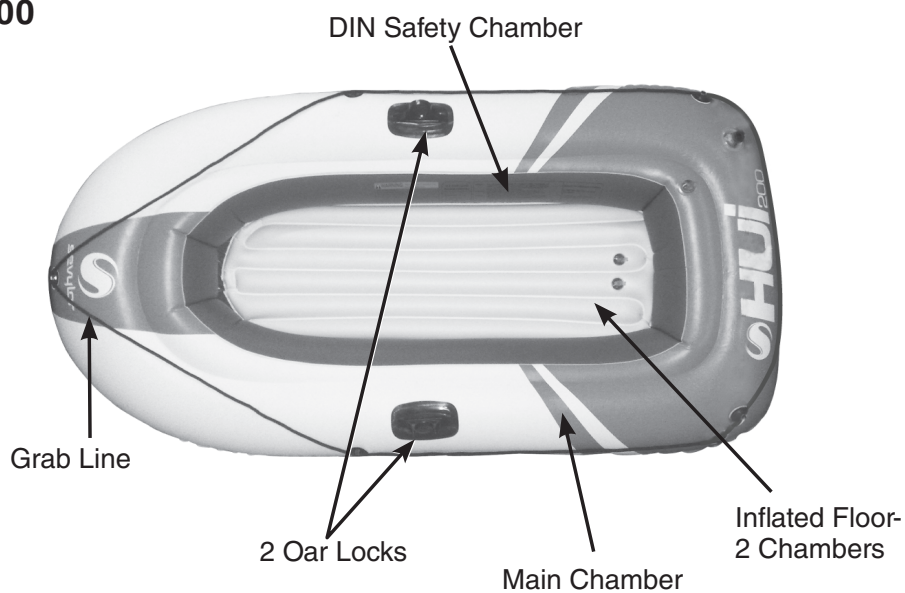

HUI 100

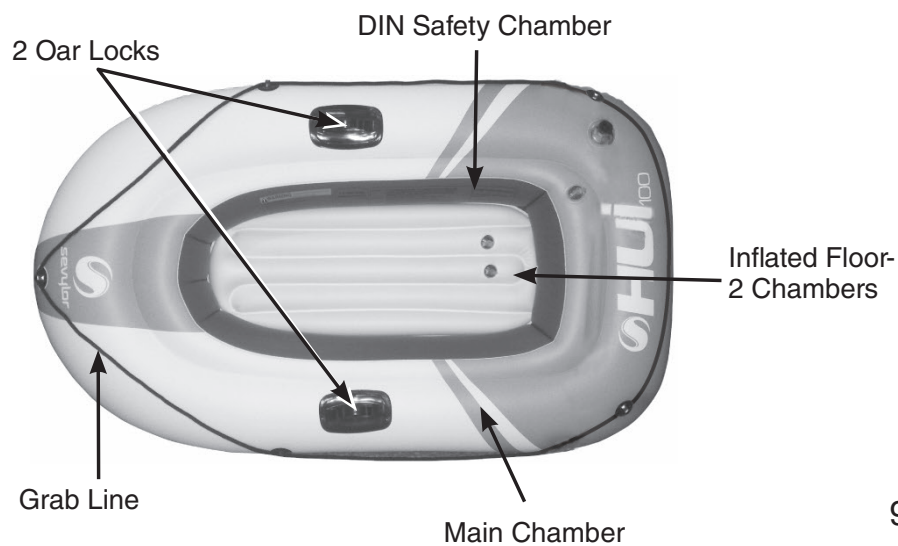

GRAB LINE INSTALLATION:

IMPORTANT: To properly install the inflatable boat's grab line, first inflate the product. Feed the grab line through the eyelets on each of the rope holders. Then tie the two loose ends in a square knot at the rear of the product.

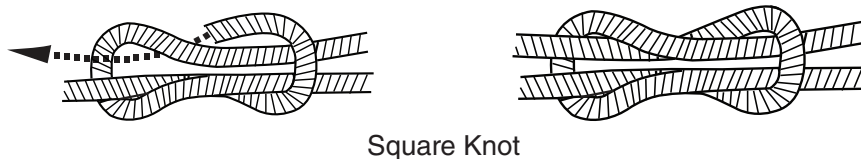

Square Knot

OAR ASSEMBLY: (for models with oar included)

Join the two shafts together by screwing them together into the coupler. Attach the blade to the shafts by screwing in into the bottom of the shaft.

Replacement Part #2000004151

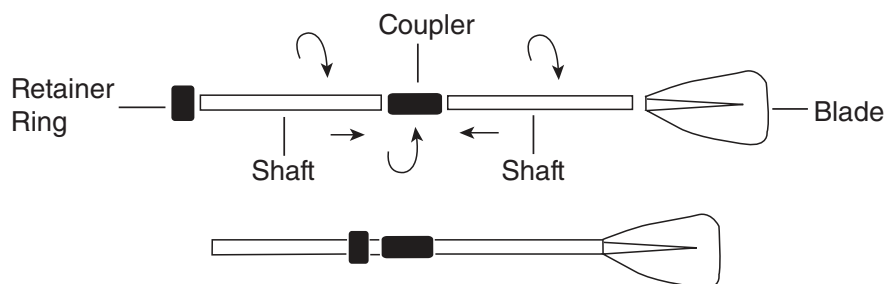

The assembled oar is to be inserted into the oar locks from the outside of the product. The oar retainer ring is then placed onto the top half of the assembled oar, from the inside of the product, to prevent the oar from sliding into the water (see below).

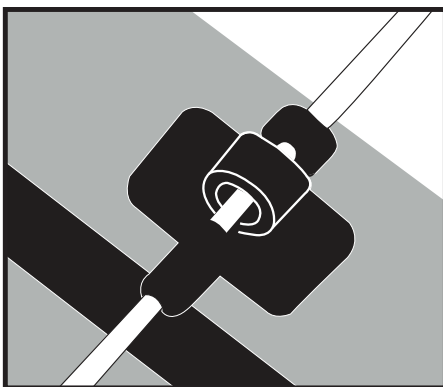

REPAIRING SMALL PUNCTURES

Inadvertent punctures can be repaired using 3 different methods described below.

Included “Sticky Back Repair Patch” (included with select models only)

1. Thoroughly clean and dry the damaged area. Completely deflate the product.
2. Cut a portion of the patch to cover the puncture and allow an additional ¼" on all sides. Always cut a round or oval patch, never leave square corners.
3. Be sure the repair area is completely dry.
4. Peel the backing from the patch.
5. Adhere the patch to the puncture.
6. Using your thumb or finger, apply even pressure across the entire surface of the patch.

Included Vinyl Repair Patch (included with select models only)

If your model does not include the Sticky Repair Patch noted above, then it will come with a Vinyl Repair Patch. This vinyl repair patch does not include vinyl glue, but it can be purchased from any home or hardware store (PVC cement).

1. Thoroughly clean and dry the damaged area. Completely deflate the product.
2. Cut a portion of the patch to cover the puncture and allow an additional ¼" on all sides. Always cut a round patch, never leave square corners.
3. Be sure the repair area is completely dry.
4. Apply generous coat glue to the vinyl repair patch and to the product.
5. Allow the glue to dry for 2 to 3 minutes, or until the glue becomes tacky.
6. Apply the patch to the product, using your thumb or finger; apply even pressure across the entire surface of the patch. Make sure the edges of the patch are pressed down along the entire diameter.
7. Allow the product to dry for at least 10 hours before inflating and using.

You may purchase the Sevylor® Repair Patch (2000014178) which is a no-glue, pressure sensitive patch great for tears up to 1 inch long.

You may also purchase the Sevylor® Air Seal (2000015201) which is a special no patch liquid that will repair pinholes in 5 minutes. These and more products can be found by calling Coleman Customer Service at 1-800-835-3278 or by visiting www.sevylor.com.

© 2014 The Coleman Company, Inc. All rights reserved.

Double Lock™ and Colossus™ are trademarks of The Coleman Company, Inc.
Sevylor® and  are registered trademarks of The Coleman Company, Inc.



3600 North Hydraulic • Wichita, KS 67219 U.S.A.
1-800-835-3278 • www.Sevylor.com