

Congratulations on the purchase of your new *Signature Series* chair!

PARTS

PART	DESCRIPTION	QTY
1	Casters	5
2	5-Star Base	1
3	Cylinder	1
4	Seat Plate	1
5	Seat Cushion	1
6A	Left Arm	1
6B	Right Arm	1
7	Back Cushion	1
8	1" Small Screws	8
9	1¼" Big Screws	6
10	1½" Big Screws	2
11	Hexagonal Wrench	1

INSTRUCTIONS

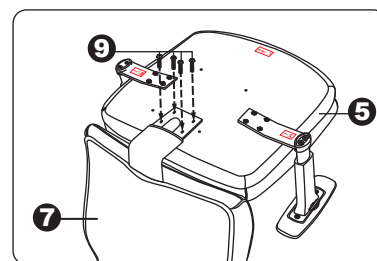
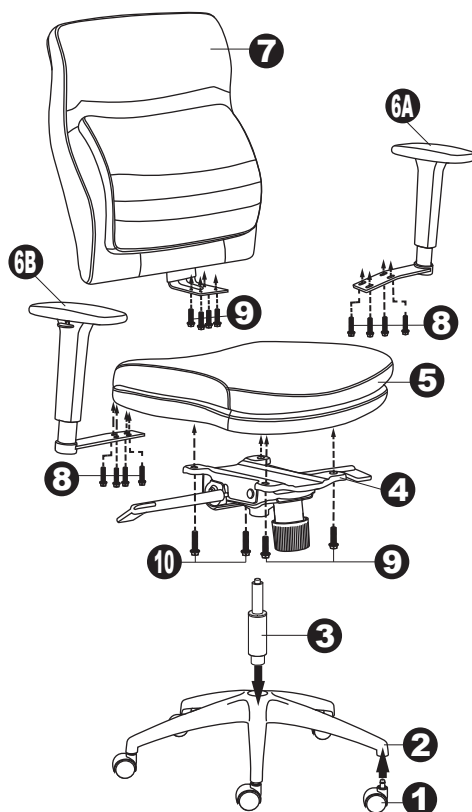

Diagram 1

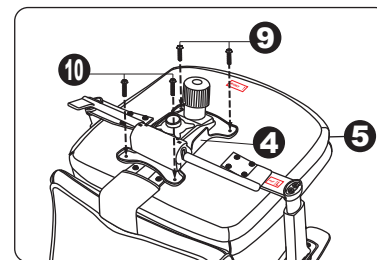

Diagram 2

INSTRUCTIONS

- Remove all parts from the carton and separate them into part number groups as indicated in the parts list.
- To begin assembly, place 5-star base (2) upside down and insert casters (1) into the bottom of base (2).
- Turn the base (2) right side up on the floor and insert the cylinder (3) into the center hole on the base (2).
- Tighten the brackets of arms (6A & 6B) onto the bottom of the seat cushion (5) (with front of arms facing the front of seat cushion) by using 1" small screws (8). **Tighten the screws completely.**
- Align the back support plate on the back cushion (7) with the seat cushion (5) as shown in Diagram 1, and insert 1¼" big screws (9). **Securely tighten the screws with enclosed hexagonal wrench (11).**
- Attach the seat plate (4) to the bottom of the seat cushion (5) (with front of seat plate facing the front of the seat cushion) as shown in Diagram 2. Attach by using 1¼" big screws (9) for the front holes of the seat plate (4) and 1½" big screws (10) for the rear holes of the seat plate (4) and **tighten screws.**
- Place the assembled chair on top of the cylinder (3) and press down until fully engaged.
- Periodically (every 90 days) make sure that the screws are still fully tightened.

CUSTOMER SERVICE HOTLINE
800-626-6060

ATTENTION:
Make certain to fully tighten all screws
before using chair.

**WE SUGGEST TAPING THE WRENCH
UNDER THE SEAT FOR FUTURE USE.**

OPERATING FEATURES

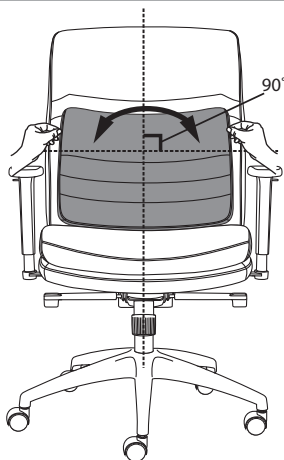
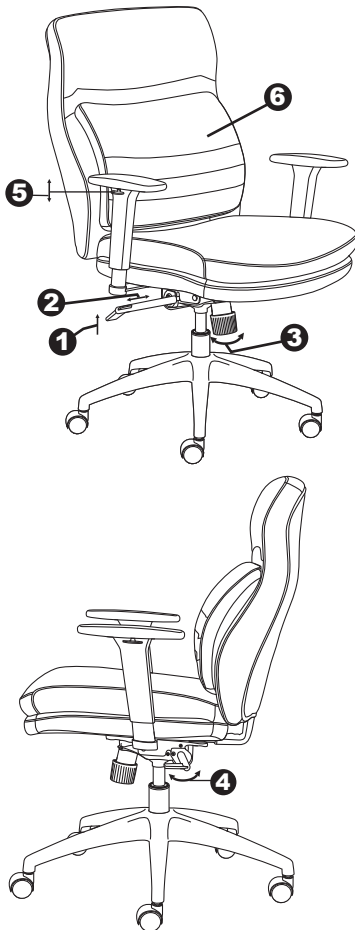

Due to flexible lumbar design, it may shift slightly during shipping. Please note that this is normal. After assembly you may need to manually adjust the lumbar to its centered position with a slight upward or downward tug.

1. TO ADJUST SEAT HEIGHT:

While seated, lean forward and reach under the right side of the chair to find the handle. Lift the handle and raise your body up slightly to allow the chair to rise to the desired height. Once desired height is reached, release handle to lock chair at desired height. To lower the seat, lift the handle while seated. The chair will descend until the handle is released or the chair reaches the bottom position.

2. TO OPERATE BACKWARD TILT LOCKOUT:

While seated, reach under the right side of the chair to find the height-adjustment handle. Pull the handle all the way out (away from the gas lift) to allow the chair to tilt backwards. To lock the chair in the upright or vertical position, sit upright and push the handle in towards the gas lift.

3. TO ADJUST TENSION ON THE TILT:

Reach under the front center of the chair, grasp the round knob and turn counterclockwise to make the tilt mechanism firmer (stiffer). To make the tilt mechanism less firm, turn the knob clockwise until the desired resistance is found.

4. TO OPERATE FORWARD TILT LOCKOUT:

To activate the forward tilt lockout, find the handle under the left side of the chair while seated. Push the handle backward while applying weight to the seat cushion to allow the seat to tilt forward for a more ergonomic position. To return to the original position, push the handle forward while applying weight to the seat cushion.

5. TO ADJUST ARM HEIGHT:

Pull up the buttons and hold to allow the arms to move up and down freely and then release the button once the desired height is reached.

6. ABOUT THE AIR CUSHION:

While seated, the open-air contours of the cushion which is designed to breathe and flex, can dynamically provide continuous support by connecting with your body's natural movement. The air cushion conforms to the curve of your spinal cord and is intended to relieve your back from stress. The Air™ chair has been shown to help the user achieve Neutral Posture. Neutral Posture has been shown to reduce back strain and increase long term seated comfort.

- 1). Provides constant support as you lean back and twist
- 2). Flexible lumbar pivots and conforms following your movement
- 3). Continuous proper lumbar support helps keep the body in an optimal working position

Note: It is not intended to diagnose, treat, cure or prevent any disease. If pain increases, please discontinue use.

WARNINGS

1. This product should be used by only one person at a time.
2. Do not use this chair unless all bolts, screws and knobs are securely tightened.
3. **Save the hexagonal wrench.** Check that all bolts, screws and knobs are tight every three months or as needed.
4. Dispose of packing material properly. Do not use the plastic cover as a head covering. It may cause suffocation.
5. Do not use the chair as a stepladder.
6. To clean the product, use only a clean cloth. The use of chemicals or cleaning products may affect the color fastness.
7. Use this chair for its intended purpose only.
8. The casters sold with this chair are intended for use on carpet and not recommended for use on tile or hard wood floors. Using these casters on tile or wood flooring may cause floor surface damage, so please consider purchasing a chairmat to protect your floor surfaces.