

**Congratulations on the purchase of your new *Signature Series* product!**

## COMPONENTS

(A) Top - 2 Pieces

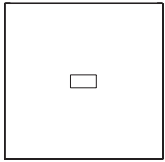

(B) Leg - 2 Pieces

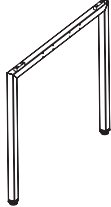

(C) Center Leg - 1 Piece

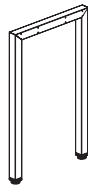

(D) Support Bar - 4 Pieces



(E) Support Bar Base - 8 Pieces

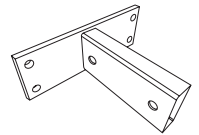

(F) Support Bar - 2 Pieces



## HARDWARE & TOOLS

(G) Allen Key 4mm - 1 Piece

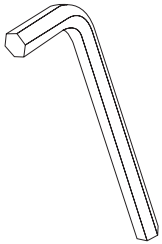

(H) Screw 70mm - 13 Pieces

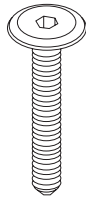

(I) Screw 15mm - 13 Pieces



(K) Screw 40mm 9 Pieces



(J) Union Plate - 2 Pieces



(L) Wrench Allen 4mm - 1 Piece

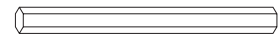

## INSTRUCTIONS

### STEP 1

Attach the Support Bar Base (E) to the Legs (B) and the Center Leg (C) using Screws (I).

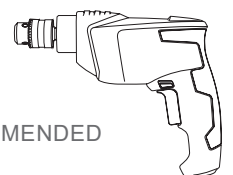
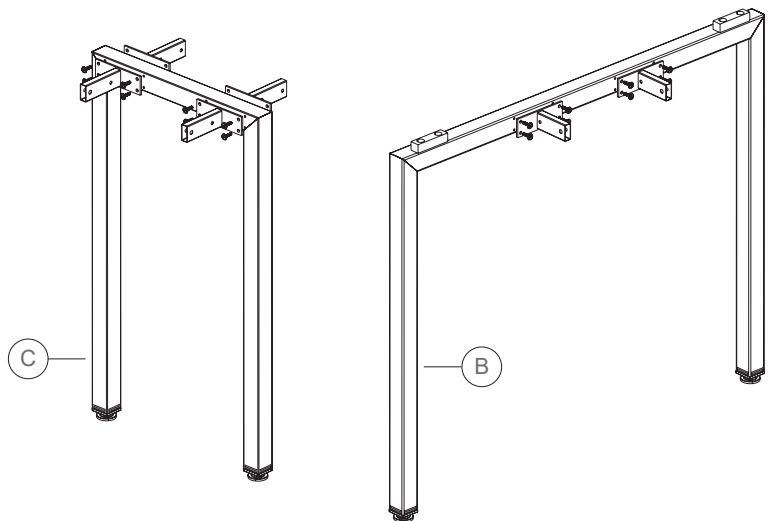
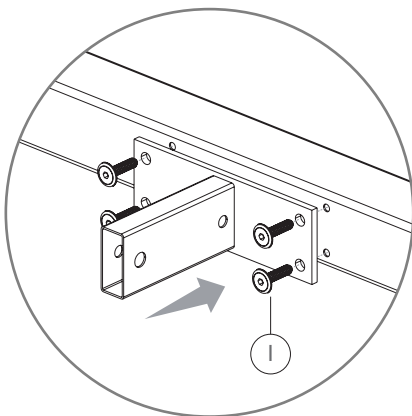

DRILL RECOMMENDED

**Congratulations on the purchase of your new *Signature Series* product!**

INSTRUCTIONS

STEP 2

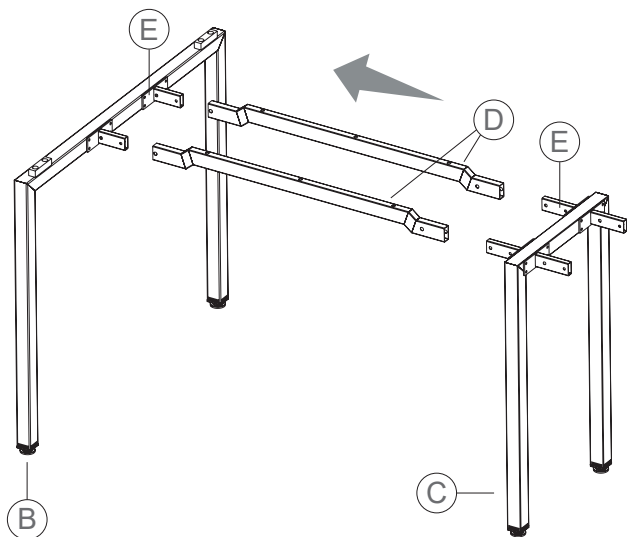

Slide Support Bars (D) into the Assembled Legs from the previous step

STEP 3

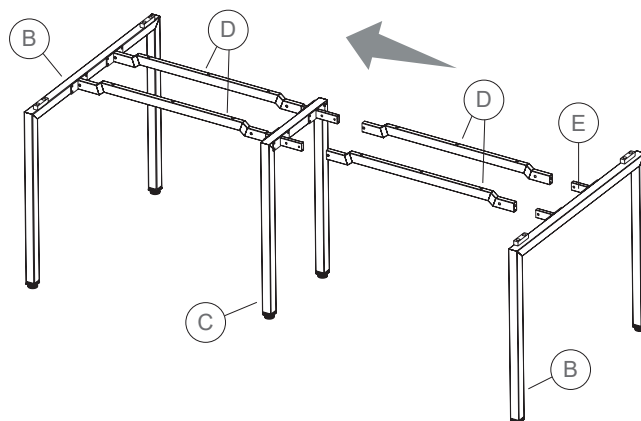

Repeat with remaining Support Bars (D) and Side Assembly.

**Congratulations on the purchase of your new *Signature Series* product!**

INSTRUCTIONS

STEP 4

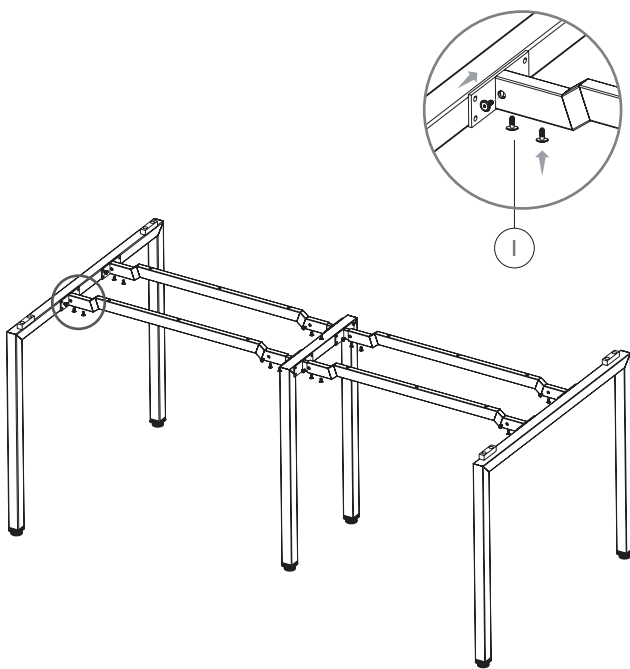

Secure the structure with the screws (I) using the Allen Key (G) .

STEP 5

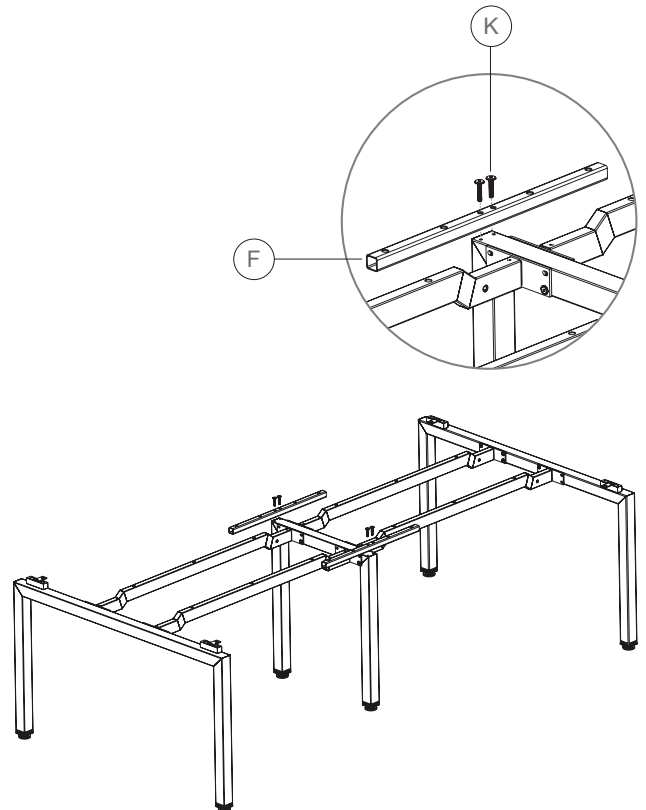

Put on the structure the support bar (F) and fasten with the screws (K) .

**Congratulations on the purchase of your new *Signature Series* product!**

INSTRUCTIONS

STEP 6

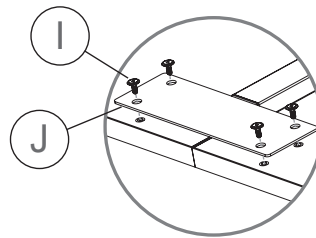

**\*Note:** Use Union Plates (J) and Screws (I) to join tops together.

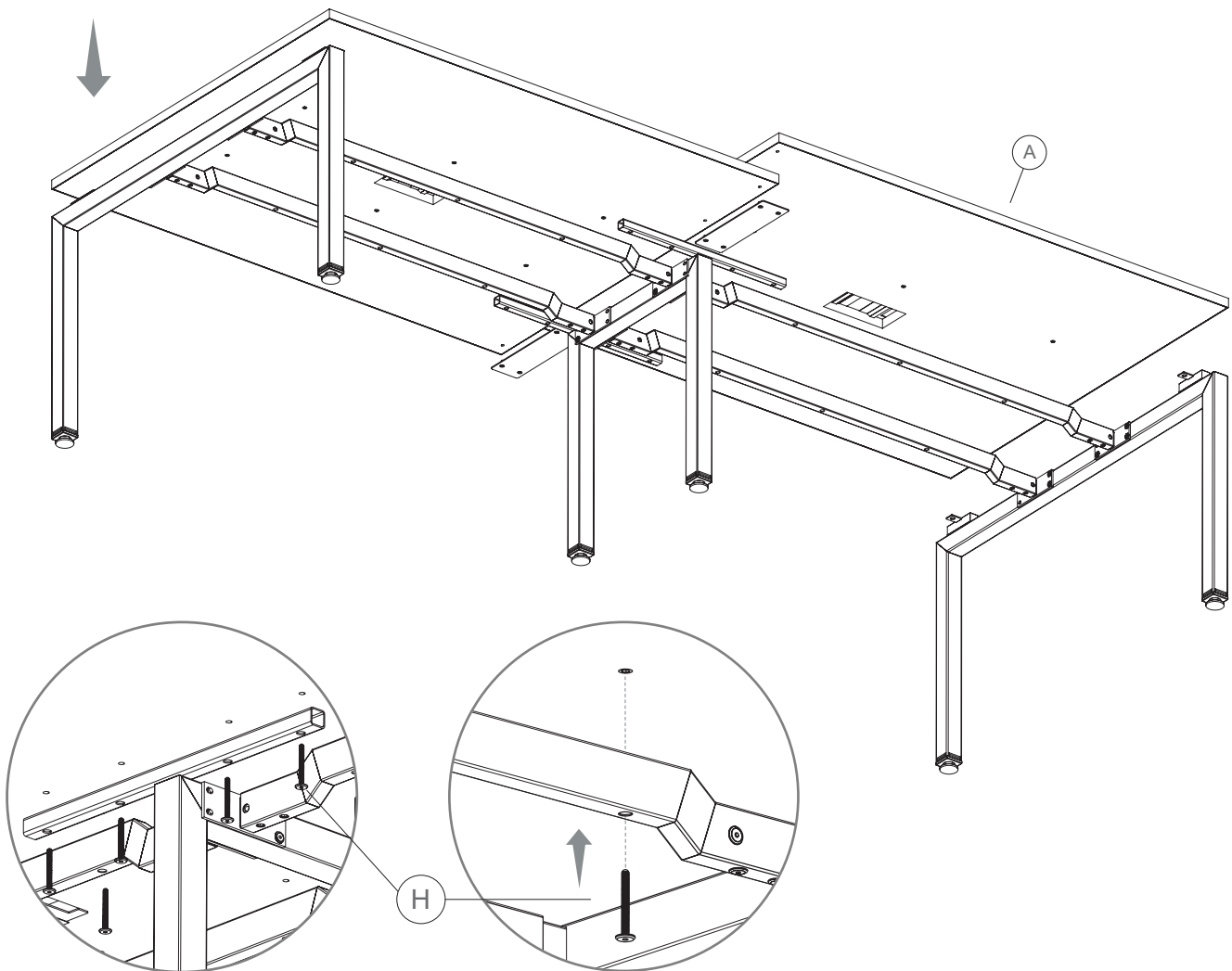

Place Tops (A) on Base Assembly and align holes in base with inserts in Tops (A). Secure the Tops (A) with Screws (H) using Allen Key (G).