



ELECTRIC HEIGHT ADJUSTABLE L-SHAPE WORKSTATION ASSEMBLY INSTRUCTIONS

800-558-1010
www.NBF.com

Version Dated: 7/13/16
Read all the instructions before beginning.

CUSTOMER SERVICE HOTLINE
800-626-6060

TOOLS NEEDED FOR ASSEMBLY:

POWER DRIVER W/ADJUSTABLE TORQUE
#2 PHILLIPS HEAD DRIVER BIT
#2 SQUARE HEAD DRIVER BIT
3/16" HEX HEAD DRIVER BIT OR
ALLEN WRENCH
ADJUSTABLE WRENCH
TAPE MEASURE
LEVEL

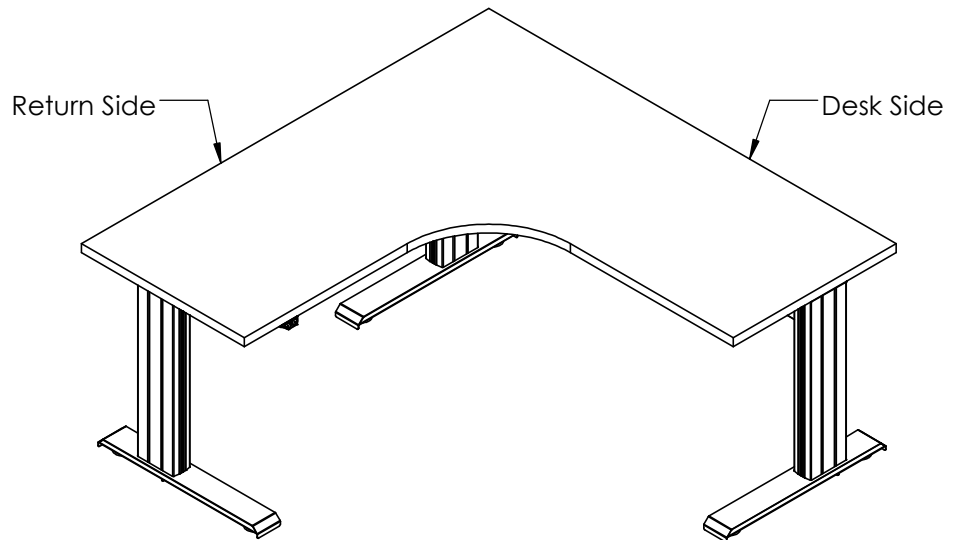

 Failure to comply with or observe all assembly, safety, and operation instructions and warnings regarding the use of this product may result in serious property damage or bodily injury.

Make sure no obstacles are in the desk's path and all cords are of appropriate length for the desk. Always maintain a 1" clearance around the table to prevent pinching.

Never assemble (or disassemble) the table or components with the table plugged into a power outlet. This product is for use on a nominal 120-volt circuit and has a grounding plug. Make sure that the product is connected to an outlet having the same configuration as the plug. No adapter should be used with this product.

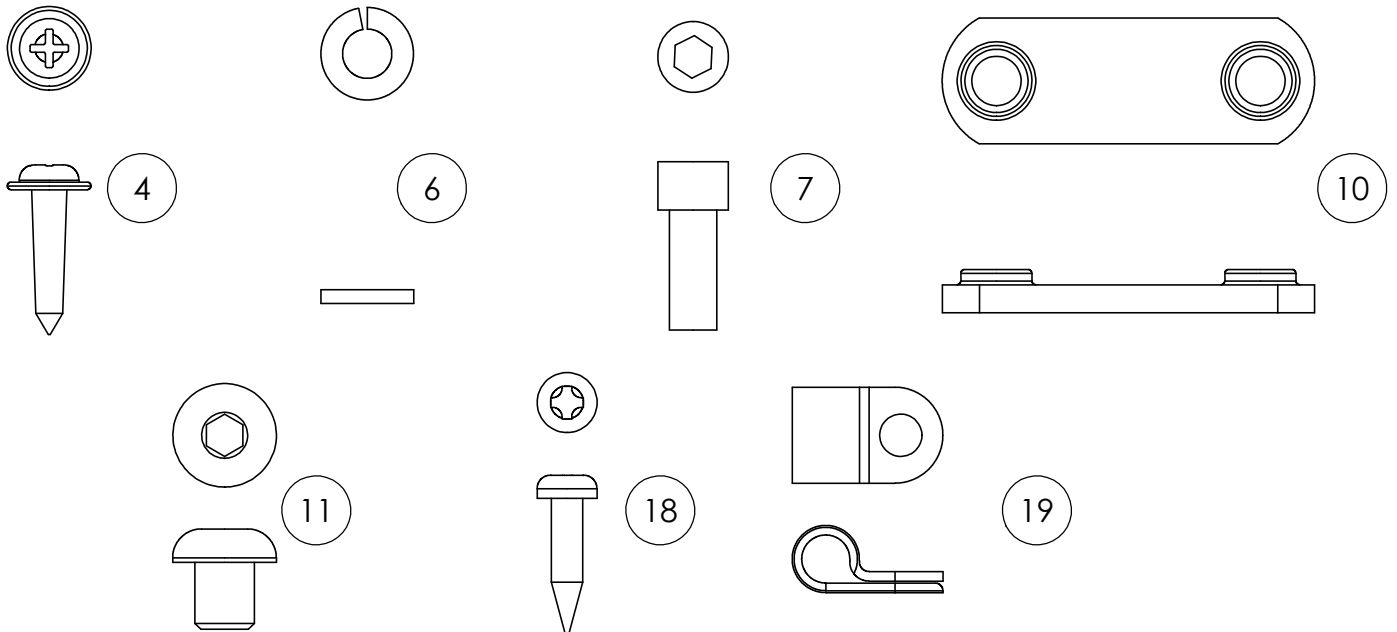

HARDWARE PACK # 53321-NBF DRAWN ACTUAL SIZE

WWW.NBF.COM

Instruction # 53233-NBF

800-558-1010

Page 1 OF 9



ELECTRIC HEIGHT ADJUSTABLE L-SHAPE WORKSTATION ASSEMBLY INSTRUCTIONS

800-558-1010
www.NBF.com

CUSTOMER SERVICE HOTLINE
800-626-6060

Your workstation will have two left legs (Leg A) and one right leg (Leg B). The drawing at the right shows how to distinguish the left leg A from the right leg B. Stickers on the bottom of the worksurface supports identify which leg assemblies will have motors attached.

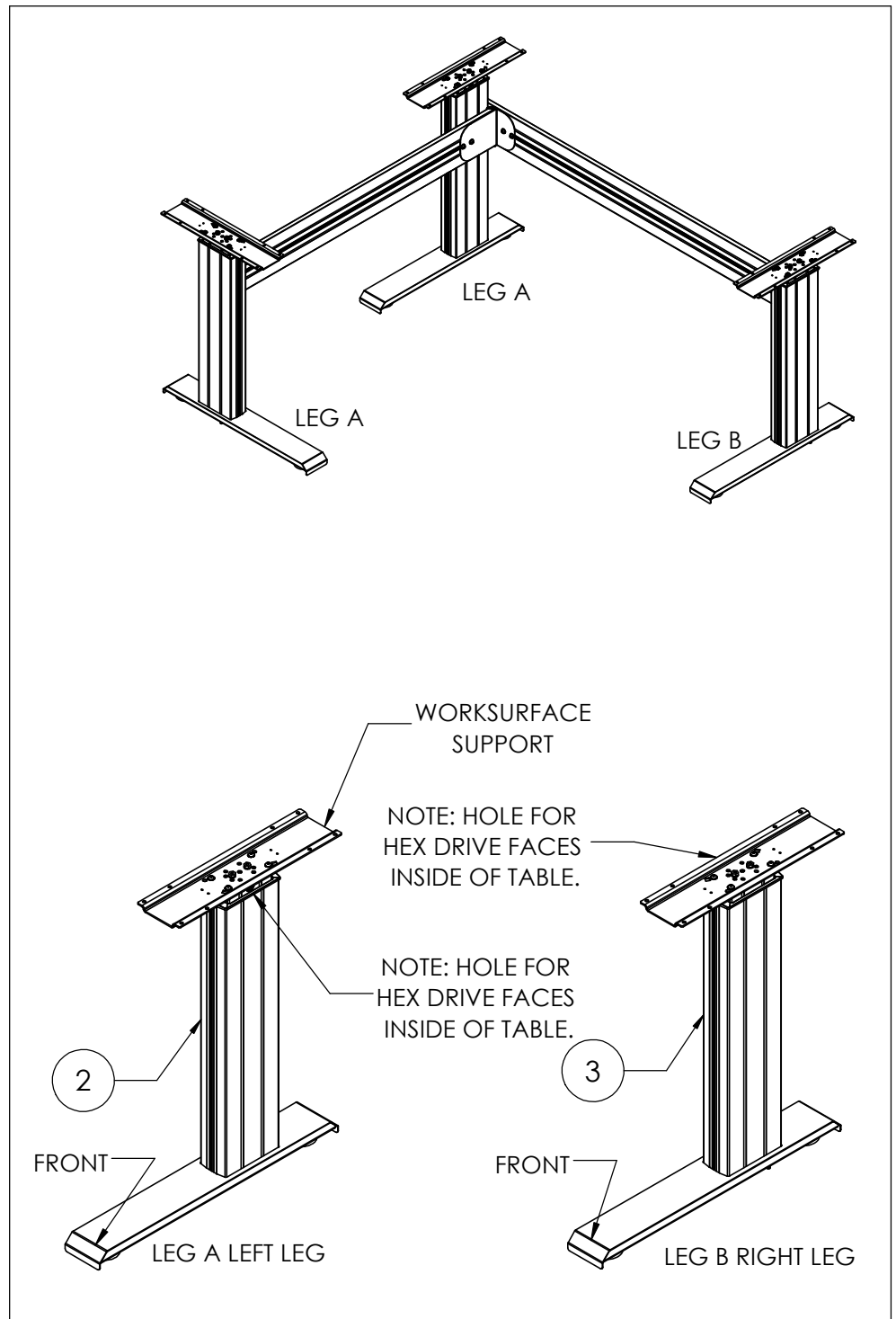



ELECTRIC HEIGHT ADJUSTABLE L-SHAPE WORKSTATION ASSEMBLY INSTRUCTIONS

800-558-1010
www.NBF.com

CUSTOMER SERVICE HOTLINE
800-626-6060

PARTS

ITEM	DESCRIPTION	QTY.
1	WORKSURFACE	1
2	LEFT LEG ASSY	2
3	RIGHT LEG ASSY	1
4	M5 x 18mm (7/8") Sq/Ph/Wshr Head Wood Screw	56
5	MOTOR & BRACKET ASSY	2
6	SPLIT LOCK WASHER	4
7	1/4-20 CAP SCREW	4
8	LONG HEX ROD	1
9	CROSS SUPPORT	2
10	WELD NUT	2
11	5/16" SOCKET SCREW	10
12	END CAP	4
13	SHORT HEX ROD	1
14	SUPPORT L-BRACKET	1
15	U-CHANNEL	2
16	CONTROL BOX	1
17	UP/DOWN SWITCH	1
18	3/4" RECEX SCREW	1
19	CABLE CLAMP	1
20	WIRE MANAGEMENT J	1

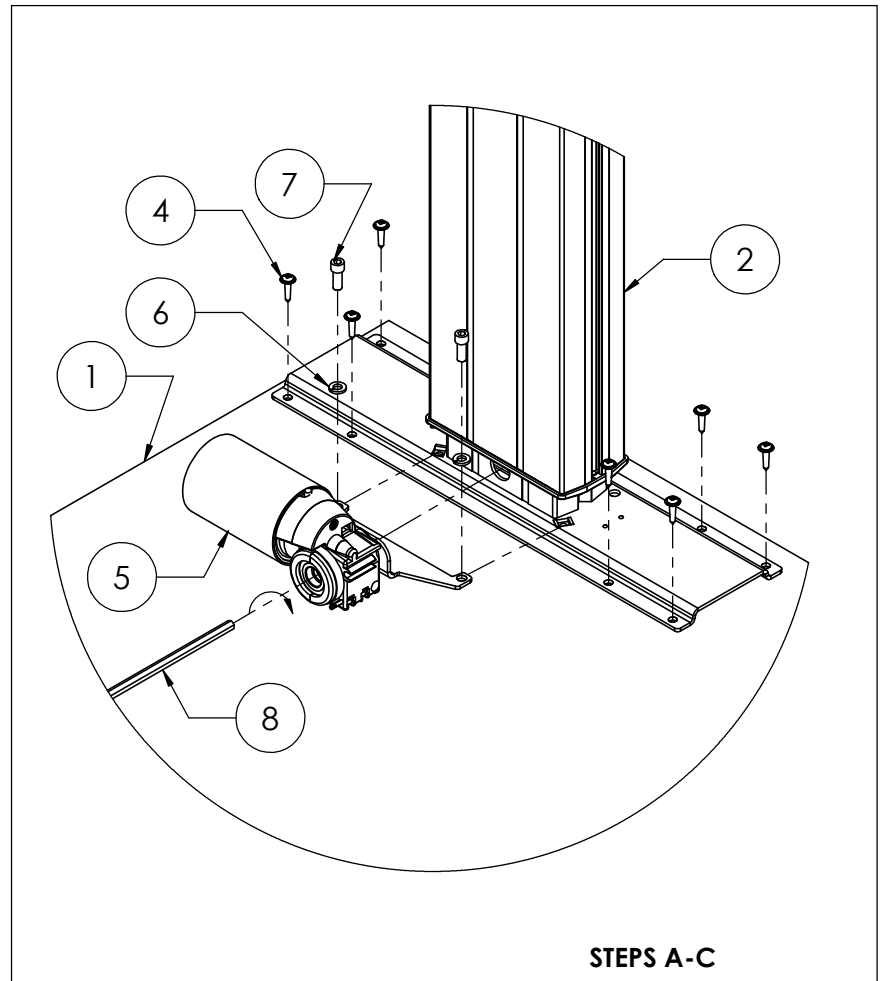

Step A: Lay the worksurface (1) on a protected surface with the pilot holes facing up. Place one of the left leg assemblies (2) on the worksurface aligning the holes in the worksurface support with the pilot holes in the worksurface. Attach the leg assembly to the worksurface with eight wood screws (4). Leave the wood screws loose by about 1/8" until the cross supports (9) are installed.

Step B: Insert the long hex rod (8) through the motor assembly (5) and into the hex drive near the top of the leg assembly. You may need to turn the hex rod clockwise slightly with an adjustable wrench to align the hex rod with the hex drive.

Step C: Place two split lock washers (6) onto two 1/4-20 cap screws (7). Insert these through the motor bracket and thread them into the cage nuts pre-installed in the worksurface support. Hand tighten. Fully tighten after the legs can be raised. See Step R.

ELECTRIC HEIGHT ADJUSTABLE L-SHAPE WORKSTATION ASSEMBLY INSTRUCTIONS

800-558-1010
www.NBF.com

CUSTOMER SERVICE HOTLINE
800-626-6060

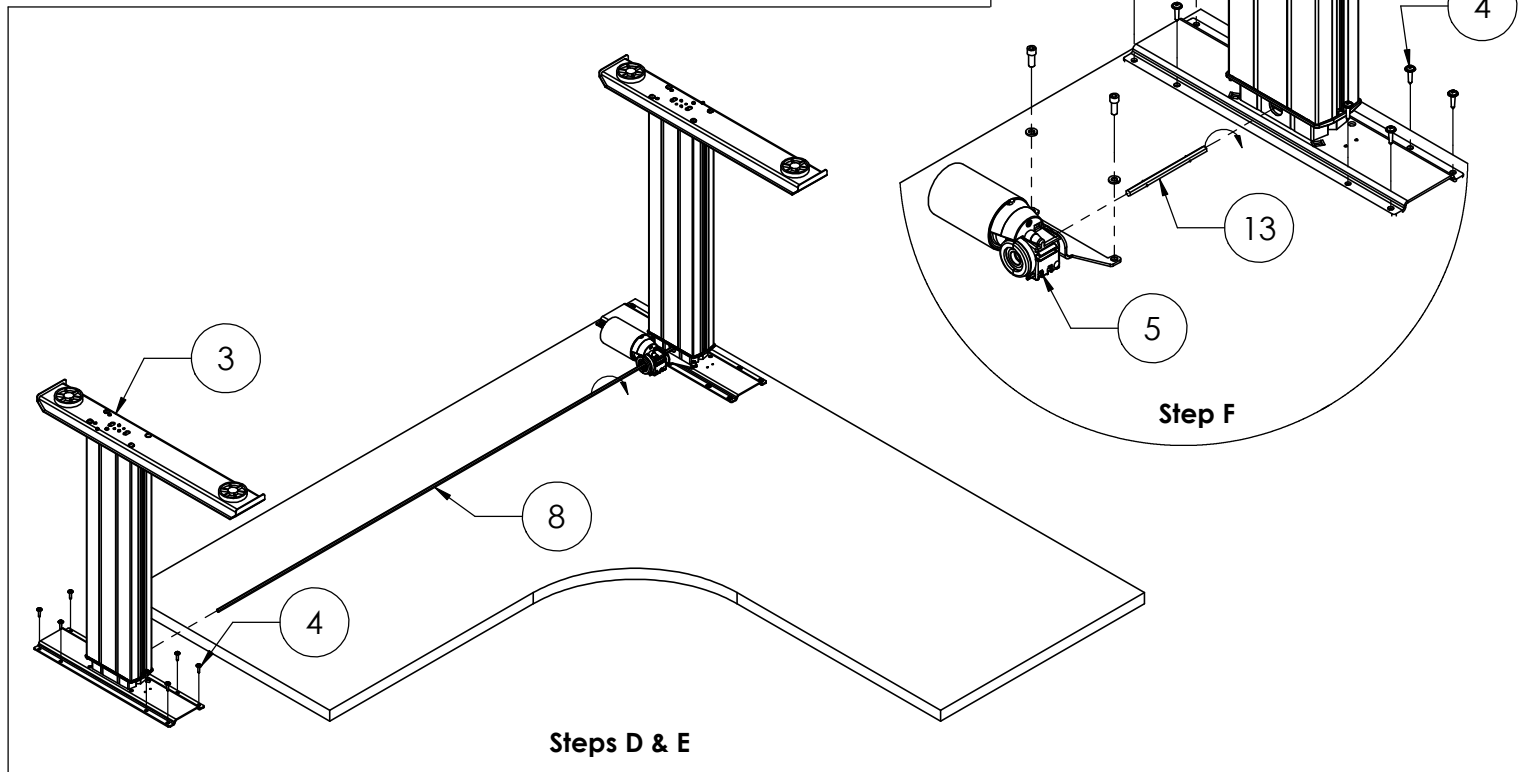

Step D: Place the right leg assembly (3) on the worksurface. Insert the end of the hex rod into the hex drive near the top of the leg assembly. You may need to turn the hex rod clockwise slightly with an adjustable wrench to align it with the drive. Do not turn it more than one sixth of a turn or the worksurface will not be level.

Step E: Once the hex rod is engaged in the drive, align the holes in the worksurface support with the pilot holes in the worksurface. Attach the right leg assembly with eight wood screws. Leave the screws loose by about 1/8" until after the cross supports are installed. See Step Q.

Step F: Insert the short hex rod (13) into the hex drive on the remaining motor assembly (5). There is a stop bead on the hex rod about 1-1/2" from the end. This is the end that goes into the motor hex drive. Insert the other end of the hex rod into the hex drive near the top of the third leg assembly. Attach the motor and bracket assembly to the third leg worksurface support as you did in Steps A-C. Hand tighten. Fully tighten after the legs can be raised. See Step R. Attach the third leg with eight wood screws. Leave the screws loose by about 1/8" until after the cross supports are installed.



ELECTRIC HEIGHT ADJUSTABLE L-SHAPE WORKSTATION ASSEMBLY INSTRUCTIONS

800-558-1010
www.NBF.com

CUSTOMER SERVICE HOTLINE
800-626-6060

Step G: There are two cross supports with this workstation. The one used in this step will be 5" shorter than the desk side of the worksurface. With the help of an assistant, align the cross support **(9)** with the stickers on both leg assemblies. See below. Insert four socket screws **(11)** through the holes in the ends of the cross support and thread them into the weld nuts that are held in place by the stickers. Do not fully tighten. Check that the cross support is level and parallel with the worksurface. Fully tighten the socket screws.

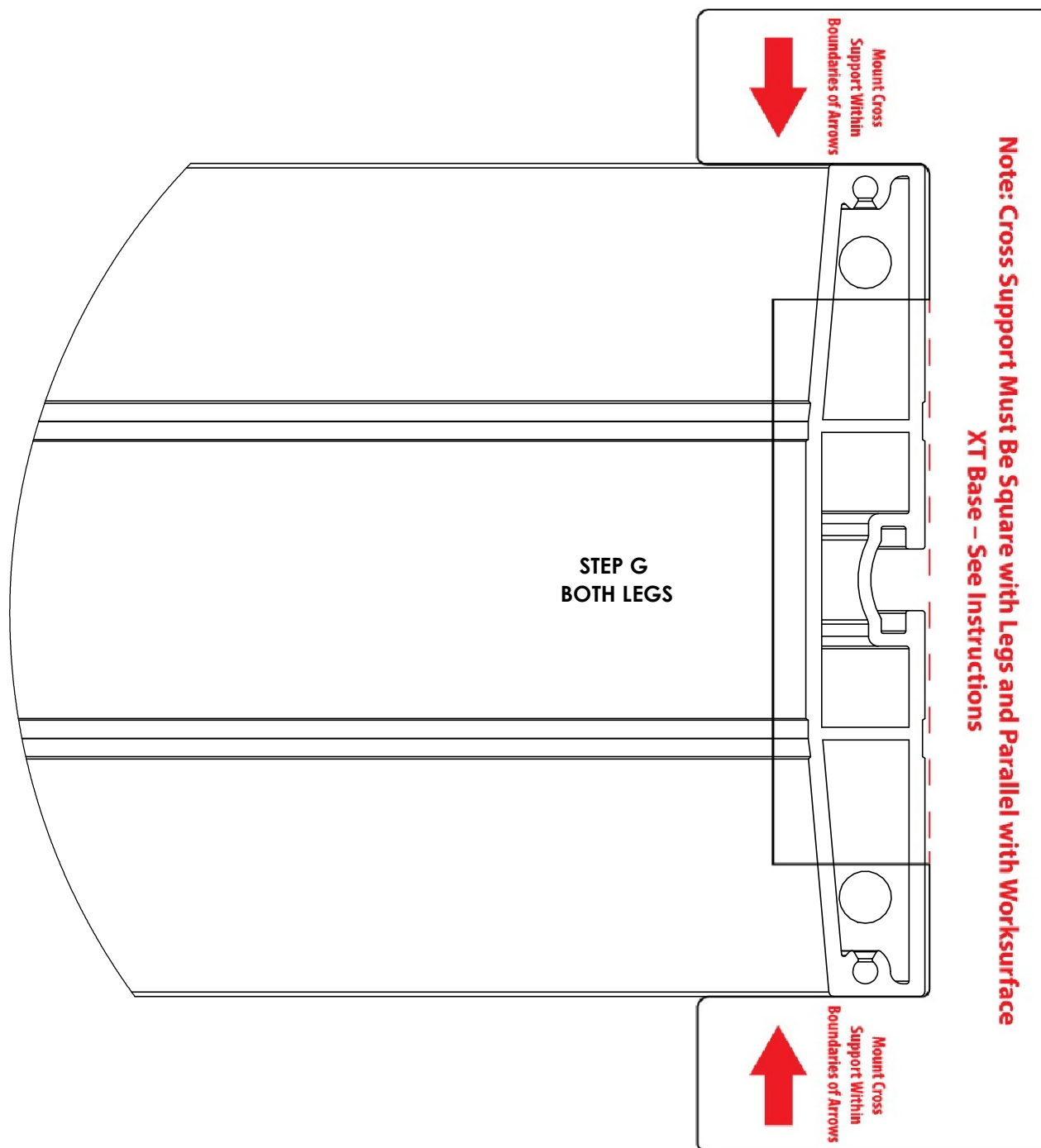



ELECTRIC HEIGHT ADJUSTABLE L-SHAPE WORKSTATION ASSEMBLY INSTRUCTIONS

800-558-1010
www.NBF.com

CUSTOMER SERVICE HOTLINE
800-626-6060

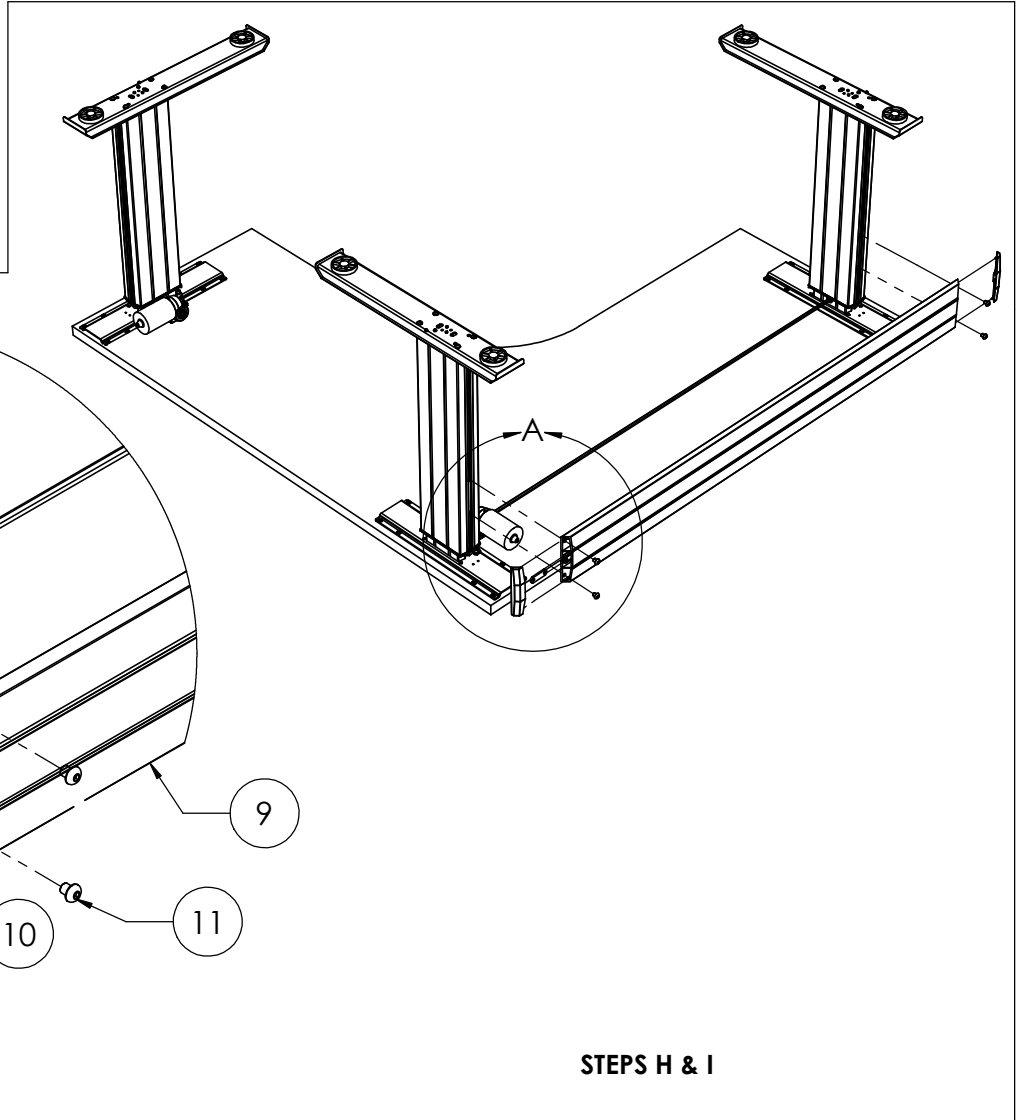

Step H: Slide a weld nut (10) into the groove on the front of the cross support. The projections on the weld nut must face out.

Step I: Insert two end caps (12) into the ends of the cross support.



ELECTRIC HEIGHT ADJUSTABLE L-SHAPE WORKSTATION ASSEMBLY INSTRUCTIONS

800-558-1010
www.NBF.com

CUSTOMER SERVICE HOTLINE
800-626-6060

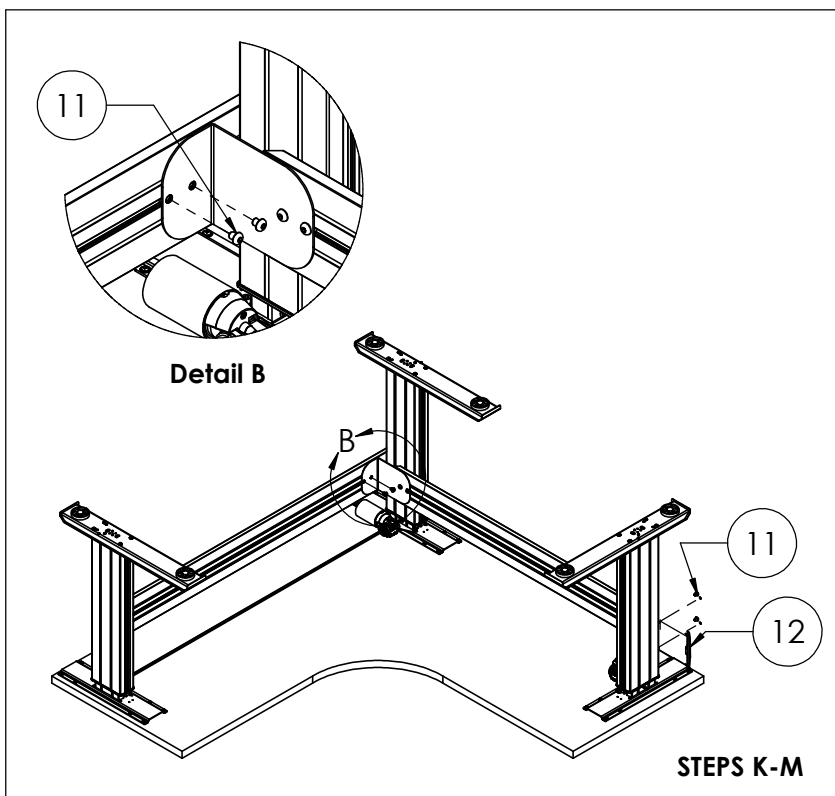
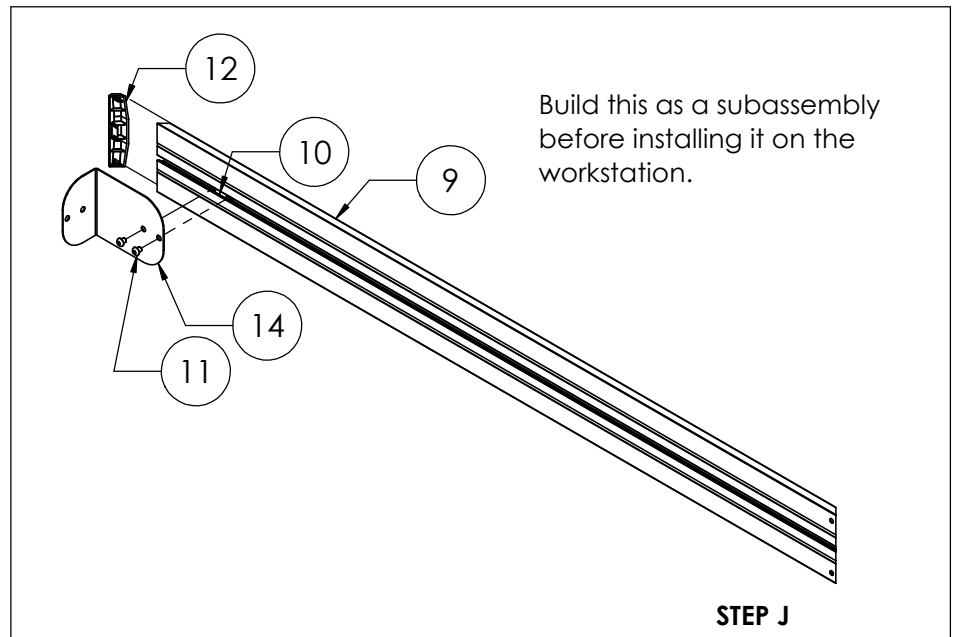

Step J: Build the subassembly shown above. Slide a weld nut (10) into the groove in the front of the remaining cross support. The projections on the weld nut must face out. Insert two socket screws through the holes in the wide side of the L-bracket (14). Thread these into the weld nut. Do not fully tighten. Insert an end cap (12) into the end of the cross support.

Step K: Insert two socket screws through the holes on the narrow side of the L-bracket. Thread these into the weld nut you installed in the first cross support.

Step L: Attach the other end of the cross support to the third leg assembly using two socket screws into the weld nut that is held in place by the sticker. Check that the cross support is level and parallel to the worksurface and at the same height as the first cross support. Fully tighten all the socket screws. Insert an end cap into the end of the cross support.

Step M: Fully tighten all the wood screws attaching the leg assemblies to the worksurface.

ELECTRIC HEIGHT ADJUSTABLE L-SHAPE WORKSTATION ASSEMBLY INSTRUCTIONS

800-558-1010
www.NBF.com

CUSTOMER SERVICE HOTLINE
800-626-6060

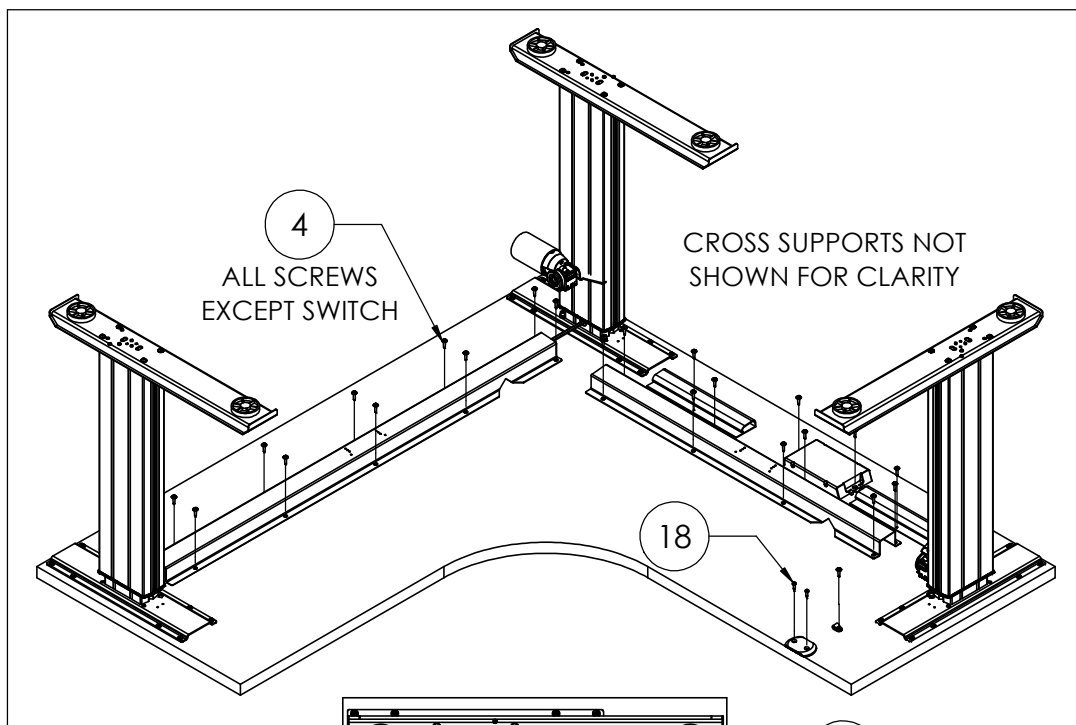

Step N: Align the holes in the control box (16) with the pilot holes in the worksurface and attach it with two wood screws.

Step O: Align the holes in the switch (17) with the pilot holes in the worksurface. Attach it with two rex screws (18). Capture the switch wire in the cable clamp (19) and attach it where shown. Attach two wire management J's (20) at the locations shown with one wood screw in each.

Step P: Align the holes in the u-channels (18) with the pilot holes in the worksurface and attach it with eight to ten wood screws in each.

Step Q: Run the wires through the wire management to the control box and plug them in as shown below. Place excess wire in the wire management. Set the workstation upright in its final location. Level the unit if required by turning the leveling glides clockwise (from the top) on the low corners of the table.

Step R: Plug the power cord into the control box and into a standard 110 volt receptacle. A power surge protector is recommended. Press the down arrow on the switch until the table bottoms out. Push the up arrow until you have access to the motor screws. Fully tighten the four motor screws.

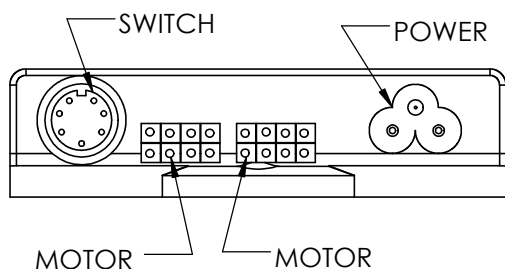

CONTROL BOX WIRING

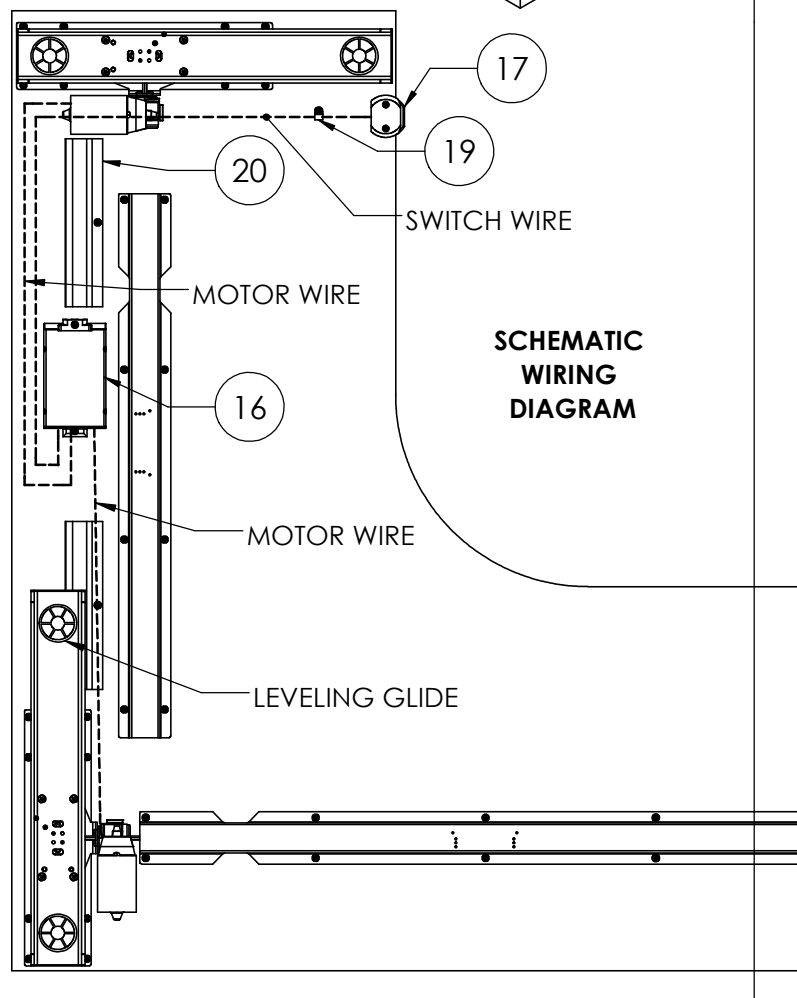

SCHEMATIC
WIRING
DIAGRAM



ELECTRIC HEIGHT ADJUSTABLE L-SHAPE WORKSTATION ASSEMBLY INSTRUCTIONS

800-558-1010
www.NBF.com

CUSTOMER SERVICE HOTLINE
800-626-6060

Operation and Reset Procedure: If you unplug or lose power and the table does not operate, follow the procedure below. Unplug the power for thirty seconds and plug back in. Hold the down arrow until the unit reaches its lowest point. The control box is in reset mode. The workstation is ready for use.

If the workstation leg assemblies are at uneven heights, it is usually caused by an improperly installed hex rod. Disassemble one of the legs that point in the same direction from the worksurface and make sure both ends of the hex rod are properly engaged in the hex drives near the top of the leg assemblies.

INSTRUCTIONS TO INSTALL A TRACK ON THIS WORKSTATION:

- Step 1:** Place the front of the track **(B)** against the bottom of the worksurface and the back of the track on the angled part of the u-channel **(A)** .
- Step 2:** Align the holes in the track with one of the sets of pilot holes in the u-channel keeping the front of the track 1/8" to 5/8" from the front of the worksurface. Place two washers **(C)** on two self drilling screws **(D)** . Drive them through the track and into the u-channel.
- Step 3:** Attach the front of the track to the worksurface with two wood screws **(E)** . Complete the track installation using the instructions that came with the product you are installing.

PARTS

PART	DESCRIPTION	QTY.
A	U-Channel	1
B	TRACK	1
C	ALUMINUM WASHER	2
D	SELF DRILLING SCREW	2
E	WOOD SCREW	2

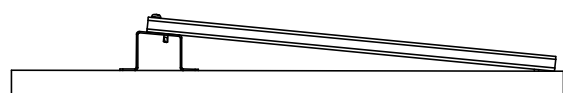

SIDE VIEW
Track will be at
an angle when
installation
is finished.

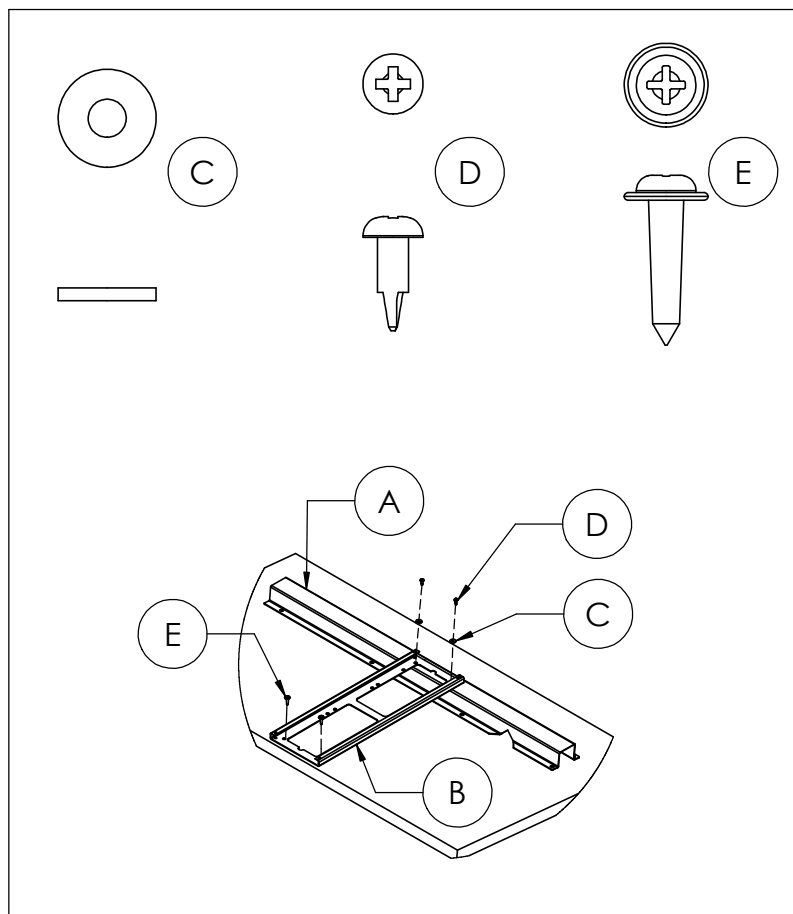

WWW.NBF.COM
800-558-1010