

Floor Mounted Desk

CORTECH

You will need:



1x

Pencil
For Marking Floor And Wall

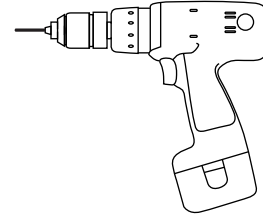

1x

Drill
With 3/8 Bit

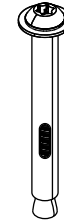

6x

3/8-16 x 3.75"
Security Torx Anchor Bolts

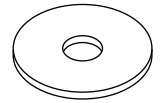

6x

Flat Washer

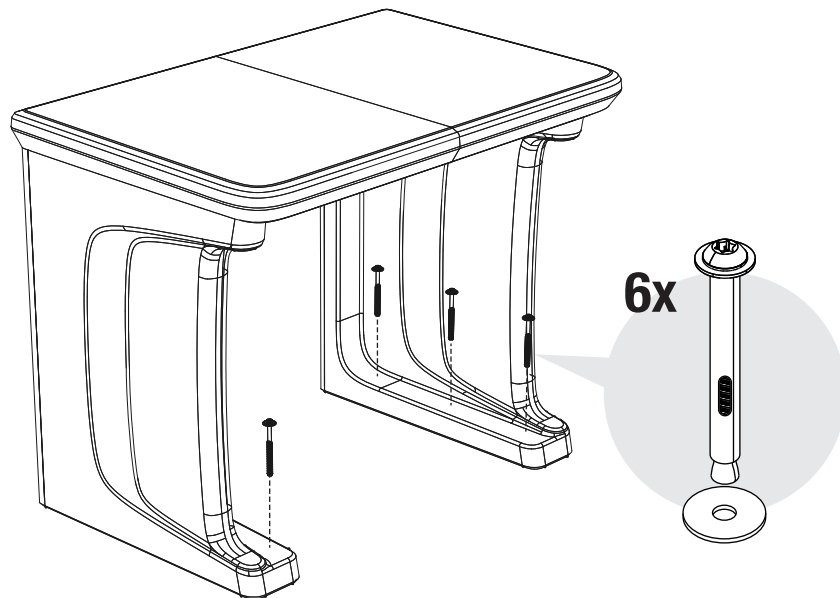
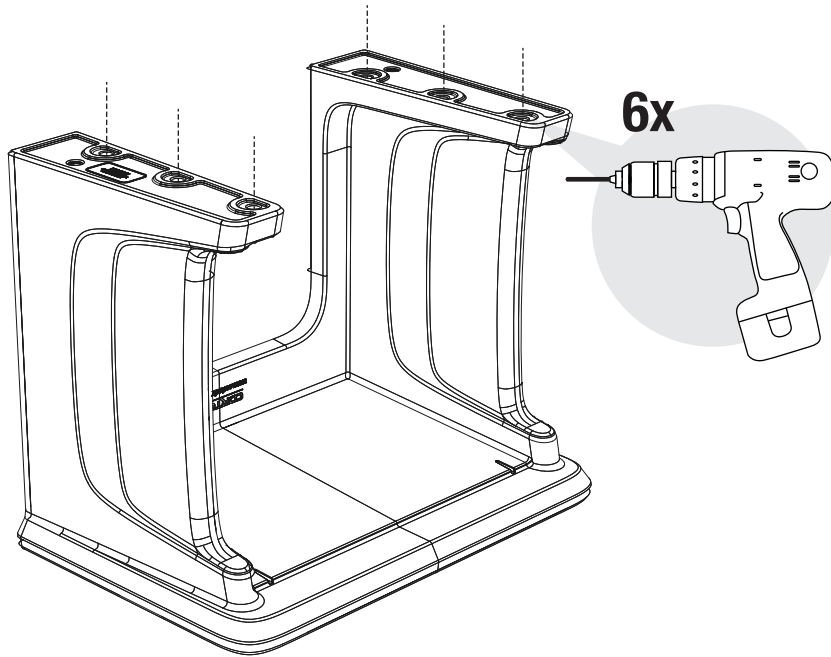

- 1.** Position desk on its top as to access the bottom of the desk.
- 2.** Select and drill all six mounting locations on the bottom of the desk.
- 3.** Place desk right side up and locate where it is to be secured to the floor.
- 4.** Using a pen or pencil, mark mounting hole locations on the floor using the holes drilled in step 2.
- 5.** Move desk and drill holes in the six locations where you marked the floor. Hole depth should be 2.0" deep MINIMUM.
- 6.** Replace the desk lining up the drilled holes with the holes in the floor.
- 7.** Place one flat washer over each of the six anchor bolt and guide the bolts through the desk and into the holes into the floor.
- 8.** Tighten each anchor bolt 3-5 turns past finger tight.