

Congratulations on the purchase of your new *Signature Series* product!

COMPONENTS

- (A) Desk TOP -1pc (B) Support Beam-1set (C) Lifting Leg - 2pcs (D) Foot - 2pcs (E) Bracket- 2pcs (F) Control Box- 1pc (G) Display- 1pc

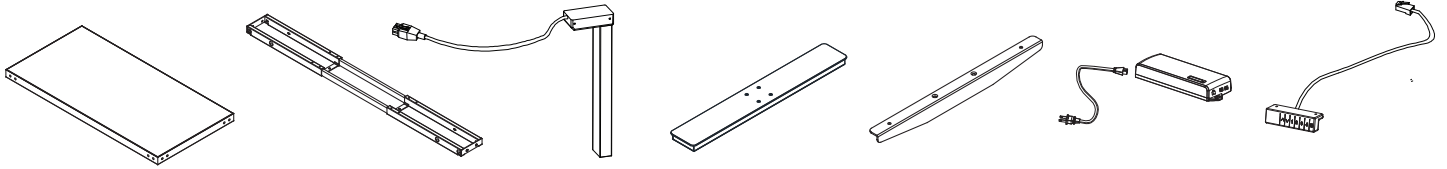

HARDWARE & TOOLS

- (H) Adjustable Glide - 4pcs (I) Screws M8*16mm - 8pcs (J) Screws M6*14mm - 8pcs (K) Screws M6*10mm - 4pcs (L) Screws M6*12mm - 8pcs (M) Rubber Cushion - 6pcs (N) Screws 3.5*19- 2pcs (O) Screws 4.8*19- 8pcs (P) Allen Key(4mm) - 1pc (Q) Allen Key(5mm) - 1pc
- Tools Required for Assembly**

Philips Screw Driver for Parts N and O

INSTRUCTIONS

STEP 1

Loosen the 4 screws of beam using Allen Key(4mm), adjust the beam to proper position to fit the Desk Top. (According to the predrilled holes on the TOP, see STEP 5)

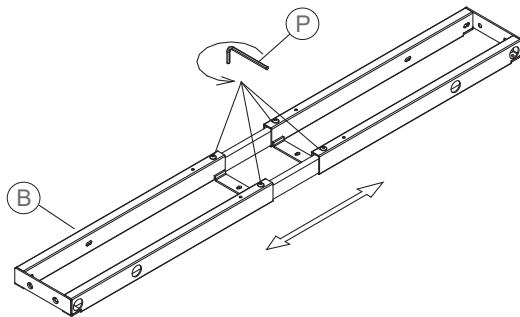

STEP 2

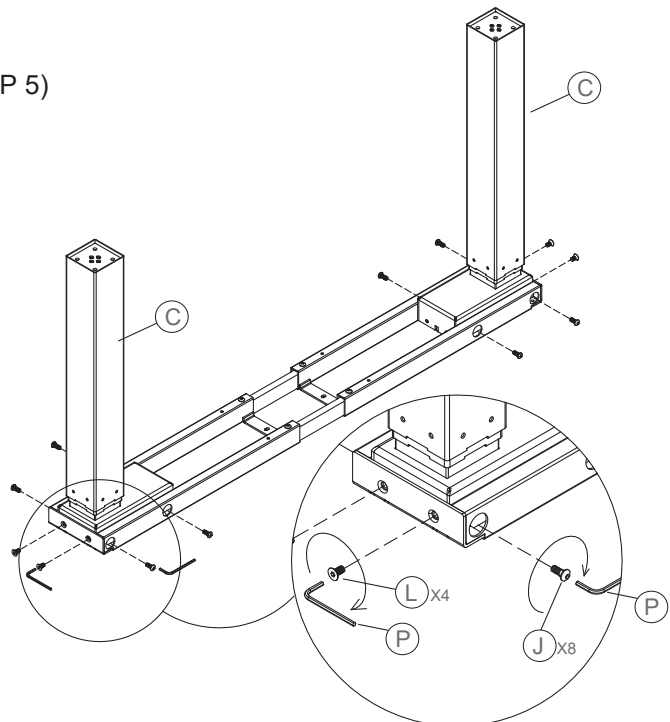

Congratulations on the purchase of your new *Signature Series* product!

INSTRUCTIONS

STEP 3

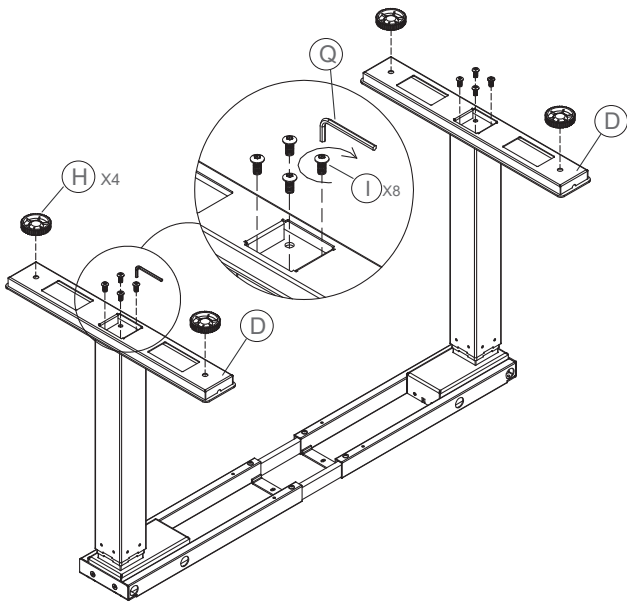

STEP 4

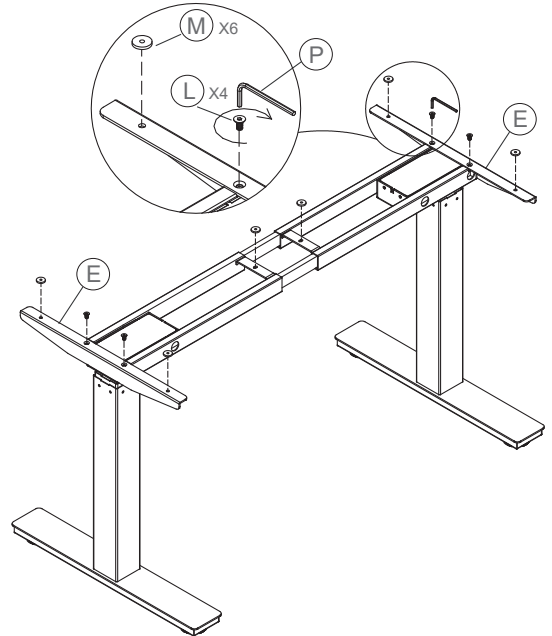

STEP 5

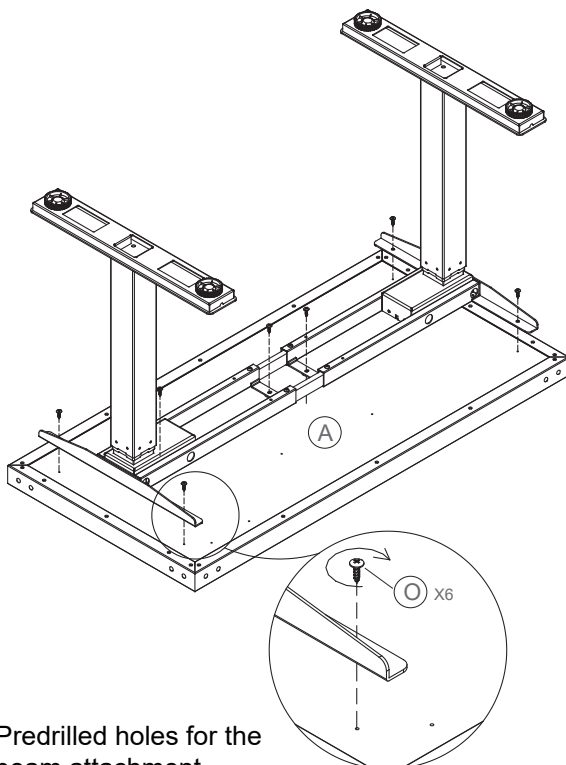

Predrilled holes for the beam attachment.

STEP 6

