

Congratulations on the purchase of your new *Signature Series* product!

COMPONENTS

Ⓐ Hutch-1pc

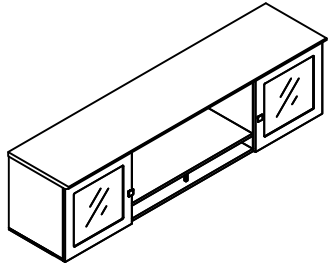

Ⓑ Wall Mounting Board-1pc

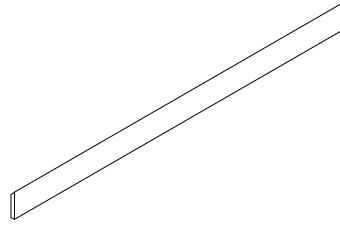

INSTRUCTIONS

STEP 1

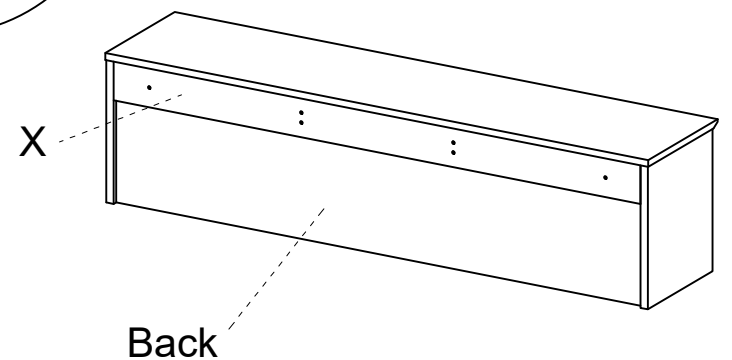
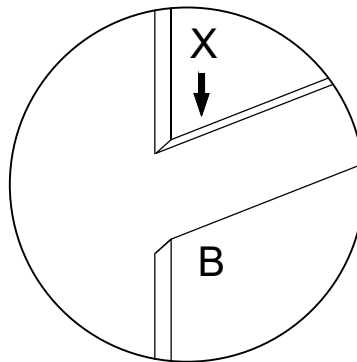
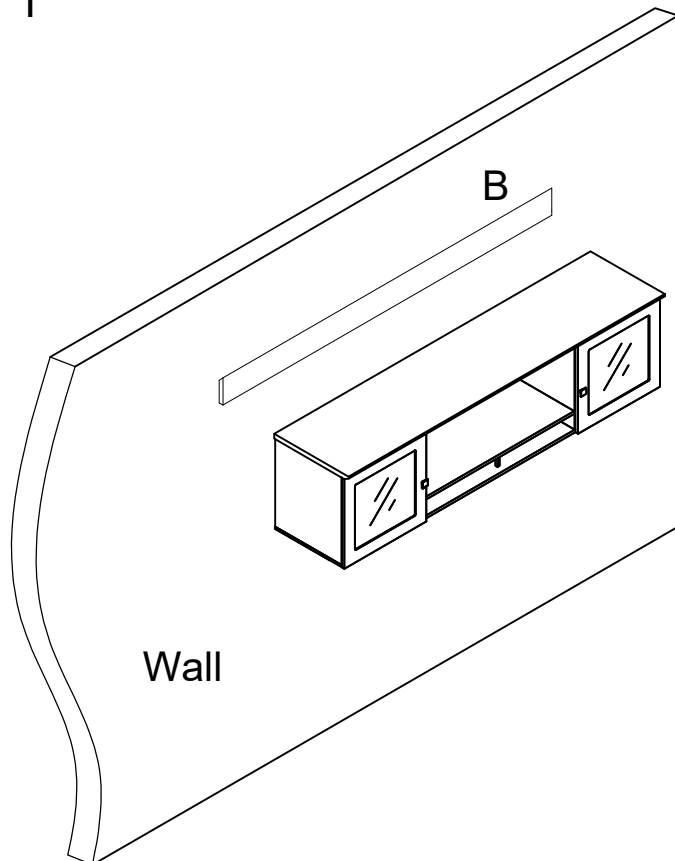

COMPLETED

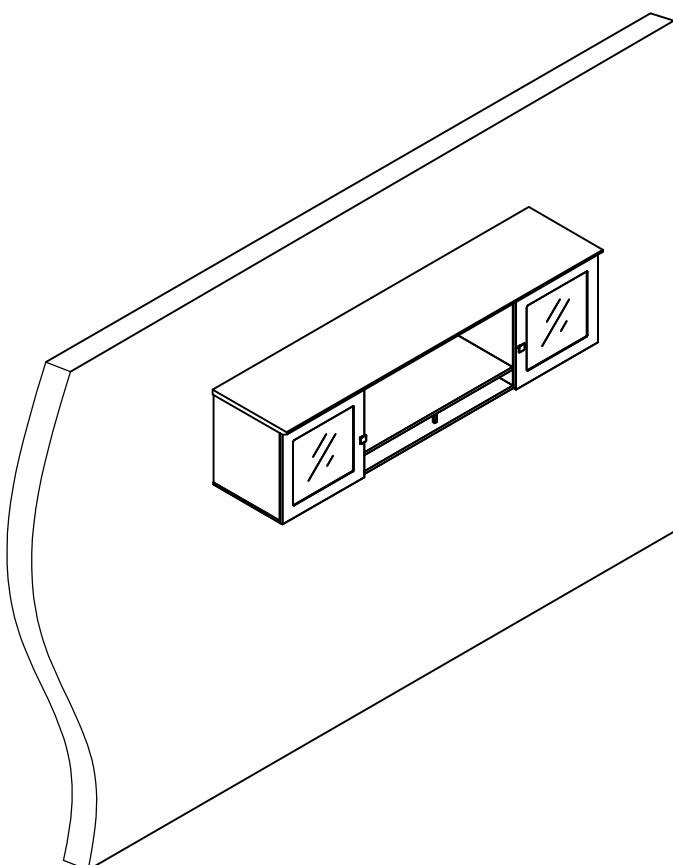

Mounting Board Installation - Due to the various wall construction methods, it is up to a professional installer to secure the Wall Mounting Board (B) to the wall with the proper fasteners and/or anchors as required by the wall construction at the desired mounting location.

To Hang Cabinet - Position cabinet so that Mounting Board (X) is above Wall Mounting Board (B) and lower cabinet until Mounting Board (X) and Wall Mounting Board (B) lock together.

Congratulations on the purchase of your new *Signature Series* product!

INSTRUCTIONS - To assemble when putting on Credenza

STEP 1

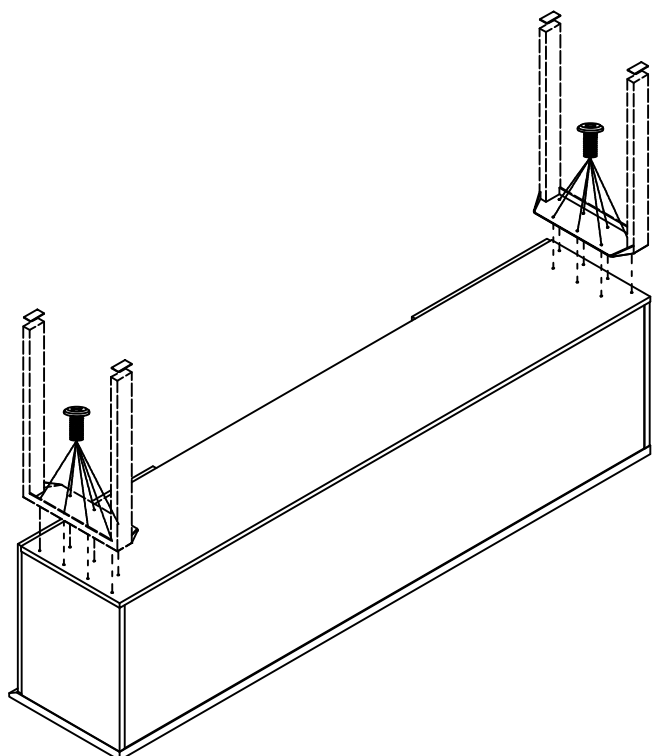

STEP 2

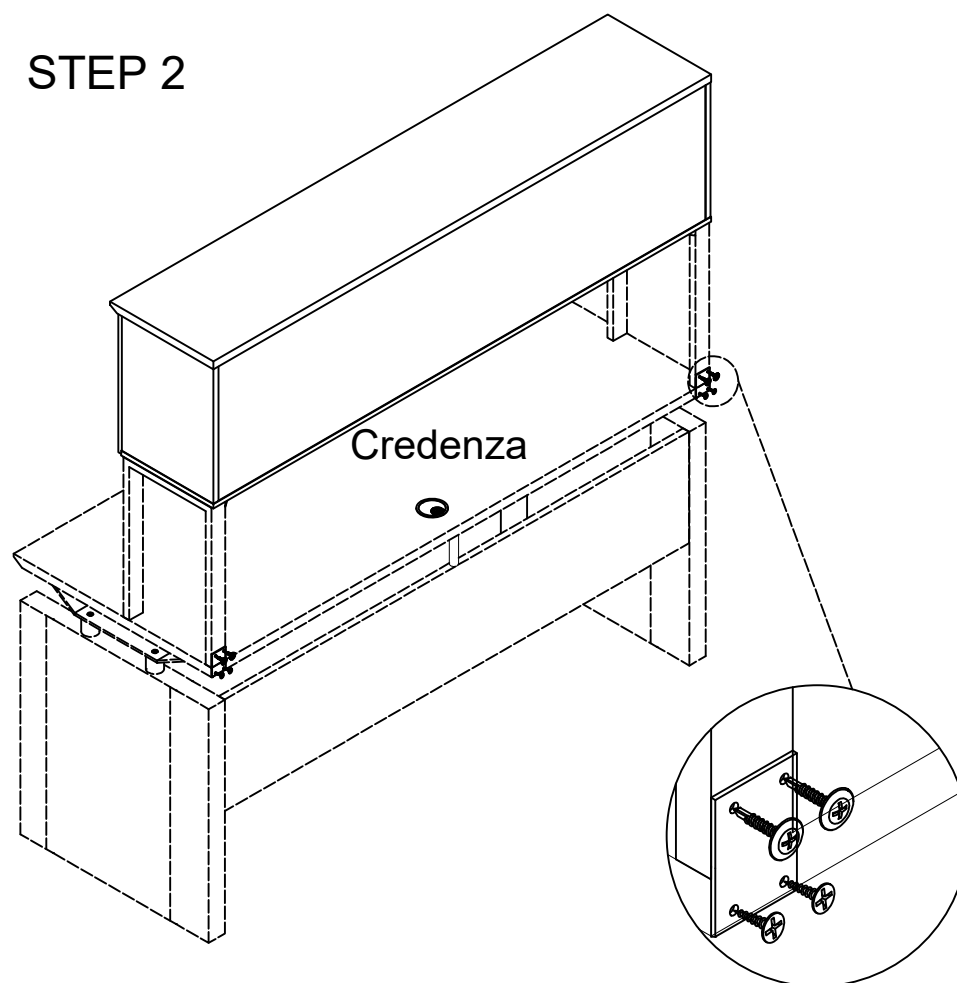

COMPLETED

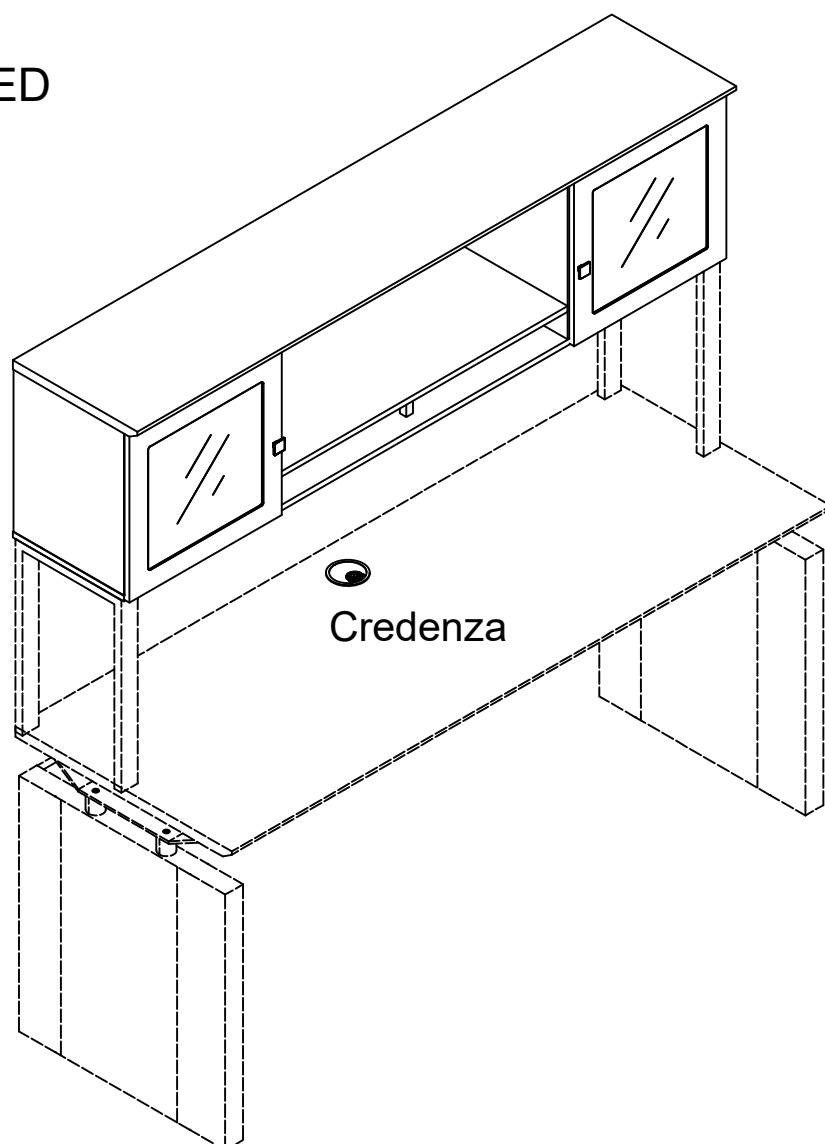

NOTE:
Hardware is packed with carton **ALHB**