

Congratulations on the purchase of your new *Signature Series* product!

COMPONENTS

IDT7230HA

(A) Top Panel-1pc

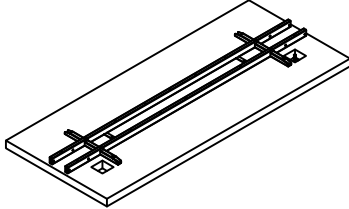

(B) Modesty Panel-1pc

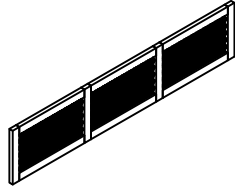

IDBHAB

(C) Left Base Leg-1pc

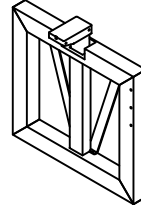

(D) Right Base Leg-1pc

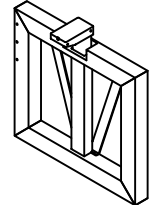

HARDWARE & TOOLS

(E) Cam Post-5pcs



(F) Wood Dowel
Ø8*30mm-3pcs



(G) Cam Lock-5pcs



(H) Screw
M6X15mm-5pcs



(I) Screw
Ø6X33mm-8pcs



(J) Cam Sticker-5pcs



(K) Mntg Bracket
50*30*2mm-2pcs

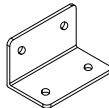

(L) Screw
Ø4X20mm-9pcs



(M) Allen Wrench 4mm-1pc



(N) Allen Wrench 5mm-1pc

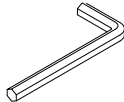

(P) Wire Management Tray-2pc

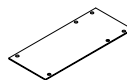

Tools Required for Assembly



Philips Screw Driver for

(E) Cam Post (G) Cam Lock

(I) Allen Screw M4X20mm

NOTE:

Hardware is packed with
carton **IDT7230HA**

HARDWARE & TOOLS

(R) Control Box
-1pc

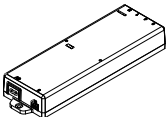

(S) Controller-1pc

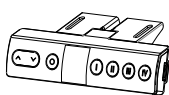

(T) Power cord
-1pc

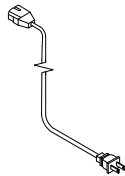

(U) Screw
Ø5X20mm-3pcs

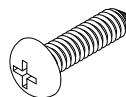

(V) Screw
Ø4X14mm-3pcs

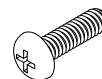

NOTE:

Hardware is packed with
carton **ALCB2 / ALCB3**.

Tools Required for Assembly



Philips Screw Driver for

(U) Screw Ø5X20mm

(V) Screw Ø4X14mm

INSTRUCTIONS - Do not use power tools to assemble

STEP 1

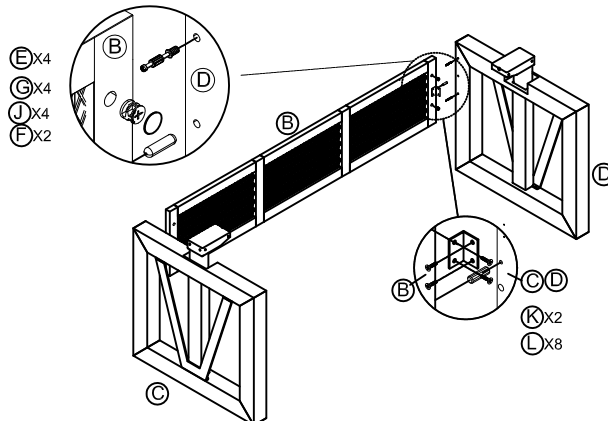

Congratulations on the purchase of your new *Signature Series* product!

INSTRUCTIONS - Do not use power tools to assemble

STEP 2

Install the Top (A) to the Legs (C,D) by Screw (I);

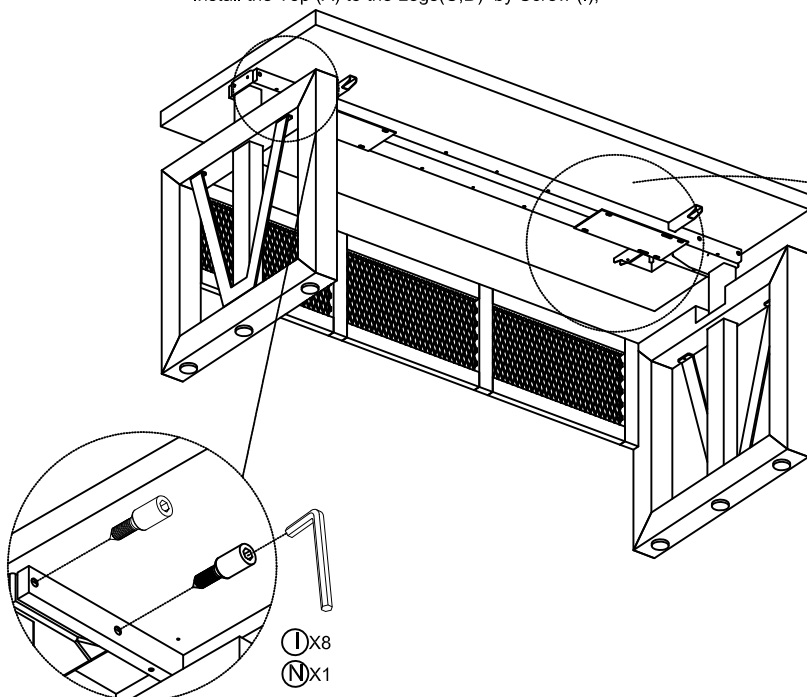
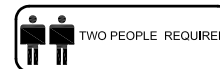

(H)X4

(P)X2

Uninstall the Frame Mounting
Screws, Qty 2, with Wrench (N).
Install Wire Management
Tray (P) to Frame using
Screws (H) and Wrench (M).
Re-install Frame Screws thru
Wire Management Tray.

(I)X8

(N)X1

STEP 3

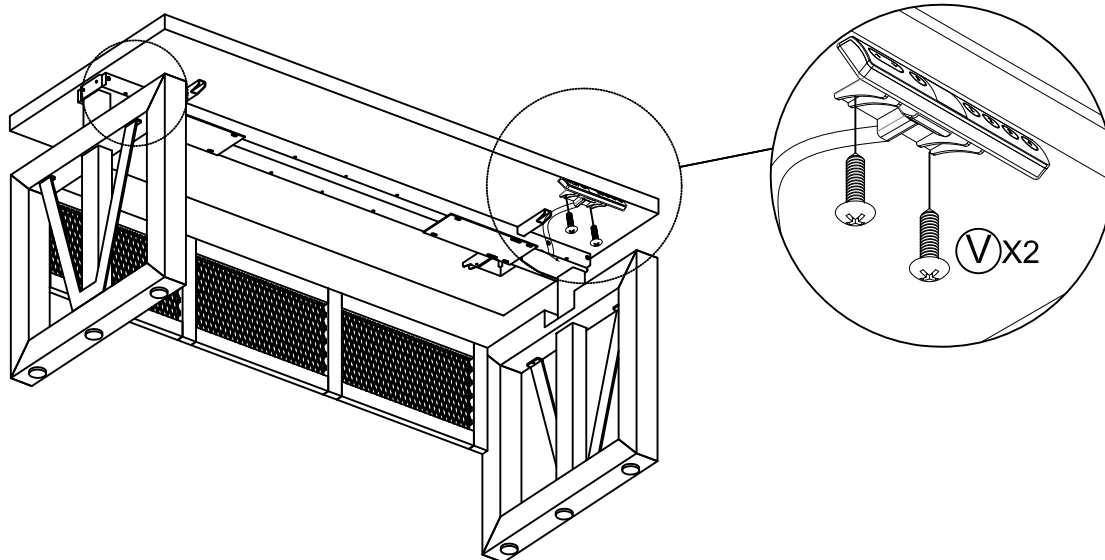

(V)X2

Congratulations on the purchase of your new *Signature Series* product!

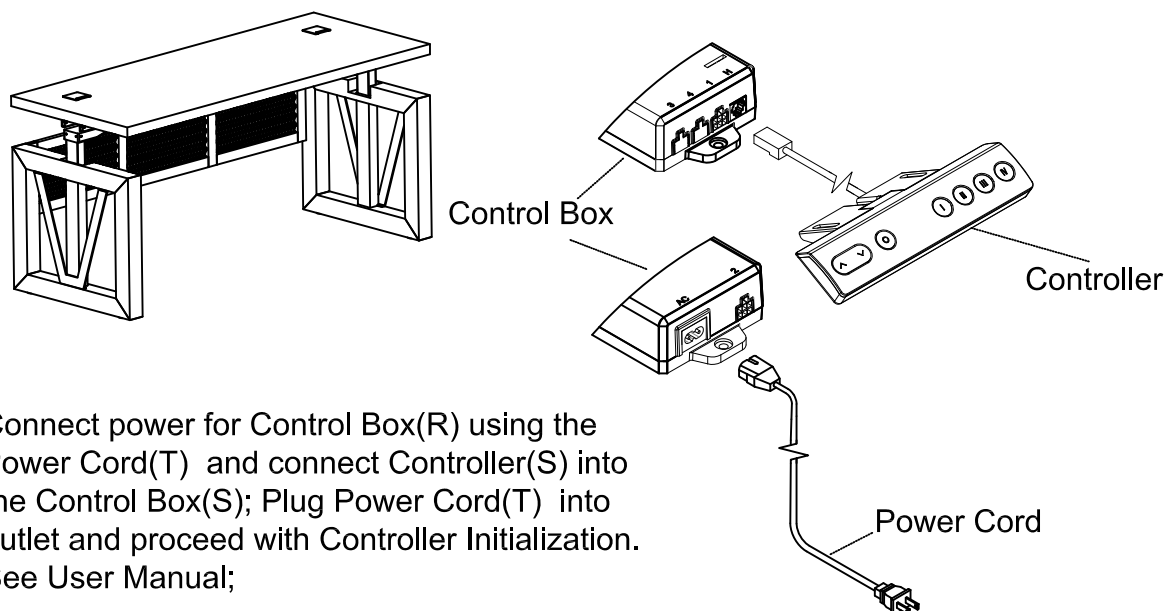
STEP 4

Connect power for Control Box(R) using the Power Cord(T) and connect Controller(S) into the Control Box(S); Plug Power Cord(T) into outlet and proceed with Controller Initialization. See User Manual;

Congratulations on the purchase of your new *Signature Series* product!

INSTRUCTIONS



Make sure no obstacles are in the desk's path.

Make sure the desktop is not touching any walls.



Make sure all cords are appropriate length to accommodate the change in height.

IMPORTANT: You must INITIALIZE the desk prior to first use.

Controller Initialization- Press and hold the Down button on the controller until the desk reaches its lowest height, slightly raises, and stops. Release the down button, your desk is now ready for use. (Following the "USER MANUALS" to use your desk)

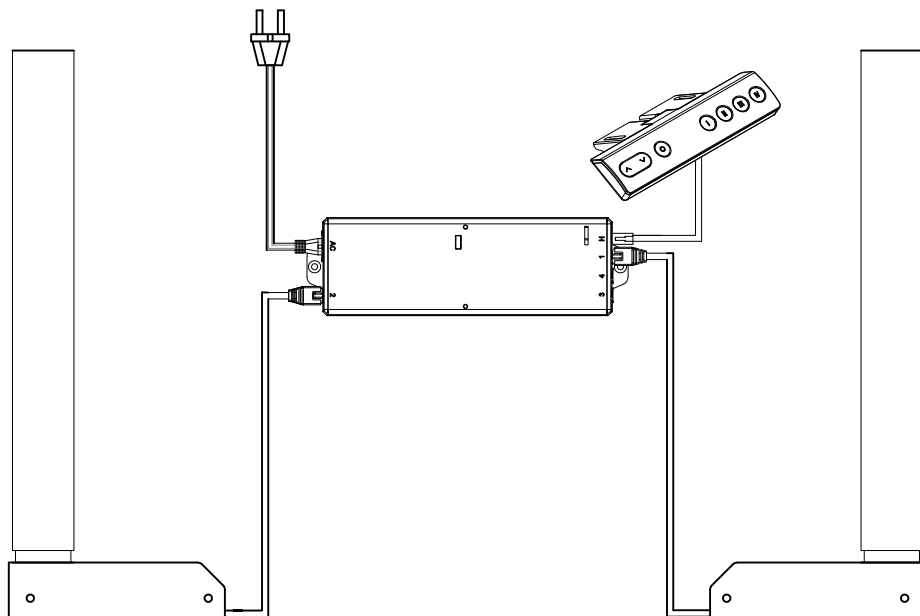

TROUBLESHOOTING

If the table is not functioning properly it may need to be reset.

Unplug the power cord for 20 seconds.

Plug the power cord back in and follow the RESET procedures.

If the error message persists after the reset procedure, please contact your dealer.

If the height between the legs exceeds 1.5 inches, stop the reset procedure, please contact your dealer.