



# Assembly Instructions MODEL NO.:

SL4824R,SL4224R,SL3624R,SL3024R  
RETURN-REVERSIBLE

LO2/02-09

CONC10	CONC11	DOWEL	GLIDE	TUN013LB	TUN018SC	TUN015BG	TUN0191B	PLASTIC CAP	PLUG
<b>A</b>  Cam Lock Pin 7Pcs+2Pcs	<b>B</b>  Cam Lock 7Pcs+2Pcs	<b>C</b>  Dowel 5Pcs+1Pcs	<b>D</b>  Glide 4Pcs	<b>E</b>  L-Bracket 4Pcs	<b>F</b>  Screw #4*5 42Pcs+5Pcs	<b>G</b>  Grommet 2Pcs	<b>H</b>  Flat Bracket 3Pcs	<b>I</b>  DEEP CAMLOCK CAP 10Pcs+2Pcs	<b>J</b>  CAP FOR DOWEL HOLES 2Pcs

<b>K</b>  CAP FOR METAL INSERT 3Pcs
-------------------------------------------------

## STEP1

### IMPORTANT:

#### FUNCTION OF CAM



1/4 RIGHT  
TURN FOR  
LOCKING

MAKE SURE THE ARROW IS POINTING UPWARDS  
BEFORE INSERTING INTO THE PANEL'S HOLE.

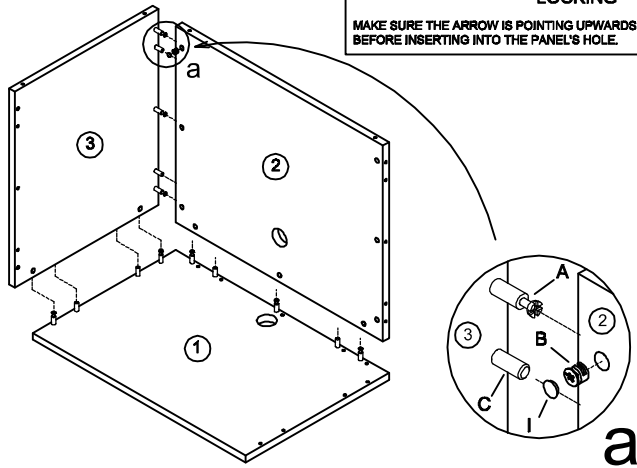

## STEP2

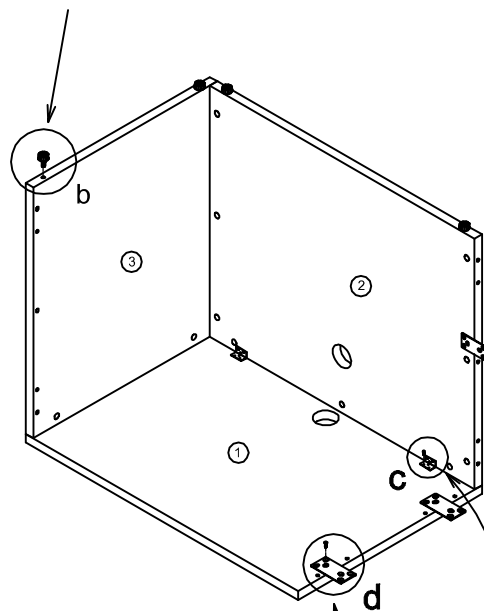
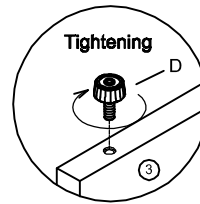

## STEP3

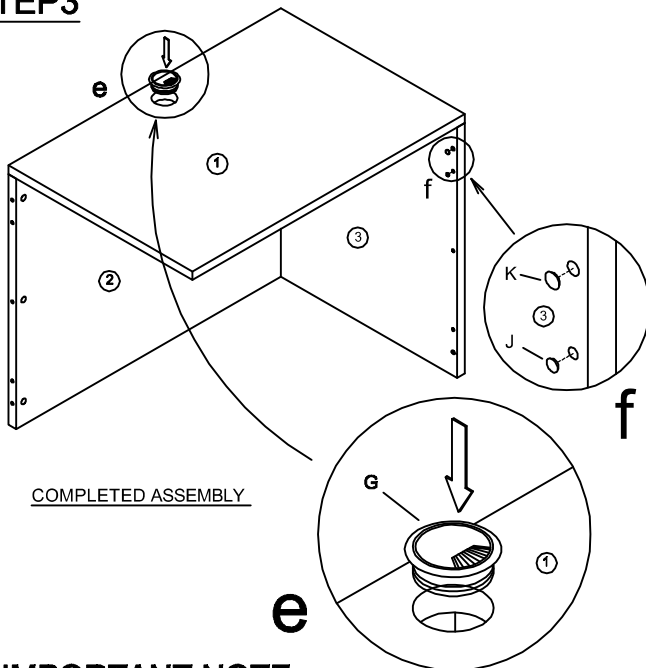

COMPLETED ASSEMBLY

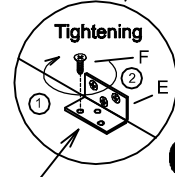
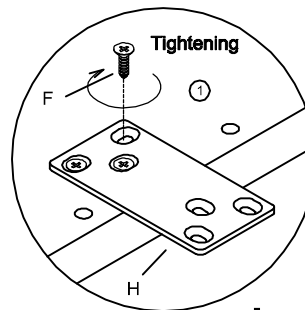

IMPORTANT:  
IF INSTALLING PEDESTAL;  
BRACKETS ON END NOT REQUIRED.

### IMPORTANT NOTE:

- It is advisable to assemble unit on a carpet to avoid scratch.
- Check to be sure that you have all parts and hardware.
- Don't tighten all screws/bolts until all completely assembled.
- It is recommended to require 2 persons to complete the assembling.