

# contigo®

## Shake and Go™ Flex Tumbler Care and Use Instructions

### ⚠ CAUTION

- Drinking directly from the lid while the straw is placed in the on-the-go straw carrier can result in facial injury. To avoid injury, always remove the straw from the on-the-go carrier before drinking directly from the lid.
- Product is NOT designed for hot beverages. For brew-over-ice beverages fill tumbler with ice before filling with hot liquid.
- DO NOT overfill. Fill liquids to just below the threading in the body.
- DO NOT microwave or freeze.
- DO NOT use cleaners containing bleach, chlorine, abrasives, and/or other harsh chemicals.
- DO NOT continue to use product if damaged.
- DO NOT carry bottles containing liquid in bags to help prevent accidental opening.

### USAGE RECOMMENDATIONS:

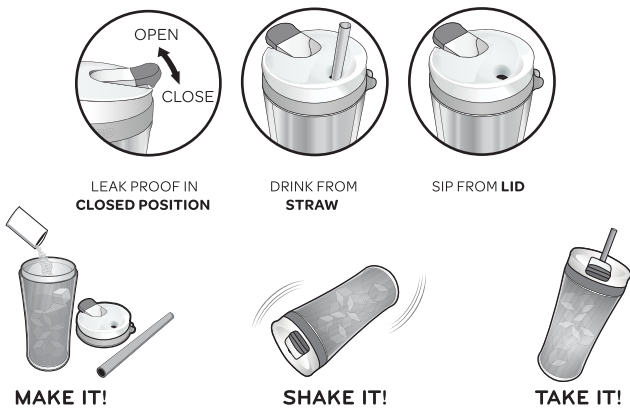

- Prior to shaking and drinking, make sure the lid is properly threaded to the body and screwed on completely and the lid lever is in the closed position.
- Shake to mix beverages with straw removed.
- DO NOT shake carbonated beverages.
- The AUTOCLOSE™ lid that came with your new purchase is designed to only fit your Contigo® tumbler. Not for use with other products.

### RECOMMENDED FOR:

- For Brew-over-ice beverages
  - 1.) Fill tumbler to the top with ice.
  - 2.) Fill liquids to just below the threading in the body. DO NOT OVERFILL.
  - 3.) Screw lid on completely and make sure lid lever is in the closed position before shaking.
  - 4.) Shake-to-mix contents for consistent temperature and flavor.
  - 5.) Insert straw and enjoy!
- For water enhancers and powdered additives
  - 1.) If desired, add ice to tumbler.
  - 2.) Fill liquids to just below the threading in the body. DO NOT OVERFILL.
  - 3.) Add desired amount of water enhancer or powdered additive.
  - 4.) Screw lid on completely and make sure lid lever is in the closed position before shaking.
  - 5.) Shake-to-mix contents for a superior and flavor.
  - 6.) Insert straw and enjoy!

### CLEANING INSTRUCTIONS:

- Wash thoroughly before first use.
- RINSE IMMEDIATELY AFTER EACH USE with warm water and with the AUTOCLOSE™ trap door in the closed position.
- Lid, plastic body and straw are top-rack dishwasher safe.
  - Remove straw from the lid for best results.



- If washing by hand, wash body, lid and straw with warm water in a mild detergent. Rinse lid, straw and body thoroughly before use.
- For best cleaning results, use a Contigo® bottle brush, available at [www.GoContigo.com](http://www.GoContigo.com).

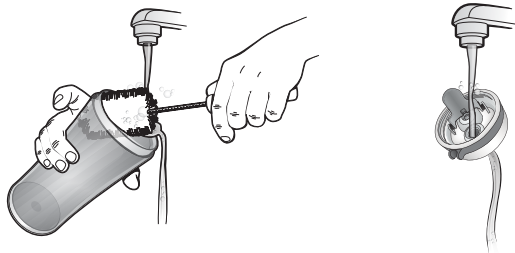

- ALWAYS STORE TUMBLER WITH LID REMOVED to allow all parts to dry completely.



For complete warranty information, see [GoContigo.com](http://GoContigo.com).

[www.GoContigo.com](http://www.GoContigo.com)

©2016 Ignite USA, LLC. All Rights Reserved.

Should you have any questions about your purchase, please contact us at 1-888-262-0622 or [GoContigo.com](http://GoContigo.com).

