

INSTALLATION INSTRUCTIONS

SINGLE ROD PARTS LIST:

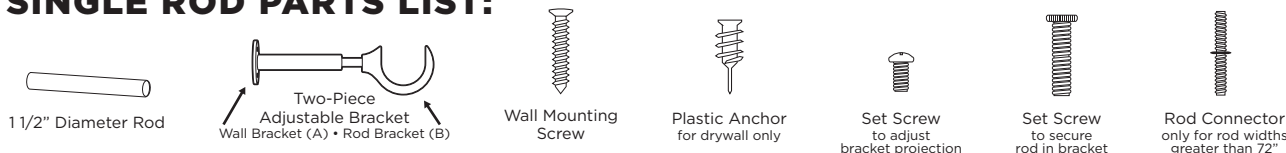

DOUBLE ROD PARTS LIST: FOR BACK ROD



INSTALLATION:

- 1 Determine the placement of rod(s) using the Measuring Guide on reverse side.
- 2 Measure and mark bracket locations above window. Utilize a level to ensure the rod will be level on the wall.
- 3 Drill 5/16" diameter pilot hole in drywall (or 1/16" in stud) for all marked bracket locations.
For drywall only: Screw plastic anchor into pilot hole until flush.

4 SINGLE ROD INSTALLATION:

- a. Attach all wall brackets A to wall using wall mounting screws.
Hand tighten with screwdriver only to prevent screw head damage. (Fig. 1)
- b. Place all rod brackets B into wall brackets A. Adjust to desired projection and tighten using set screws. (Fig. 2)

DOUBLE ROD INSTALLATION: See installation tip on reverse side.

For rod widths 36" - 72"

- a. Attach **left** double rod bracket to wall using wall mounting screws.
Hand tighten with screwdriver only, to prevent screw head damage. (Fig. 1)
- b. Slide panels onto 5/8" dia. back rod only. Slide the right double rod bracket onto right end of back rod.
- c. Slide back rod through installed left bracket and mount right bracket in marked location.
Tighten set screws to secure the rod. (Fig. 3)

For rod widths 84" - 180"

- a. Attach **left** double rod bracket to wall using wall mounting screws.
Hand tighten with screwdriver only, to prevent screw head damage. (Fig. 1)
- b. Slide panels onto one 5/8" dia. back rod section only.
Slide the center double rod bracket onto right end of back rod.
- c. Slide back rod through installed left bracket, positioning rod halfway into the center bracket, and mount center bracket in marked location. Tighten set screws to secure the rod. (Fig. 3)
- d. Attach rod connector to next back rod section.
Slide panel onto rod section and slide next bracket onto right end of rod.
- e. Screw rod into the left back rod so the rod seam is hidden in the center bracket. (Fig. 4)
- f. Mount next bracket in marked location. Tighten set screw to secure the rod.
- g. For rod widths 126" - 180", repeat steps d - f for the last rod section and wall bracket.

- 5 Slide drapery panels or rings onto the rod (1-1/8" dia. front rod) and place rod onto the installed (front) brackets, centering rod seams in brackets. Tighten set screw to secure front rod. (Fig. 5)

For rod widths greater than 72" only: screw rod sections together using rod connector(s) provided.

- 6 Attach decorative finials onto each end of the Single or front rod. (Decorative finials sold separately.)
For Double Rods only, attach end caps onto each end of the back rod. (Fig. 6)

TOOLS NEEDED: NOT INCLUDED

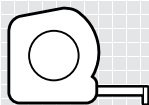

Tape Measure

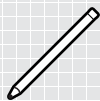

Pencil

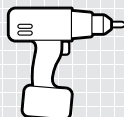

Drill



1/16" Drill Bit
for wall stud
5/16" Drill Bit
for drywall



Phillips-head
Screwdriver



Level

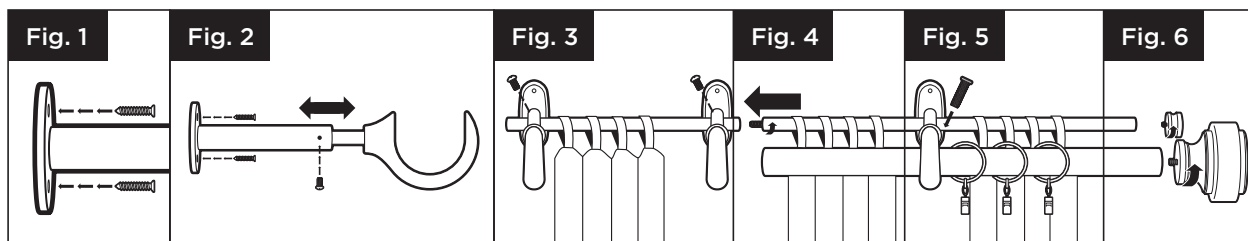

NOTE: Double rod installation shown but the same applies to Single Rod steps 5 & 6



CAMBRIA®

ESTATE

Cambria® Estate

MEASURING GUIDE DIAGRAM

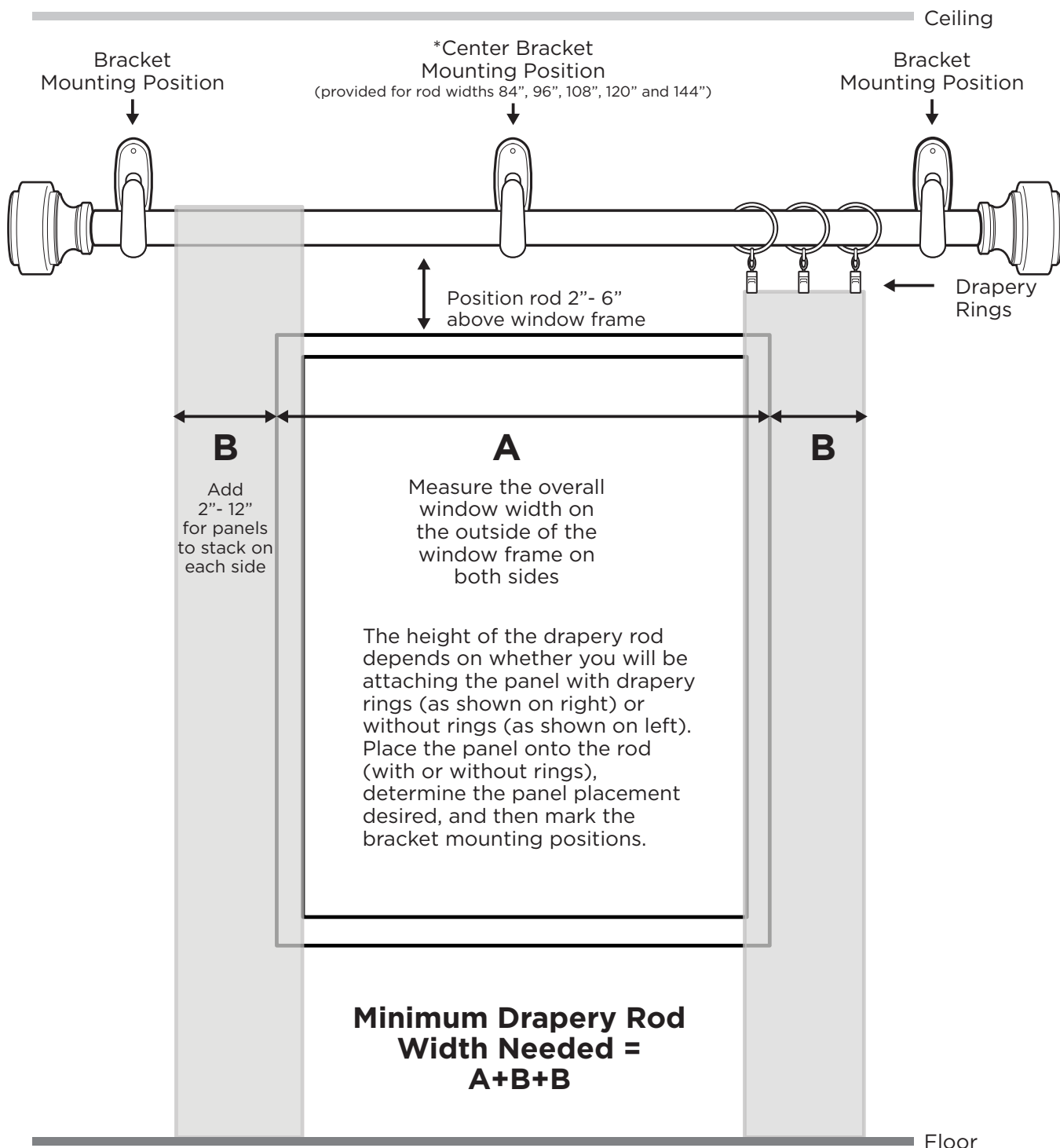

Double Rod Tip:

For easy double rod placement, ask a friend to help. Fully assemble the double rod with all brackets and panels attached. Hold assembly above the window to determine exact bracket placement on wall, evenly spacing brackets across the window.

* For rod widths 126", 162" and 180", four brackets are provided and should be mounted evenly spaced apart in order to hide rod seams behind the brackets.

