

INSTALLATION INSTRUCTIONS

SINGLE ROD PARTS LIST:

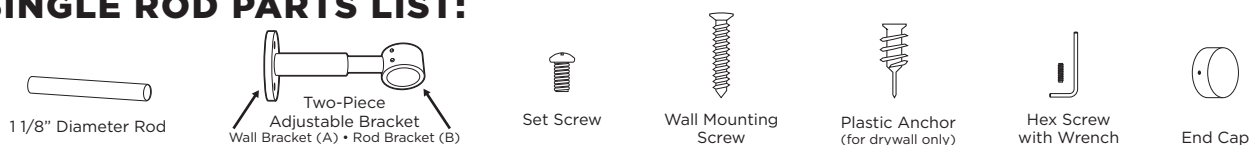

DOUBLE ROD PARTS LIST:



INSTALLATION:

- 1 Determine the placement of rod(s) using the Measuring Guide on reverse side.
- 2 Measure and mark bracket locations above window. Utilize a level to ensure the rod will be level on the wall.
- 3 Drill 5/16" diameter pilot hole in drywall (or 1/16" in stud) for all marked bracket locations.
For drywall only: Screw plastic anchor into pilot hole until flush.

4 SINGLE ROD INSTALLATION:

For rod widths 36" - 96"

- a. Attach all wall brackets A to wall using wall mounting screws. Hand tighten with screwdriver only, to prevent screw head damage. (Fig. 1)
- b. Slide drapery panels or rings onto the rod and slide rod bracket B onto each end of the rod. For rod widths 72" - 96" only, slide the extra rod bracket in between the panels for support.
- c. Place the rod brackets B into wall brackets A. Tighten hex screws to secure the rod. (Fig. 3)
- d. Adjust to desired projection and tighten wall bracket A to rod bracket B using set screws. (Fig. 2)

For rod widths 108" - 180"

- a. Attach all wall brackets A to wall using wall mounting screws. Hand tighten with screwdriver only, to prevent screw head damage. (Fig. 1)
- b. Slide the drapery panels or rings onto one rod section. Slide one rod bracket B onto each end of the rod.
- c. Place the rod brackets B into wall brackets A, starting from the left side. Position the rod halfway into the center bracket B. Tighten hex screw to secure the rod. (Fig. 3)
- d. Adjust to desired projection and tighten wall bracket A to rod bracket B using set screws. (Fig. 2)
- e. Slide drapery panels or rings onto the second rod section and slide rod bracket B onto the right end of rod.
- f. Place rod bracket B into the wall bracket A.
- g. Slide the two rod sections tightly together so the rod seam is hidden in the center bracket. For rod widths 108"-120", position the rod all the way through the right wall bracket. For rod widths 126"-180", position the rod halfway into the third wall bracket. Tighten hex screws to secure the rod. (Fig. 4)
- h. Adjust to desired projection and tighten wall bracket A to rod bracket B using set screws.
- i. For rod widths 126" - 180", repeat steps e - h for the last rod section and bracket.

DOUBLE ROD INSTALLATION:

*See installation tip on reverse side.

For rod widths 36" - 96"

- a. Attach **left** double rod wall bracket only to wall using wall mounting screws. Hand tighten with screwdriver only, to prevent screw head damage. (Fig. 1)
- b. Slide drapery panels or rings onto front rod and sheer panels onto back rod. For rod widths 36" - 60", slide the right wall bracket onto right end of rods. For rod widths 72" - 96", slide the extra wall bracket in between the panels for support.
- c. Slide rods through installed left bracket and mount wall bracket in marked location. Tighten hex screws to secure the rod. (Fig. 3)
- d. For rod widths 72"-96" only, attach the third wall bracket in marked location.

For rod widths 108" - 180"

- a. Attach **left** double rod wall bracket only to wall using wall mounting screws. Hand tighten with screwdriver only, to prevent screw head damage. (Fig. 1)
- b. Slide drapery panels or rings onto one front rod section and sheer panels onto one back rod section. Slide center wall bracket onto right end of rods.
- c. Slide rods through installed left bracket and mount center wall bracket in marked location. Position the rods halfway into the center wall bracket. Tighten hex screws to secure the rods. (Fig. 3)
- d. Slide panels or rings onto second front and back rod sections and slide next bracket onto right end of rods.
- e. Slide the two sets of rod sections tightly together so the rod seams are hidden in the center brackets. For rod widths 108"-120", position the rods all the way through the right wall bracket. For rod widths 126"-180", position the rods halfway into the third wall bracket. (Fig. 4)
- f. Mount next bracket in marked location. Tighten hex screws to secure the rods.
- g. For rod widths 126" - 180", repeat steps d - f for the last rod section and wall bracket.

- 5 Slide end caps onto both ends of the rod(s) and secure with hex screws.

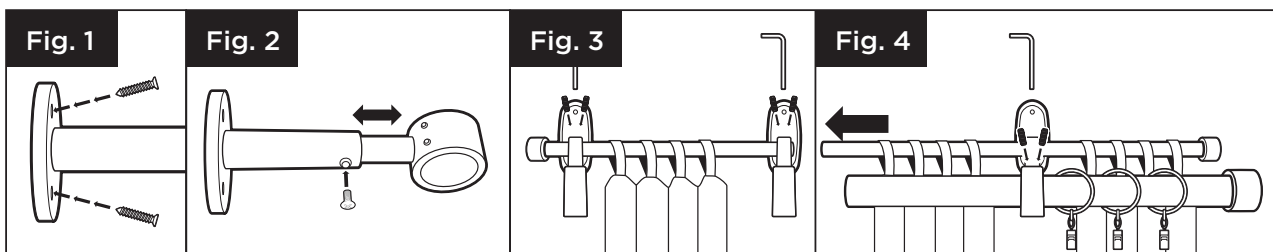

NOTE: Double rod installation shown but the same applies to Single Rod

TOOLS NEEDED: NOT INCLUDED

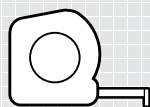

Tape Measure

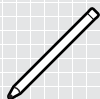

Pencil

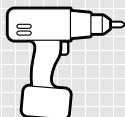

Drill

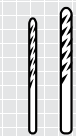

1/16" Drill Bit for wall stud
5/16" Drill Bit for drywall



Phillips-head Screwdriver



Level



CAMBRIA®

ACRYLIC

Cambria® Acrylic

MEASURING GUIDE DIAGRAM

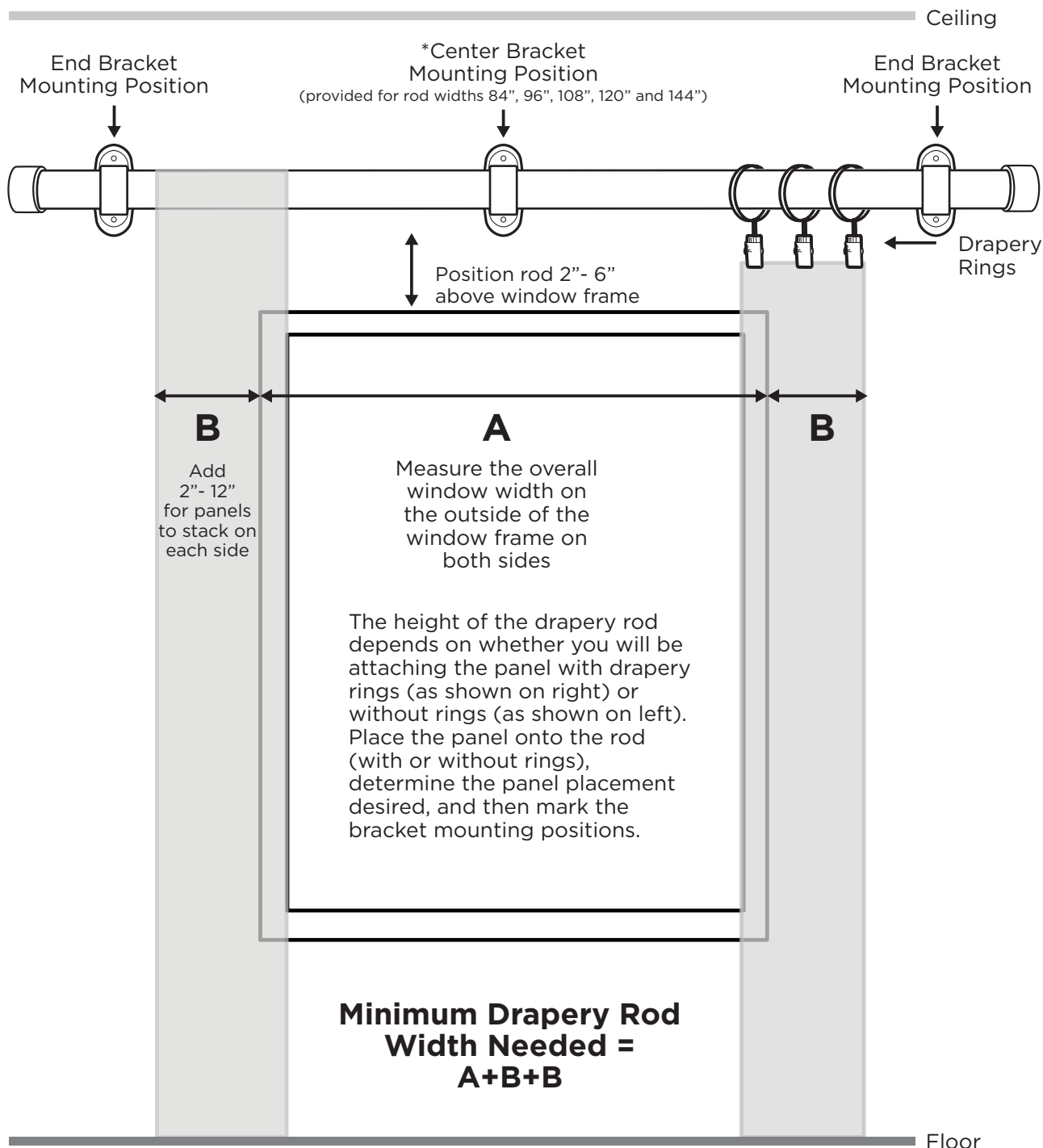

Double Rod Tip:

For easy double rod placement, ask a friend to help. Fully assemble rod(s) with all brackets and panels attached. Hold assembly above the window to determine exact bracket placement on wall, evenly spacing brackets across the window.

* For rod widths 126"-180", four brackets are provided and should be mounted evenly spaced apart in order to hide rod seams and secure rods inside each bracket.

