

MSA Fixed Gas & Flame Detection

Flame & Gas Mapping Solutions

A photograph of an industrial facility, likely a refinery or chemical plant, at dusk. The sky is a deep blue with scattered white clouds. The facility is illuminated by numerous warm, yellow lights, highlighting various structures including large cylindrical storage tanks, tall distillation columns, and complex piping systems. The foreground shows a large, dark, curved pipe. A semi-transparent white banner is overlaid across the middle of the image, containing the text 'MSA Flame & Gas Mapping'.

MSA Flame & Gas Mapping

*Because every life has a **purpose...***

Why Perform Flame & Gas Mapping?

Fixed flame and gas detection systems are designed and installed to protect large and complex areas filled with process equipment from risks of combustible or toxic gas leaks, explosions and flames. For these systems to be effective, it is important that they offer a high likelihood of detecting the presence of any flame and gas hazards within monitored process areas. Determining optimal quantity and location of flame and gas detectors is therefore critical to ensure the detection system's effectiveness.

Detector placement however, has largely relied upon past experiences, common practice and prescriptive standards. Though not necessarily incorrect, these approaches typically do not offer a systematic method of assessing flame and gas risk under different gas release scenarios, wind conditions and obstruction scenarios. In addition, these traditional approaches do not offer a simple method of measuring risk reduction performance and effectiveness of detection systems when varying detector technologies, locations and quantities are deployed. Limitations of traditional approaches make it difficult for users to optimize their flame and gas detection assets, or to quantify effectiveness of their current detection in meeting their safety performance objectives.

MSA Flame & Gas Mapping

MSA flame and gas mapping is a solution that assists in the evaluation of flame and gas risks within a process facility and in the reduction of these risks towards an acceptable risk profile. Flame and gas mapping includes placing of detectors in appropriate locations to achieve best possible detection coverage. Through design iterations, the effects of different detector arrangements or detection technology on detection coverage are quantified and assessed, stopping when the desired performance target is met. The approach used is based upon recommendations outlined in ISA's TR84.00.07 Technical Report. Upon conclusion, a mapping report that includes graphical maps of residual risks, recommended detector placements and numerical estimates of detection coverage is provided to the client.

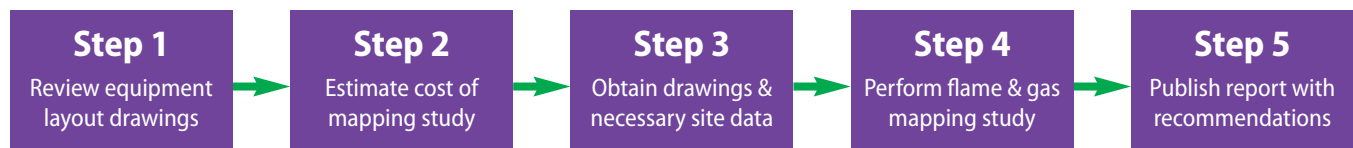

Figure 1 : MSA flame and gas mapping service sequence



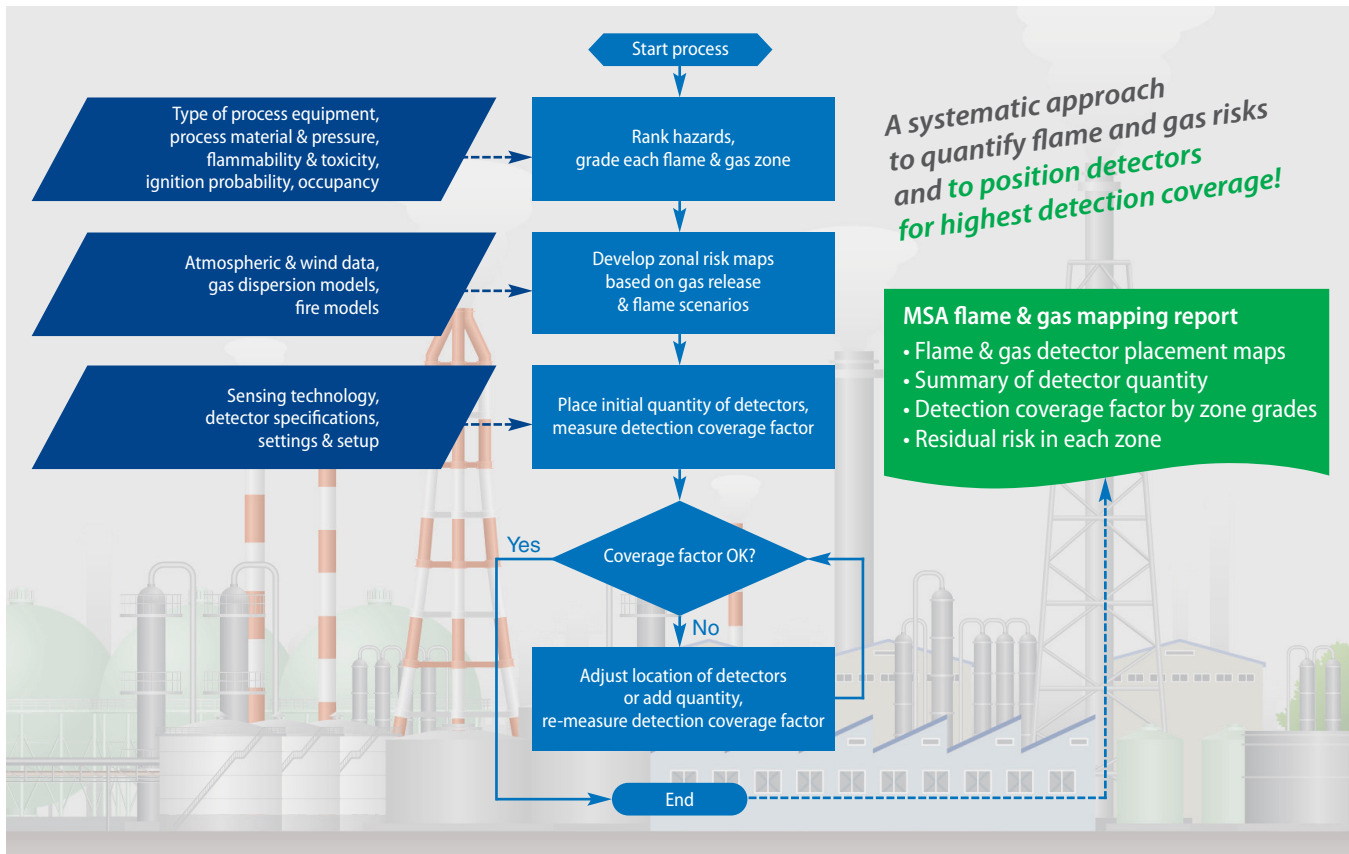

Figure 2 : MSA's flame and gas mapping study approach

MSA's mapping process supports latest generation detection technologies, allowing users to tailor their detector mix to specific applications. These detection technologies include:

Combustible Gas	Toxic Gas	Flame
• Point Catalytic Bead	• Electrochemical (ECC)	• MSIR
• Point IR	• Solid State (MOS)	• DFIR
• Open Path IR	• Photoacoustic-IR (PIR)	• UVIR / UVIR-H ₂
• Ultrasonic		• UV

Effigy Flame & Gas Mapping 3D Software Tool

MSA uses the Effigy Flame and Gas Mapping 3D Software tool developed by KENEXIS for flame and gas mapping studies. This ISA TR84.00.07-compliant software tool identifies areas of gas release or flame risk by quantifying risk likelihoods via modelling. Resulting models provide a deterministic method of ascertaining the type and quantity of detectors needed, detector placements, detection coverage provided by installed detectors, and remaining flame and gas risks after detector installation. Effigy's powerful modelling algorithms calculate geographic- and scenario-based detection coverage for both flame and gas mapping studies.

In calculations of detection coverage for gas mapping, algorithms combine hundreds of gas release and dispersion scenarios that could occur in the area of study, and gas detector sensitivity. In mapping for flame detection, algorithms consider the flame detector's field-of-vision, sensitivity settings, radiant heat output (RHO) of the target flame, obstructions, and obstructed flame plumes. Effigy displays these modelling results in graphical color-coded coverage maps that indicate the extent of flame and gas coverage.

Improving Gas Detection Coverage with MSA Gas Mapping

Case study: Modelling volatile liquid hydrocarbon release from 7 pumps

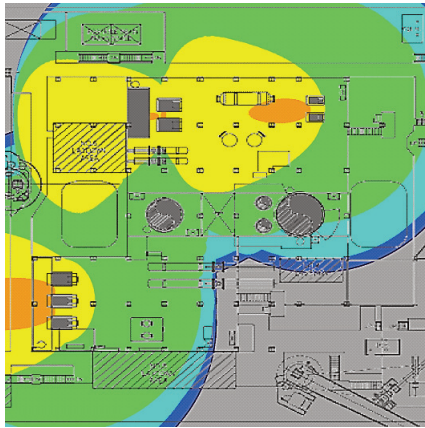

Stage 0 analysis

- 2D gas map with no gas detectors
- Map showing initial gas risk with 0% scenario detection coverage

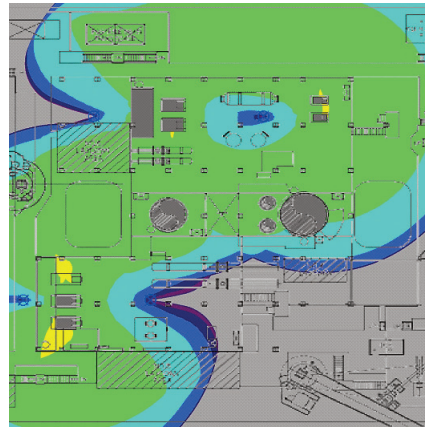

Stage 1 analysis

- 2D gas map with an initial placement of 4-point gas detectors
- Map showing reduction of gas risk with 60% scenario detection coverage

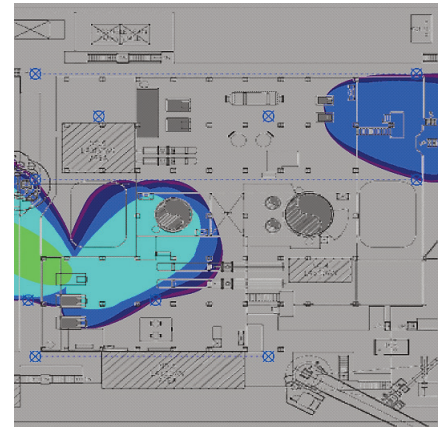

Stage 2 analysis

- 2D gas map with 4-point and 3 open path gas detectors
- Map showing significant reduction of gas risk with >90% scenario detection coverage

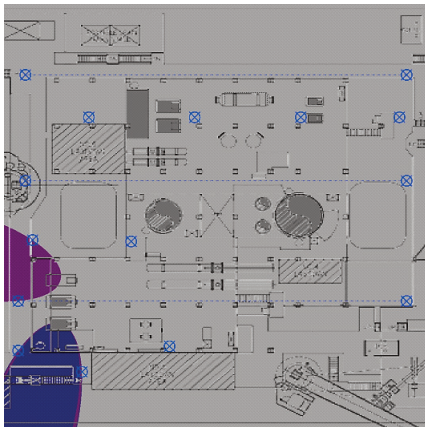

Stage 3 analysis

- 2D gas map with final placements of 3 open path and 9-point gas detectors
- Map showing negligible residual undetectable gas risk with >99% scenario detection coverage

LEGEND

Hazard Frequency (per year)

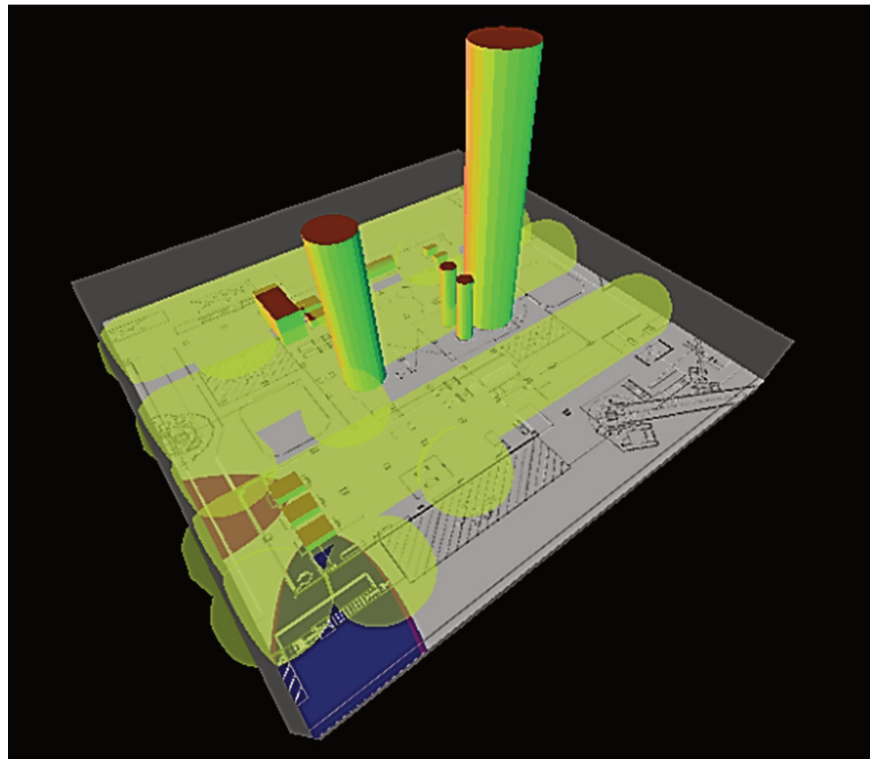
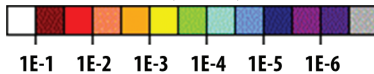

Final stage

- 3D rendering of gas map with final detector placements

Improving Flame Detection Coverage with MSA Flame Mapping

Case study: Modelling small flames (1sqft) around 7 pumps

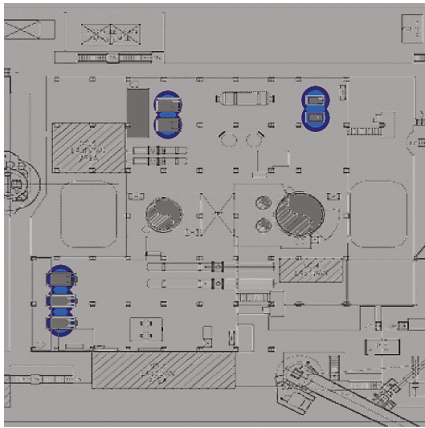

Stage 0 analysis

- 2D flame map showing undetected flames around pumps

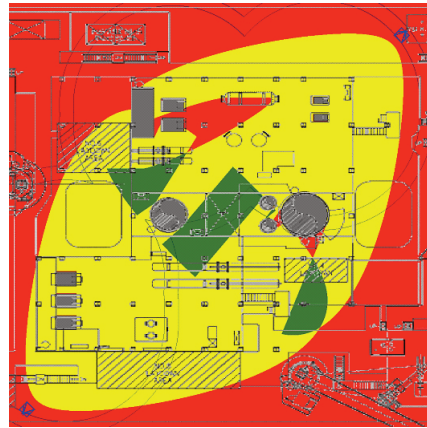
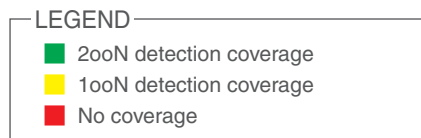

Stage 1 analysis

- 2D flame map with an initial placement of 2 MSIR flame detectors
- Incipient flames at 2 pumps may be blocked from detection view
- Flame coverage for Grade A zone:

■	4%	■	68%	■	28%
--------------------------------------	----	---------------------------------------	-----	------------------------------------	-----



Stage 2 analysis

- 2D flame map with 3 MSIR flame detectors
- All areas around pumps are now in the view of at least 1 flame detector
- Flame coverage for Grade A zone:

■	34%	■	47%	■	19%
--------------------------------------	-----	---------------------------------------	-----	------------------------------------	-----

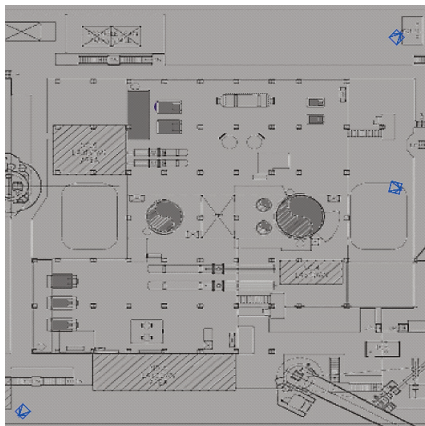

Stage 3 analysis

- 2D flame map with final placements of 3 MSIR flame detectors
- Map showing no risk of undetected flames around pumps with >99% scenario detection coverage

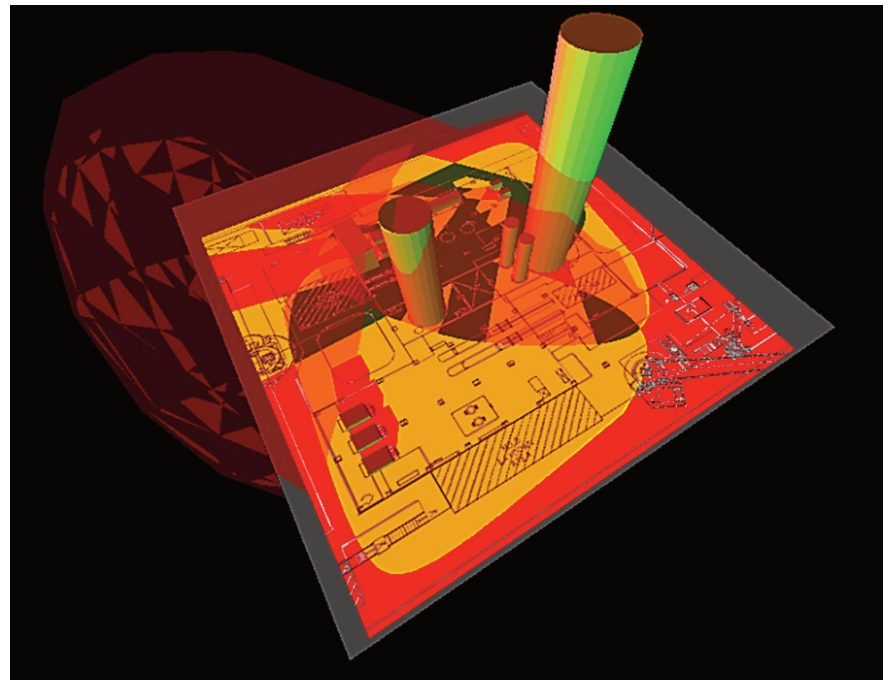
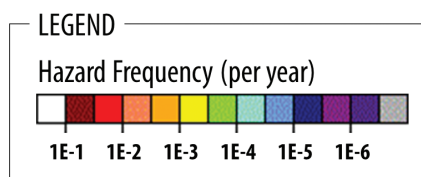

Final stage

- 3D rendering of fire map with final flame detector placements

Design detector layouts for highest detection coverage

Ask for **MSA flame & gas mapping**

MSA North America

NAmerica.mapping@MSAsafety.com

Lake Forest, CA USA

Phone: (1) 949 699 4464

Houston, TX USA

Phone: (1) 281 855 6000

MSA Europe

EUROPE.mapping@MSAsafety.com

Berlin, Germany

Phone: (49) 30 68 86 - x555

MSA China

CHINA.mapping@MSAsafety.com

Shanghai, PRC

Phone: (86) 0512 6289 8880 - x3606

MSA Latin America

SAmerica.mapping@MSAsafety.com

Querétaro, Mexico

Phone: (52) 442 2273 90 - x3973

Bogota, Colombia

Phone: (57) 1 896 6750 - x103

BRAZIL.mapping@MSAsafety.com

Sao Paulo, Brazil

Phone: (55) 11 4070 5999

MSA Middle East

MIDEAST.mapping@MSAsafety.com

Dubai, UAE

Phone: (971) 4 299 6741

MSA Pacific Asia

PACIFICA.mapping@MSAsafety.com

Singapore

Phone: (65) 6482 1921

Rayong, Thailand

Phone: (66) 3869 1427-8

Note: This Bulletin contains only a general description of the products shown. While uses and performance capabilities are described, under no circumstances shall the products be used by untrained or unqualified individuals and not until the product instructions including any warnings or cautions provided have been thoroughly read and understood. Only they contain the complete and detailed information concerning proper use and care of these products.



ID 0700-74-MC / January 2016

© MSA 2016 Printed in U.S.A.

MSA Singapore

MSA S.E Asia Pte Ltd
35 Marsiling Industrial Estate Road 3,
#04-01, Singapore 739257.

Phone: +65 6350 4500

Fax: +65 6350 4505

Email: msa.singapore@MSAsafety.com

MSA Malaysia

No.5, Jalan P4/8A, Crest Hill Industrial Park
Bandar Teknologi Kajang, Semenyih
43500 Selangor, Malaysia

Phone: +603 8724 8208/9208

Fax: +603 8724 2208

Email: msa.malaysia@MSAsafety.com

MSA Australia

11 Columbia Way
Norwest Business Park
Baulkham Hills NSW 2153

Phone: 1300 728 672

Fax: +61 2 9896 1835

Email: aus.customerservice@MSAsafety.com

MSA (Thailand) Ltd.

28th Floor Suntower Bldg. B, No. 2801
123 Vibhavadi-Rangsit Rd., Chomphon
Chatuchak, Bangkok 10900, Thailand

Phone: +66 2617 8211

Fax: +66 2617 8214

Email: msa.thailand@MSAsafety.com

MSA New Zealand

Customer Service

Phone: 0800 441 335

Email: nz.customerservice@MSAsafety.com

MSA Indonesia

Kompleks Multiguna Kemayoran No 1-K
Jl. Rajawali Selatan Raya Block C5 No. 2
Jakarta Utara 14410, Indonesia

Phone: +62 21 6409 000

Fax: +62 21 641 2831

Email: _____

MSA Philippines

Unit 2309 Jollibee Plaza
Condominium Building
F. Ortigas Jr. Road, Ortigas Center
Pasig City, Philippines

Phone: +63 9209 742 191

For sales enquiry, contact us [here](#).

MSAsafety.com