

Certified Air Mask Repair Education (C.A.R.E.) Manual
PremAire® Cadet Escape
Supply Hose



Order No.: 10105225/03
Print Spec. 10000005389 (A)
CR 800000012288



WARNING!

Read this manual carefully before servicing the device. The device will perform as designed only if it is used and maintained in accordance with the manufacturer's instructions. Otherwise, it could fail to perform as designed and persons who rely on this device for their safety could sustain serious personal injury or death.

Please read and observe the WARNINGS and CAUTIONS inside. For any additional information relative to use or repair, call 1-800-MSA-2222 during regular working hours.

For alternate languages, please refer to part number 10176647.



The Safety Company

1000 Cranberry Woods Drive
Cranberry Township, PA 16066
USA
Phone 1-800-MSA-2222
Fax 1-800-967-0398

For your local MSA contacts please go to our website www.MSAafety.com

Contents

1	PremAire Cadet Escape Supply Hose	4
1.1	Required Tools and Equipment	4
1.2	Parts List and Replacement Parts	5
2	Maintenance and Care	6
2.1	Removing the Supply Hose and Ring	6
2.2	Installing the Supply Hose and Ring	7
2.3	Removing the Filter	7
2.4	Installing the Filter	8
2.5	Removing the Quick Connect	9
2.6	Installing Quick Connect	9

1 PremAire Cadet Escape Supply Hose

1.1 Required Tools and Equipment

Standard Parts

DESCRIPTION
Torque Wrench, 25 ft-lbs
Open End Wrench, 5/8"
Open End Wrench, 11/16"
Crowfoot, 5/8"
Crowfoot, 11/16"
Vise



US

1.2 Parts List and Replacement Parts

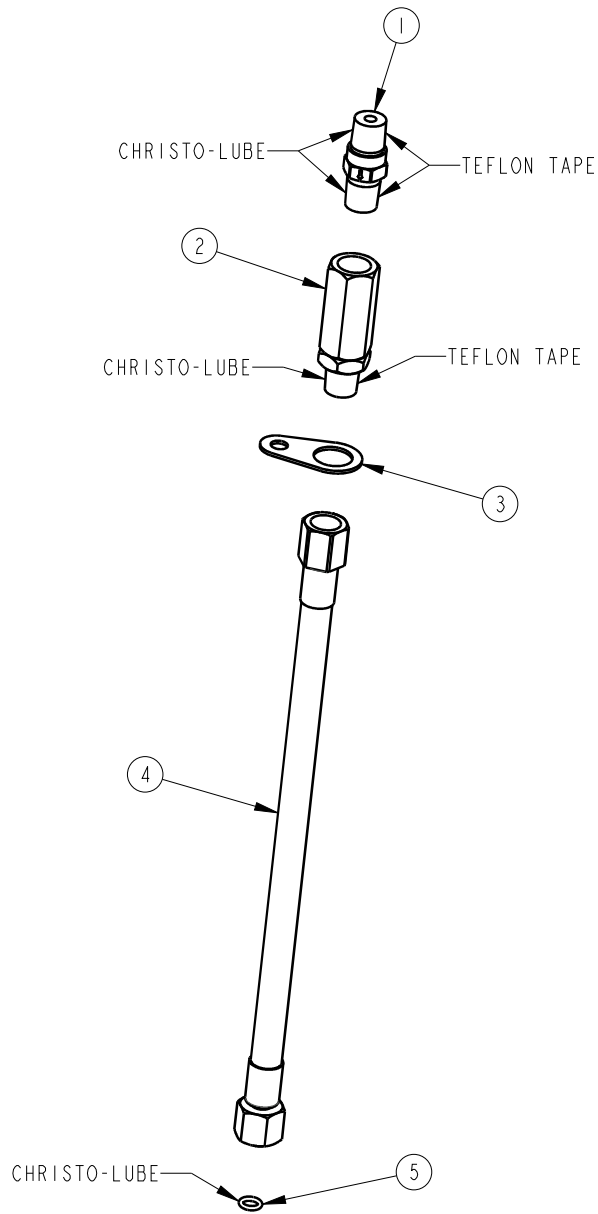

Fig. 1 Exploded View

ITEM	Quantity	DESCRIPTION	PART NUMBER
1	1	CHECK VALVE	630326
2	1	FILTER	637773
3	1	RING	481276
4	1	SUPPLY HOSE	10113864
5	1	O-RING	63198
		CHRISTO-LUBE	604070
		TEFLON TAPE	28907

2 Maintenance and Care

2.1 Removing the Supply Hose and Ring



- (1) Remove the supply hose assembly (See **Removing the Supply Hose, PremAire Cadet Escape Carrier and Harness C.A.R.E. Manual**).
- (2) Secure the filter in a vise such that the hose and hose fitting are accessible.

NOTE: Use a vise with flat and smooth jaws. Do not use protective sleeves.



- (3) Use the 11/16" wrench to disconnect the hose from the filter.

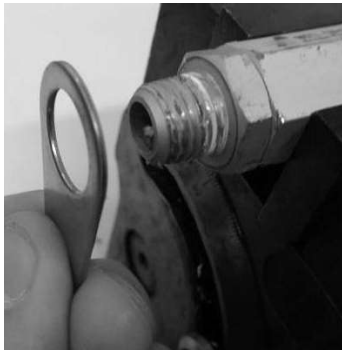

- (4) Remove the ring.

US

2.2 Installing the Supply Hose and Ring

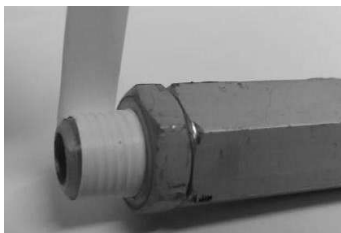

- (1) Apply Teflon tape to the exposed threads of the filter.



- (2) Secure the filter in a vise such that the external threads are accessible.

NOTE: Use a vise with flat and smooth jaws. Do not use protective sleeves.

- (3) Install the ring.
- (4) Apply a thin film of Christo-Lube to the outer surface of the taped threads.

NOTE: To prevent contamination, apply Christo-Lube immediately before installation.



- (5) Use the 11/16" crowfoot and foot-pound torque wrench to tighten the hose fitting onto the filter to 25 ft-lbs.
- (6) Install the supply hose assembly (See **Installing the Supply Hose, PremAire Cadet Escape Carrier and Harness C.A.R.E. Manual**).

2.3 Removing the Filter



- (1) Remove the supply hose and ring (See Removing the Supply Hose and Ring).
- (2) Secure the filter in a vise such that the check valve is accessible.

NOTE: Use a vise with flat and smooth jaws. Do not use protective sleeves.



- (3) Use the 5/8" wrench to disconnect the check valve from the filter.

NOTE: Do not attempt to disassemble the filter.

2.4 Installing the Filter



- (1) Secure the filter in a vise such that the end of the filter marked IN is accessible.

NOTE: Use a vise with flat and smooth jaws. Do not use protective sleeves.



- (2) Apply Teflon tape to the exposed threads of the check valve.
- (3) Apply a thin film of Christo-Lube to the outer surface of the taped threads.

NOTE: To prevent contamination, apply Christo-Lube immediately before installation.

- (4) Ensure the arrow is pointing toward the end of the filter marked IN.

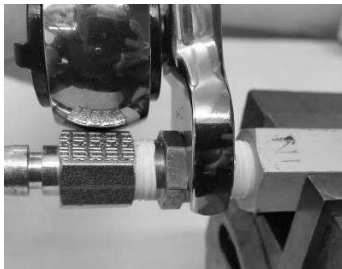

- (5) Use the 5/8" crowfoot and foot-pound torque wrench to tighten the check valve onto the filter to 25 ft-lbs.
- (6) Install the supply hose and ring (See **Installing the Supply Hose and Ring**).
- (7) Install the supply hose assembly (See **Installing the Supply Hose, PremAire Cadet Escape Carrier and Harness C.A.R.E. Manual**).

US

2.5 Removing the Quick Connect



- (1) Remove the supply hose assembly (See Removing the Supply Hose, PremAire Cadet Escape Carrier and Harness C.A.R.E. Manual).
- (2) Secure the quick connect in a vise such that the rest of the supply hose assembly is accessible.

NOTE: Use a vise with flat and smooth jaws. Do not use protective sleeves.



- (3) Use the 5/8" wrench to disconnect the check valve from the quick connect.

2.6 Installing Quick Connect

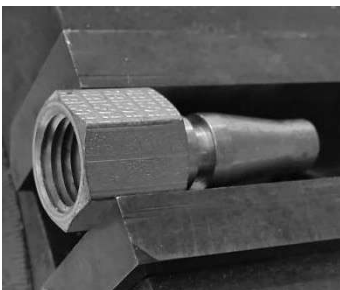

- (1) Secure the quick connect in a vise such that the fitting threads are accessible.

NOTE: Use a vise with flat and smooth jaws. Do not use protective sleeves.

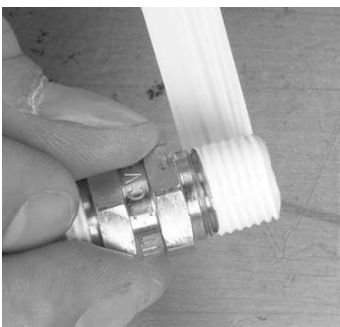

- (2) Apply Teflon tape to the exposed threads of the check valve.
- (3) Apply a thin film of Christo-Lube to the outer surface of the taped threads.

NOTE: To prevent contamination, apply Christo-Lube immediately before installation

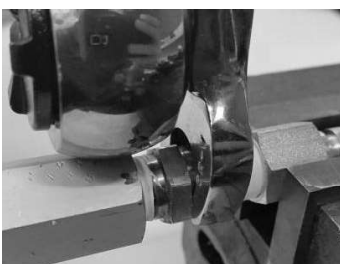

- (4) Use the 5/8" crowfoot and foot-pound torque wrench to tighten the check valve onto the quick connect to 10 ± 2 ft-lbs.

NOTE: For quick disconnect plug PN 55716, tighten to 104 ± 8 in-lbs.

- (5) Install the supply hose assembly (See **Installing the Supply Hose, PremAire Cadet Escape Carrier and Harness C.A.R.E. Manual**).

