

PremAire® Cadet Escape Respirator: Supply Hose

MAINTENANCE AND REPAIR

For More Information, call 1-800-MSA-2222 or Visit Our Website at www.MSAnet.com



**MINE SAFETY APPLIANCES COMPANY
PITTSBURGH, PENNSYLVANIA, U.S.A. 15230**

SUPPLY HOSE

Table of Contents

Parts List and Exploded View	2	Quick-Disconnect	3
DISASSEMBLY	3	REASSEMBLY	3
Filter and Ring	3	Check Valve	3
Check Valve	3	Filter and Ring	3

Item	Part Number	Description
1	630326	Check Valve
2	637773	Filter
3	481276	Ring
4	10113864	Supply Hose
5	63198	O-ring
	604070	Christo-Lube Lubricant
	28907	Teflon Tape

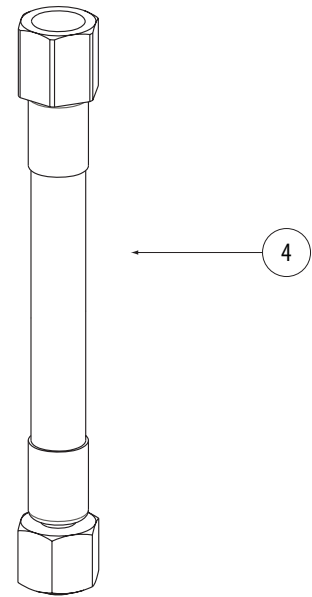
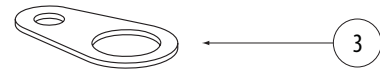
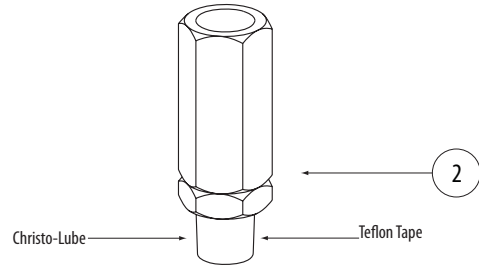
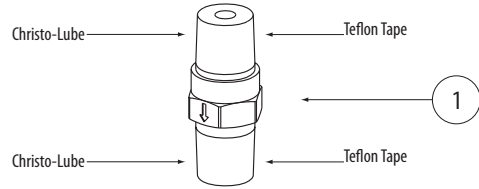

SUPPLY HOSE

DISASSEMBLY

1. Disconnect the hose strap and the supply hose. (See **PremAire Cadet Escape Respirator, Carrier and Harness, P/N 10114031** for instructions)

Filter and Ring

1. Use two 11/16" wrenches to disconnect the filter from the hose.



Note: Do not attempt to disassemble the filter.

2. Remove the ring.

Quick Disconnect Plug

1. Use two 5/8" wrenches to disconnect the check valve from the quick-disconnect plug.



REASSEMBLY

1. Apply Teflon tape to both ends of the check valve.

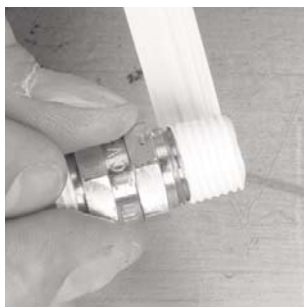

2. Apply a small amount of Christo-Lube.

Note: To prevent contamination, apply Christo-Lube immediately before installation. Use a vise with flat and smooth jaws. Do not use protective sleeves.

3. Secure the filter in a vise.

4. With the arrow pointing toward the end of the filter marked IN; screw the check valve into the filter.

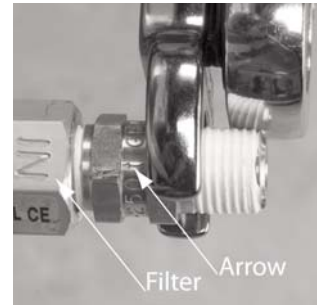

5. Use the 5/8" crowfoot and foot-pound torque wrench to tighten to no more than 25 ft lbs.

Filter and Ring

1. Turn the filter end over end. Secure the filter in a vise, as shown.



2. Install the ring.

3. Apply a small amount of Christo-Lube to the thread.

Note: To prevent contamination, apply Christo-Lube immediately before installation.

4. Screw the hose onto the filter.



5. Use an 11/16" crowfoot and foot-pound torque wrench to tighten to no more than 25 ft lbs.



Supply Hose

1. Use the 5/8" crowsfoot and foot-pound torque wrench to tighten to no more than 25 ft.lbs

SUPPLY HOSE

Quick-Disconnect Plug and Check Valve

1. Apply a small amount of Christo-Lube to the valve thread.

Note: To prevent contamination, apply Christo-Lube immediately before installation. Use a vise with flat and smooth jaws. Do not use protective sleeves.



2. Secure the filter in a vise, as shown.

3. Use a 5/8" crowfoot and foot-pound torque wrench to tighten to no more than 25 ft. lbs.
4. Attach the hose strap. (See **PremAire Cadet Escape Respirator, Carrier and Harness, P/N 10114031** for instructions)