

ComfoClassic

Facepiece Components

FACEPIECE BLANK

Part No. Description

807886 SMALL, BLACK, SILICONE

807878 SMALL, BLACK, HYCAR

807885 MEDIUM, BLACK, SILICONE

807876 MEDIUM, BLACK, HYCAR

807887 LARGE, BLACK, SILICONE

807880 LARGE, BLACK, HYCAR

YOKE ASSEMBLY

Part No. Description

807607 SMALL, BLACK

807605 MEDIUM, SILVER

807608 LARGE, GOLD

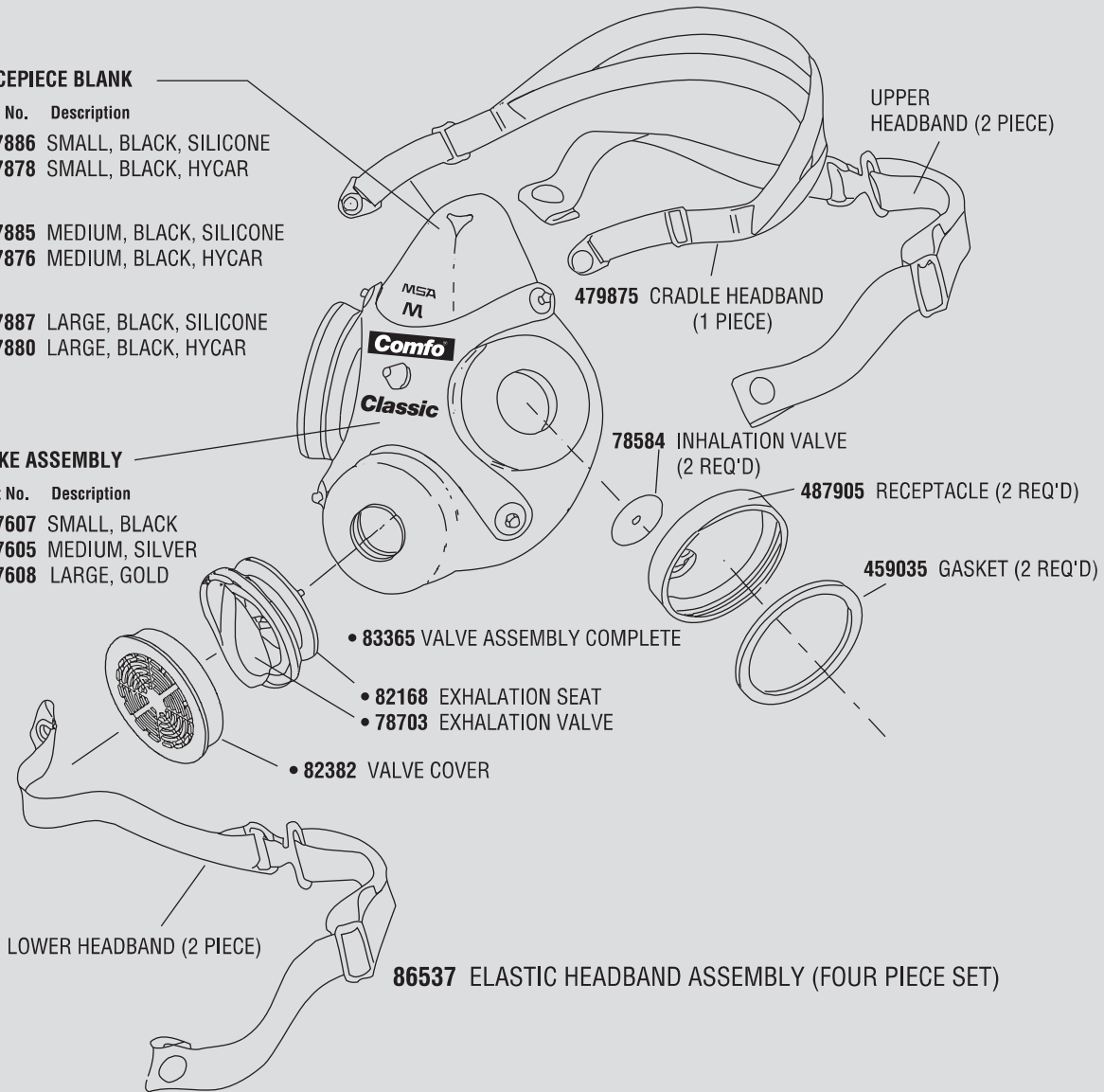

Note: This bulletin contains only a general description of the products shown. While uses and performance capabilities are described, under no circumstances shall the products be used by untrained or unqualified individuals and not until the product instructions including any warnings or cautions provided have been thoroughly read and understood. Only they contain the complete and detailed information concerning proper use and care of these products.



MSA Corporate Center

1000 Cranberry Woods Drive
Cranberry Township, PA 16066 USA
Phone 724-776-8600

www.MSAsafety.com

U.S. Customer Service Center

Phone 1-800-MSA-2222
Fax 1-800-967-0398

MSA Canada

Phone 1-800-672-2222
Fax 1-800-967-0398

MSA Mexico

Phone 011 52 442 227.3949
Fax 011 52 442 227 3943

MSA International

Phone 724-776-8626
Toll Free 1-800-672-7777
FAX 724-741-1559

MSA
The Safety Company

ID 1002-01-MC / Dec 2013

© MSA 2013. Printed in U.S.A.

www.MSAsafety.com