

Congratulations on the purchase of your new *Efficient* chair!

PARTS

PART	DESCRIPTION	QTY
1	Back Cushion	1
2	Seat Cushion	1
3	60mm Screws	8
4	Spring Washers	8
5	Flat Washers	8
6	Right Arm	1
7	Left Arm	1
8	Hexagonal Wrench	1

INSTRUCTIONS

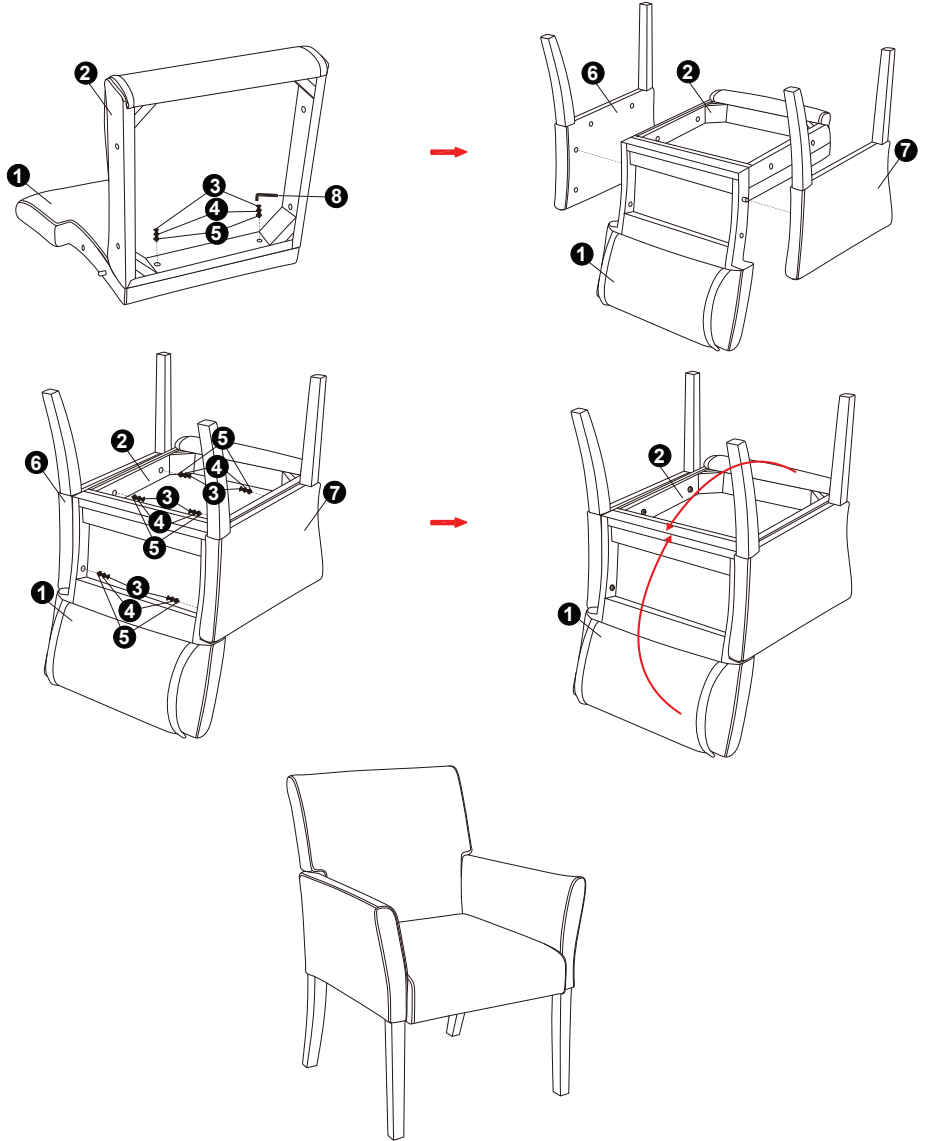

ATTENTION:
Make certain to fully tighten all screws before using chair.

WE SUGGEST TAPING THE WRENCH UNDER THE SEAT FOR FUTURE USE.

INSTRUCTIONS

- Remove all parts from the carton and separate them into part number groups as indicated in the parts list.
- Put the back cushion (1) flat on the floor. Align the seat cushion (2) over the back cushion (1) as shown and connect with flat washers (5), spring washers (4) and 60mm screws (3). Do not tighten screws fully until you have completed assembly. Peel back velcro flaps covering the back and seat bottom to access frame and screw holes.
- Insert the wood dowel of the back cushion (1) to the right arm (6) hole. Then connect the back cushion (1) and the right arm (6) with flat washers (5), spring washers (4) and 60mm screws (3). Then assemble the left arm (7). Do not tighten screws fully until you have completed assembly. Place chair upright on level floor. Make any necessary adjustments to frame to ensure chair sits flat on floor without rocking, then tighten all screws securely. Attach the flap to the velcro on the bottom. Save the wrench and tape underneath the seat for future use.
- Periodically (every 90 days) make sure that the screws are still fully tightened.