

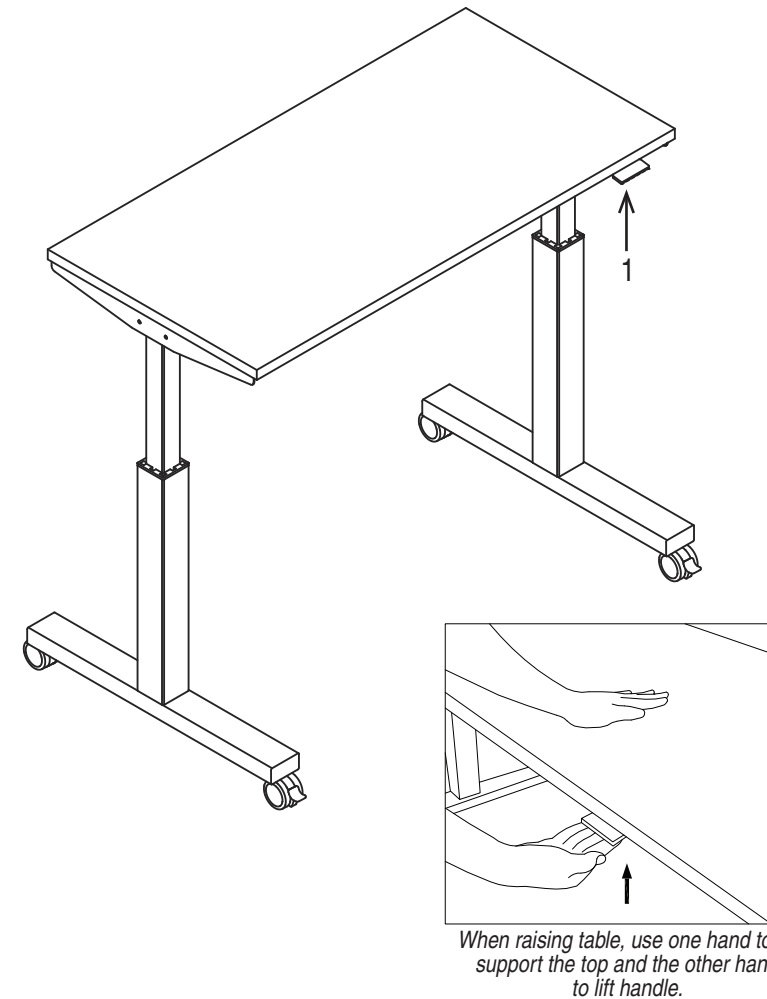

HAT60241 / HAT60251 / HAT60261 PNEUMATIC HEIGHT ADJUSTABLE TABLE OPERATING INSTRUCTIONS

HAT60241 = 4' wide
HAT60251 = 5' wide
HAT60261 = 6' wide



FEATURES

PNEUMATIC HEIGHT ADJUSTMENT

- Lock all casters.
- When raising/lowering table, use one hand to support the center of top and the other hand to lift handle.
- To raise table height, lift handle (1), table will move up gradually, release handle (1) when desired height is reached. To lower table, with one hand push the center of table top downward and lift handle (1) with other hand, release handle (1) when desired height is reached.

LOCKING CASTERS

- Casters equipped with locks.

WARNING

- Use this product only one person at a time.
- Use this product for its intended purpose.
- Do not put any item on top when raising/lowering the top.
- When top is in a resting position, the maximum weight of all items on top is 200 lbs.
- Do not stand on product.
- Do not use this product as a step stool or ladder.
- Do not use product unless all metal fasteners are tight. At least every six months, check all fasteners and joints to ensure they are tight.
- Do not modify product in any way.
- If any parts are missing, broken, damaged or worn, stop use of the product until repairs are made using factory authorized parts.
- Dispose of packing material properly. Do not use any packing materials as head covering. It may cause suffocation.
- Failure to follow these warnings could result in serious injury.

NOTE: Be sure to lift handle *completely* when raising / lowering table. Failing to do so may cause noise in height adjustment mechanism.

LIMITED WARRANTY

NBF © Signature Series chairs are warranted from the date of purchase against failure due to material and workmanship as follows:

- Lifetime on all non-moving metal parts.
- Lifetime on component parts including Control mechanisms, pneumatic cylinders, wood, plastic parts, base and casters.
- 3 Years on upholstery fabric and foam against wear and deterioration.
- We cannot warrant leather against routine scratching and scuffing, as all leather is subject to minor blemishes in use.

To make a warranty claim, contact Parts Department. Provide model number, proof of purchase, description of the problem and obtain return authorization. At it's option NBF will:

- (a) Supply compatible components of current manufacture.
- (b) Repair the customer's component. The customer must prepay freight on any components returned to the factory. Return freight on components still in warranty will be paid by NBF.

**All warranties are limited to the original purchaser for normal commercial usage defined as a standard forty hour work week by persons weighing 250 lbs. or less. This warranty will not cover labor, freight or damage from misuse, abuse, negligence, alteration, accident, vandalism, rusting, acts of nature or any other event beyond the control of NBF. The warranty does not cover cosmetic damage that may result from normal use. Liability for incidental or consequential damages is excluded. The user assumes all risk of injury resulting from use of this product. When usage is more than 40 hours per week, a two year warranty on all parts applies. Fabric and foam is warranted for one year. This warranty gives you specific legal rights, and you may also have other rights which vary from state to state.*

Our quality standards are among the highest in the industry. Sometimes, no matter how hard we try, there are times when parts are damaged or missing. Our Parts Department will do everything possible to promptly remedy the problem. Contact our factory by Fax 1-909-930-5629, or toll free parts number 1-800-950-7262, Monday through Friday 8:00 a.m. - 5:00 p.m. Pacific Time.

HAT60241 / HAT60251 / HAT60261

PNEUMATIC HEIGHT ADJUSTABLE TABLE

ASSEMBLY INSTRUCTIONS

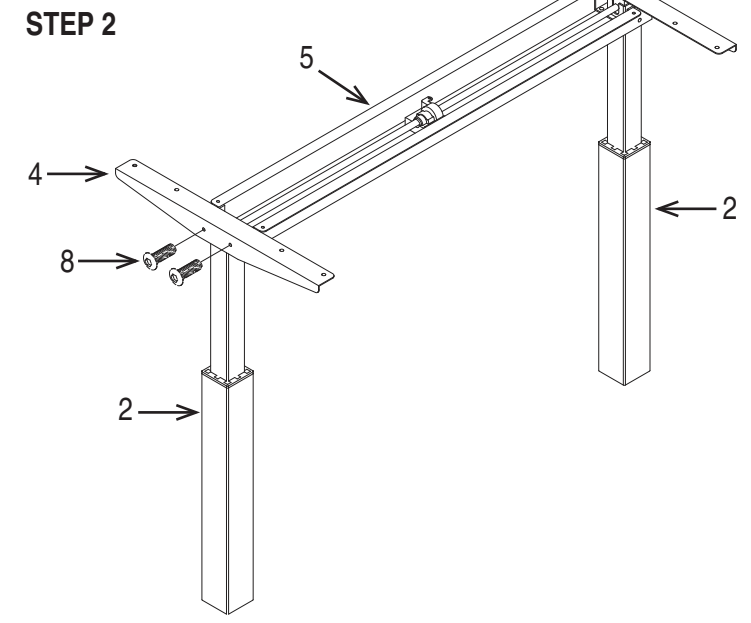
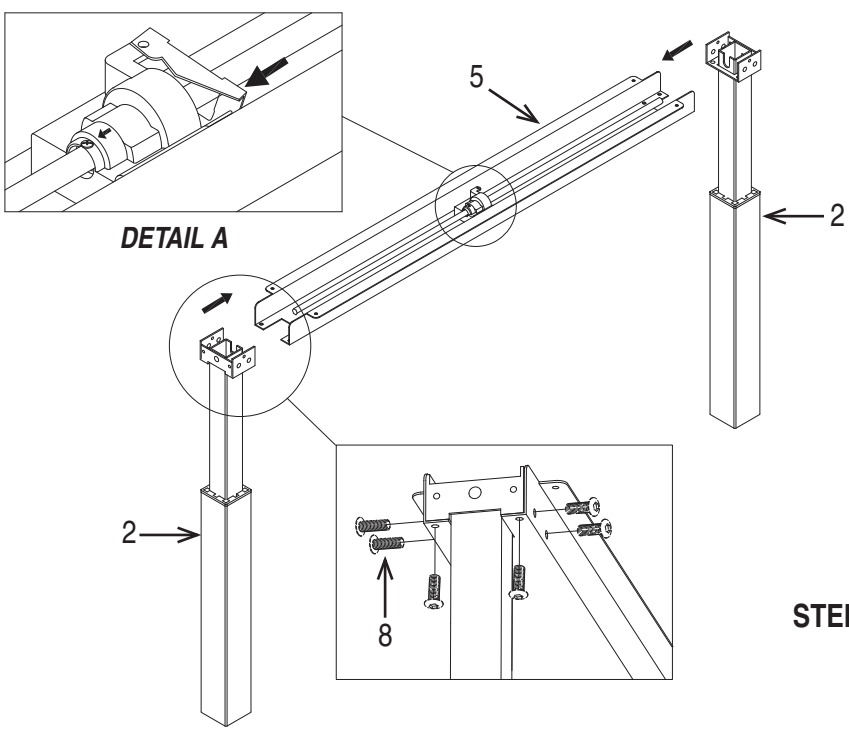
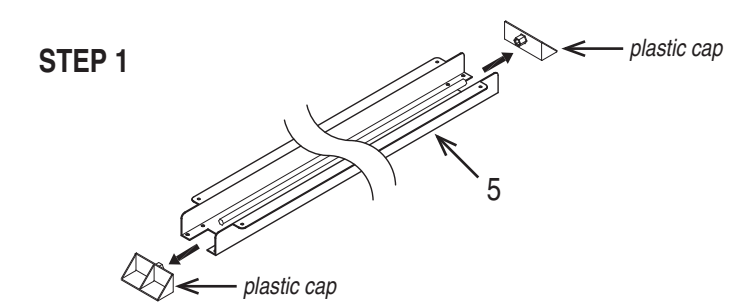

PART	QTY
1. Table Top	1
2. Leg Post	2
3. Foot	2
4. Top Support	2
5. Channel	1
6. Caster	1
7. Short Screw	18
8. Medium Bolt	16
9. Long Bolt	8
10. Height Adjustment Lever	1
11. Allen Wrench (not shown)	1
12. Key Wrench (not shown)	1

Phillips screwdriver also needed for assembly (not provided)

HAT60241 / HAT60251 / HAT60261

PNEUMATIC HEIGHT ADJUSTABLE TABLE

ASSEMBLY INSTRUCTIONS

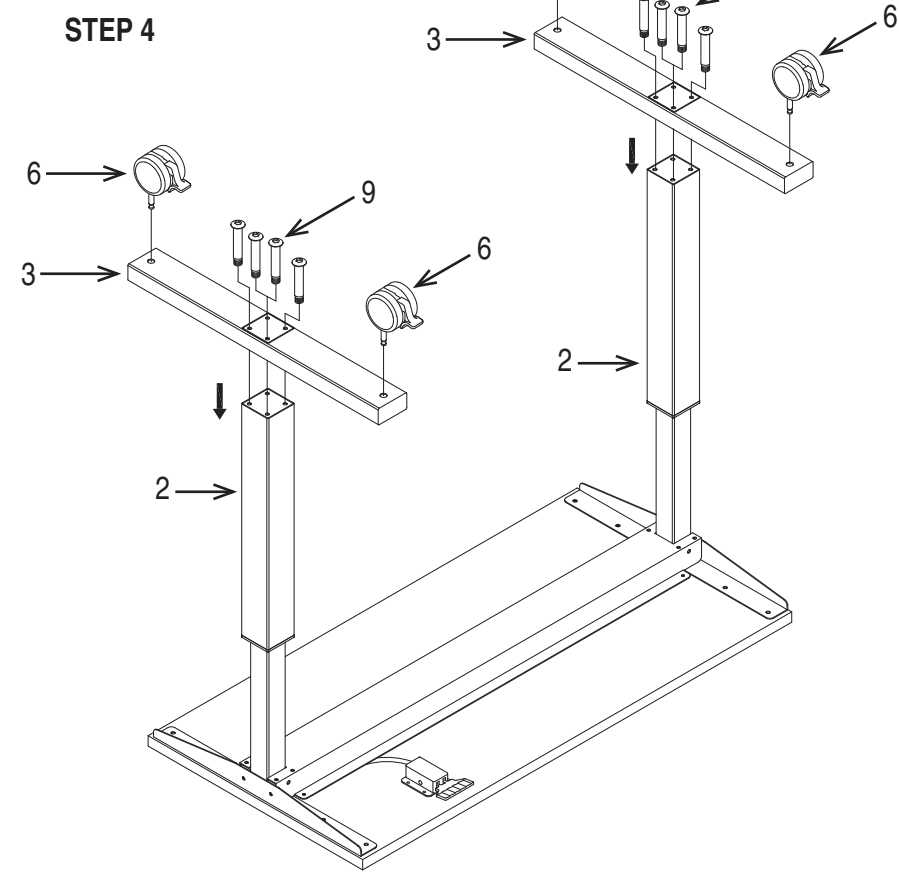
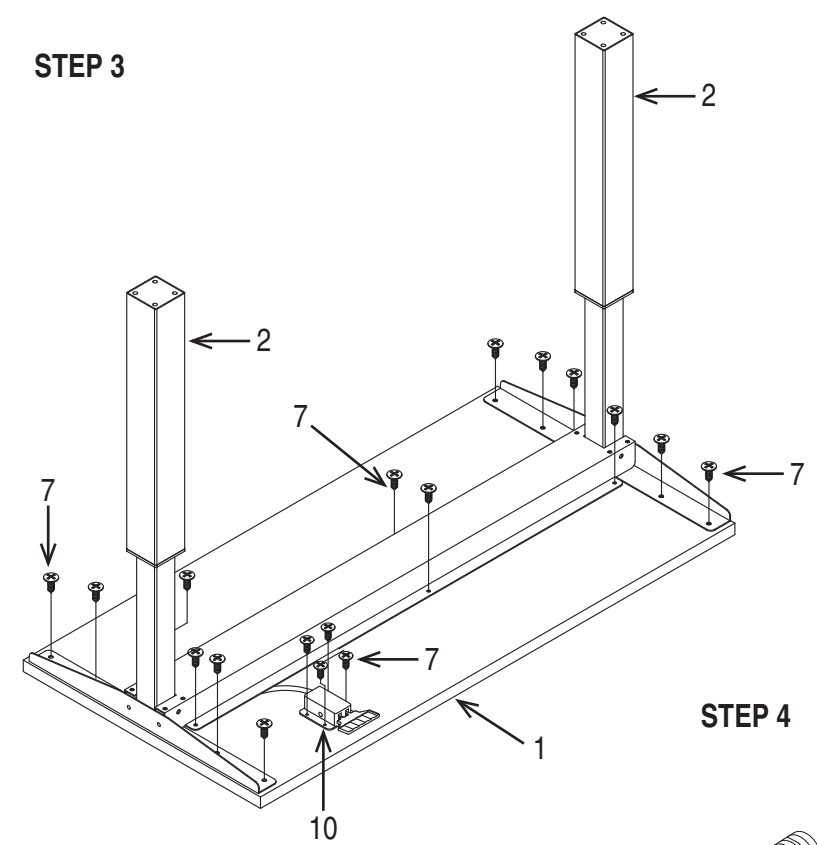

Remove all the parts from carton, separate them into part numbers indicated on the list and make sure part quantities are correct.
STEP 1 Remove plastic caps from ends of Channel (5). Attach Channel (5) between Leg Posts (2). To align rod with Leg Posts (2), squeeze lever to turn rod into position. **SEE DETAIL A.** Secure Leg Posts (2) to Channel (5) using six Medium Bolts (8) for each Leg Post (2). **DO NOT FULLY TIGHTEN BOLTS.**
STEP 2 Attach Top Supports (4) to Leg Posts (2) using two Medium Bolts (8) for each Leg Post (2). **FULLY ALL BOLTS USING ALLEN WRENCH (11).**

STEP 3 Attach Leg Post (2) assembly to Table Top (1) using fourteen Short Screws (7). **FULLY TIGHTEN SHORT SCREWS (7).** Attach Height Adjustment Lever (10) to Table Top (1) using four Medium Screws (7). **FULLY TIGHTEN SHORT SCREWS (7).**
STEP 4 Attach Feet (3) to Leg Posts (2) using four Long Bolts (9) for each Foot (3). **FULLY TIGHTEN LONG BOLTS (9).** Screw in two Casters (6) into each Foot (3). **FULLY TIGHTEN CASTERS (6) USING KEY WRENCH (12).**
ATTENTION: MAKE SURE ALL BOLTS, SCREWS & CASTERS ARE FULLY TIGHTENED BEFORE USING TABLE.