

ASSEMBLY INSTRUCTIONS  
**FOUR SHELF BOOKCASE**

**BRITE**  
CLEAN • BOLD • BRILLIANT

**COMPONENTS**

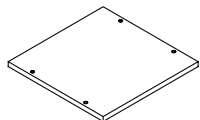

**A** Top (1)

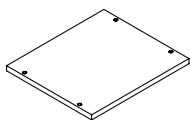

**B** Adjustable shelf (3)

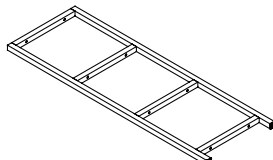

**C** Frame (2)

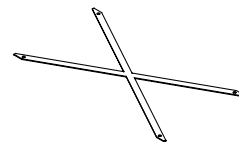

**D** Frame (1)

**HARDWARE/TOOLS**

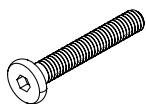

**E** Screw M6\*35 (16)



**F** Screw M6\*12 (4)

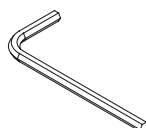

**G** Allen Key (1)

