

First Alert[®]

MANUAL # M08-0504-006

www.FirstAlert.com

Owner's Guide

First Alert[®]

5200DF



**PORTABLE PISTOL SAFE
WITH DIGITAL LOCK AND OVERRIDE KEY**



MANUAL # M08-0504-006

INDEX

Overview of Your Safe	1
Opening Your Safe for the First Time	2
Programming a Personal Passcode	3
Safe Care and Maintenance	4
Customer Service	5
Safe Identification Record	5
Ordering Replacement Keys	6
Limited Warranty	6

FOR YOUR PROTECTION

- ✓ Do not remove the serial number tag from the safe.
- ✓ Store emergency override keys away from safe, NEVER INSIDE.
- ✓ Record all safe identification numbers on Safe Identification Record on page 5.
- ✓ Save this manual and NEVER keep it inside the safe.

OVERVIEW OF YOUR SAFE

Congratulations!

Your new First Alert® Safe will provide years of safe and secure protection for your valuables, important documents and other personal items. All First Alert® Safes are designed and built using the highest manufacturing standards to ensure maximum user satisfaction under a variety of conditions. With proper care, your First Alert® Safe will provide peace of mind for many years to come.

PACKAGE CONTENTS



1 First Alert® Safe



1 Operation & Installation Guide

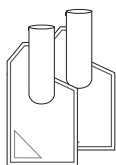

2 Emergency Override Keys



1 Steel Cable

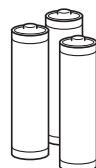

3 AA Batteries

OPENING YOUR SAFE FOR THE FIRST TIME

BATTERIES AND EMERGENCY OVERRIDE KEYS

Remove three (3) AA batteries and two (2) Emergency Override Keys. They are located in the protective foam insert at the top of the box.

- 1 Locate the key lock on the front of the safe. Remove the protective cover.
- 2 Insert the key into the lock on the front of the safe.
- 3 Turn the key counterclockwise to unlock and lift the lid.



NOTE: TURN THE KEY CLOCKWISE TO REMOVE THE KEY FROM THE LOCK.

- 4 Slide the battery compartment open.
- 5 Install three (3) AA batteries. Make sure the batteries are installed in the proper direction as indicated in the battery compartment.
- 6 Once the power connects, the light will blink red and green three (3) times.
- 7 Slide the cover back into place.

NOTE: WHEN THE BATTERY IS LOW, THE LIGHT WILL BLINK YELLOW WITH THE PRESS OF A BUTTON. REPLACE WITH NEW AA BATTERIES IMMEDIATELY.

TESTING THE PASSCODE

- 1 Enter the factory pre-set code as follows: 1-2-3-4-1-2. The red light will blink with each press of a button.
- 2 After properly entering the entire sequence, the green light will turn on for 2 seconds and the lock will click.
- 3 Lift the lid to open the safe.

PROGRAMMING A PERSONAL PASSCODE

- 1 Press the red reset button located on the inside of the safe (you may need a small apparatus). The red light will blink continuously.
- 2 Enter your new 6 digit passcode and press the red reset button. The green light will blink continuously.
- 3 Reenter your new passcode and press the red reset button.
- 4 If both entries match, the green light will turn on for 2 seconds and a new passcode is set for operation.
- 5 If both entries do not match, the red light will turn on for 2 seconds and revert back to the previous passcode for operation.
- 6 Record your new passcode in the Safe Identification Record on page 5.

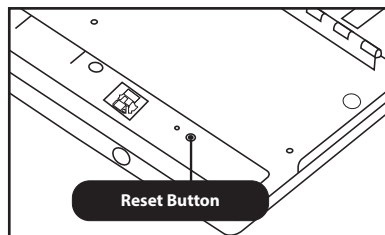

IMPORTANT

ONCE YOUR PERSONAL PASSCODE IS PROGRAMMED, THE FACTORY PRE-SET CODE WILL NO LONGER OPEN THE SAFE.

SECURITY LOCKOUT PERIODS

- ✓ If an invalid passcode has been entered, the red light will blink continuously.
- ✓ For added security, the safe will automatically lock out for 4 minutes after three attempts to open the safe with an invalid passcode.
- ✓ If you forget your personal passcode, access to the safe can be made using the emergency override key.



SECURING THE CABLE TO YOUR SAFE

- 1 Wrap the cable around a fixed object.
- 2 Loop one end of the cable through the other and tighten around the fixed object.
- 3 Place the loose end of the cable in the notch located on the side of the case.
- 4 Close the lid and lock the case.



SAFE CARE AND MAINTENANCE

When properly maintained, your safe will continue to operate accurately for many years. In order to ensure optimum performance of your safe, please follow these simple precautions:

BATTERY MAINTENANCE

- 1 Always purchase and use the batteries as specified by this User's manual.
- 2 Always replace all batteries at the same time. It is recommended to replace all batteries at least once a year or sooner depending on amount of use.
- 3 Always clean the battery contacts in the battery compartment and on the batteries before installing new batteries.
- 4 Always make sure all batteries match the polarity (+ and -) signs in the open battery compartment.
- 5 If your safe will not be used for an extended period of time, it is recommended that you remove the batteries.
- 6 Always promptly remove and properly discard of all used batteries.

CLEAN HANDS

Never attempt to operate the digital keypad if your hands have excessive dirt, debris or liquids on them.

CLEAN SAFE

To clean the surface of your safe, it is recommended that you use a mild cleaner (e.g., window cleaner) to avoid scratching or discoloring the surface. Always wipe dry and NEVER use abrasive cleansers on the safe or digital keypad.

For future reference, store this manual in a secure area away from the safe.
DO NOT DISCARD!

*NOTE: STORE KEYS IN A SECURE PLACE AWAY FROM CHILDREN.
NEVER PLACE THE KEYS INSIDE THE SAFE.*

CUSTOMER SERVICE

YOUR SAFE'S UNIQUE IDENTIFICATION NUMBERS

When contacting Customer Service, you should be prepared to supply some important information that specifically identifies your safe. This information is extremely important to assuring prompt and accurate customer assistance. It is strongly recommended that you identify and record the following information in the Safe Identification Record form at the bottom of this page.

MODEL NUMBER

SERIAL NUMBER

KEY NUMBER

MODEL NUMBER

The First Alert® Safes product line consists of many different models, each identified by a specific Model Number. Every model is manufactured with unique capabilities and features that may require specific solutions to a variety of difficulties that occasionally occur.

KEY NUMBER

The Key Number is necessary to identify the specific configuration of the key and lock cylinder components of your safe. If a key becomes damaged or misplaced, the Key Number is required in order for you to receive a replacement key.

LOCATING KEY NUMBER

The Key Number is engraved on the keys and around the lock cylinder.



SAFE IDENTIFICATION RECORD



Model Number _____

Serial Number _____

Key Number _____

6 Digit Passcode _____

HOW TO OBTAIN WARRANTY SERVICE

If service is required, do not return the product to your retailer. In order to obtain warranty service, contact Customer Service at 1-800-323-9005. To assist us in serving you, please have the model number, serial number and date of purchase available when calling.



PLEASE CALL US AT 1-800-323-9005 TO ESTABLISH A WARRANTY RETURN SET-UP

Please return item(s) with Customer Reference number marked on the outside of the box to the address listed to the right:

First Alert, Inc.
ATTN: Warranty Safe Returns
1301 Joe Battle
El Paso, TX 79936

ORDERING REPLACEMENT KEYS

If you lose the safe keys or would like additional keys, you can purchase them from First Alert, Inc. Go to **www.firstalert.com**, scroll over to Products, Safes & Cash Boxes, and click on the Combination/Key Request Form to download the request form.

LIMITED WARRANTY

BRK Brands, Inc., ("BRK") warrants that for a period of five (5) years from the date of purchase, this product will be free from defects in material and workmanship. BRK, at its sole option, will repair or replace this product or any component of the product found to be defective during the warranty period. Replacement or repair will be made with a new or remanufactured product or component. If the product is no longer available, replacement may be made with a similar product of equal or greater value. This is your exclusive warranty. This warranty is only valid for the original retail purchaser from the date of initial retail purchase and is not transferable. You must keep the original sales receipt. Proof of purchase is required to obtain warranty performance. BRK dealers, service centers, or retail stores selling this product do not have the right to alter, modify or in any way change the terms and conditions of this warranty.

This warranty does not apply to the finish on the product. This warranty does not cover normal wear and tear of parts or damage resulting from any of the following: negligent use or misuse of the product, use contrary to the operating instructions, disassembly, repair or alteration by anyone other than BRK or an authorized service center, improper installation, or exposure to extremes of heat or humidity. Further, the warranty does not cover Acts of God, including natural disasters.

BRK shall not be liable for any incidental or consequential damages caused by the breach of any express or implied warranty. BRK is also not responsible for: costs associated with removing or installing the product; damage or loss of the contents of the product; nor for the unauthorized removal of the contents; or damages incurred during shipment. Except to the extent prohibited by applicable law, any implied warranty of merchantability or fitness for a particular purpose is limited in duration to the duration of the above Warranty Period. Some states, provinces or jurisdictions do not allow the exclusion or limitation of incidental or consequential damages or limitations on how long an implied warranty lasts, so the above limitations or exclusion may not apply to you. This warranty gives you specific legal rights, and you may also have other rights that vary from state to state, or province to province, or jurisdiction to jurisdiction.

If you have any questions that cannot be answered by reading this manual, please call Customer Service at 1-800-323-9005.

© 2020 BRK Brands, Inc. All rights reserved. Distributed by BRK Brands, Inc. • BRK Brands, Inc. is a subsidiary of Newell Brands Inc. (NASDAQ: NWL) • 3901 Liberty Street, Aurora, IL 60504-8122
 Customer Service Team: (800) 323-9005 • www.firstalert.com • www.brkelectronics.com